

## LMR2016

Rechargeable Lithium Manganese Dioxide Coin Cell 3.0 V

### Specifications

Renata Type LMR2016  
Part Number 100775 (IB)  
Batteries with tabs On request  
UL Recognition MH14002

Nominal Voltage 3.0 V  
Standard Capacity 30 mAh  
(load 5.6 kΩ, cut off 2.0 V at 23°C )

Internal Impedance Initial max. 30Ω (measured at 23°C, 1 kHz)  
After 12 month storage at 23°C max. 35Ω

Thickness 1.60 +0.2 / -0.2 mm  
Diameter 20.0 +0 / -0.2 mm  
Weight ~ 1.2 g

**Charging Characteristic** CC/CV – Constant Current / Constant Voltage  
Voltage (intermittent charging) 3.25 V CV  
Voltage (continuous charging) 3.10 V CV  
Current Normal 0.3mA  
Max. Charging Current 10mA  
Temperature at charging - 20 °C - 60 °C

**Discharge Characteristic**  
Cut off Voltage 2.0 V  
Max discharge current 8mA (continuous); 20mA (pulse)  
Temperature during discharge -20°C - 60°C  
Discharge capability ≥ 50% of nominal capacity at 8 mA discharge  
Cycle life at room temperature > 500 cycles (20 % depth of discharge)

Storage 10°C - 30°C, ≤ 60 % r.H. (in case of storage for more than one month)  
Self discharge rate <1% / year at 23°C

### Dimensions

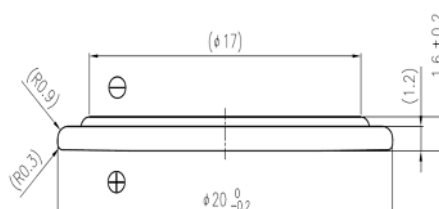

## LMR2016

Rechargeable Lithium Manganese Dioxide Coin Cell 3.0 V

### Typical Battery Performance

#### Charge Characteristic at 25 °C

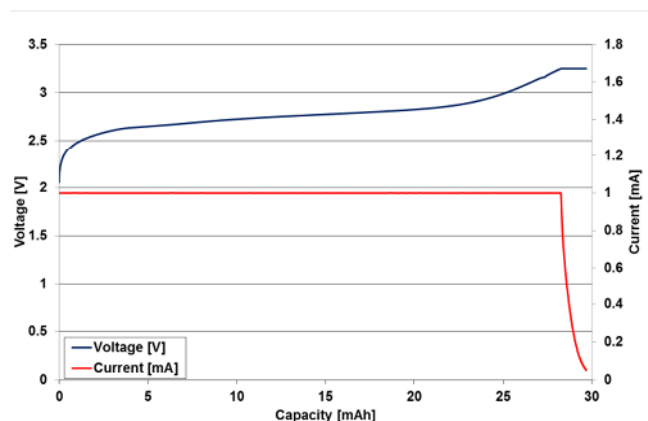

#### Cycle Life Characteristic

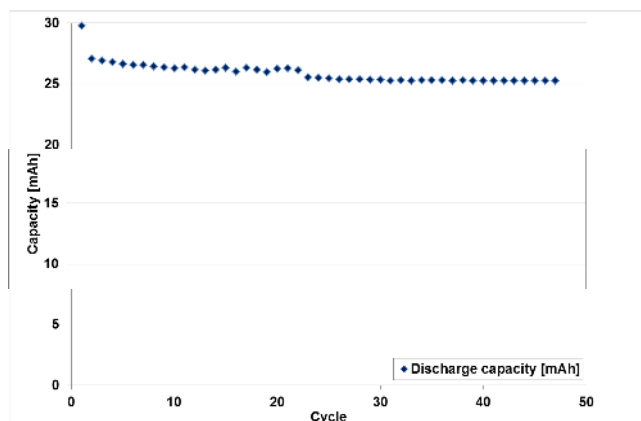

#### Discharge Characteristic at 25°C

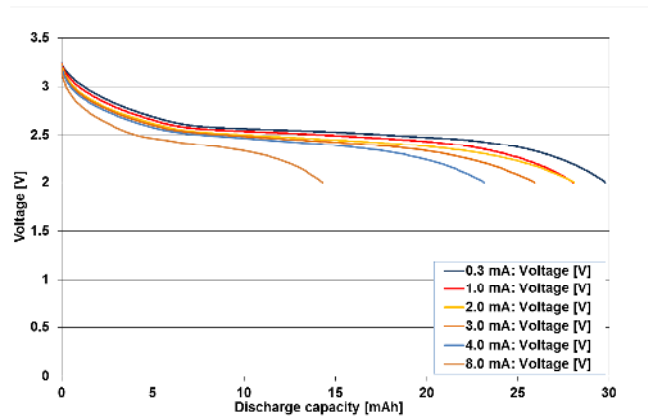

#### Temperature performance at 0.2 mA

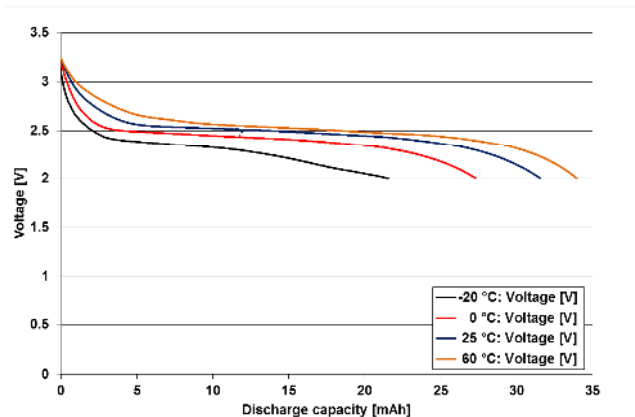

*Information and contents in this data sheet are for reference purpose only. They do not constitute any warranty or representation and are subject to change without notice. For most current information and further details, please contact your Renata representative.*