

NOTES: 1. MATERIALS AND FINISHES: BODIES, FLANGE & BUSHING - BRASS, NICKEL PLATING CONTACT - BeCu, SILVER PLATING INSULATORS - PTFE, NATURAL 2. MECHANICAL: A. DURABILITY: 500 CYCLES MIN. B. TEMPERATURE RANGE: -65° C TO +165° C 3. PACKAGING: A. QUANTITY: SINGLE PACK B. MARKING: BAG TO BE MARKED "AMPHENOL RF, 8975, AND DATE CODE"	THIRD ANGLE PROJ. 		REVISIONS			
	REV	DESCRIPTION		DATE	ECO	APPR
	--	RELEASE TO MFG.		--	--	--
	W	REDRAWN IN PRO-E & COD SHEET ADDED		6/18/15	50333	MR

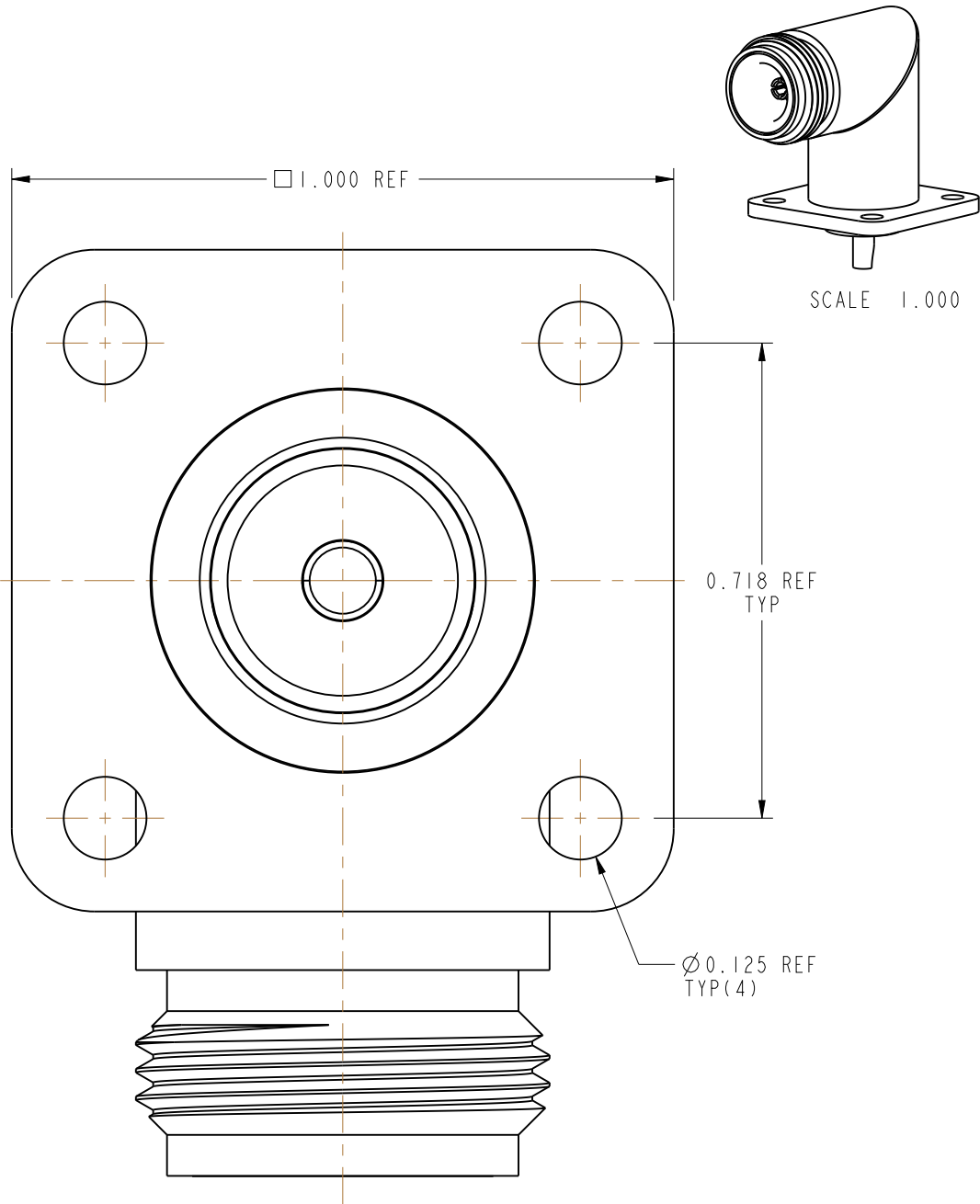
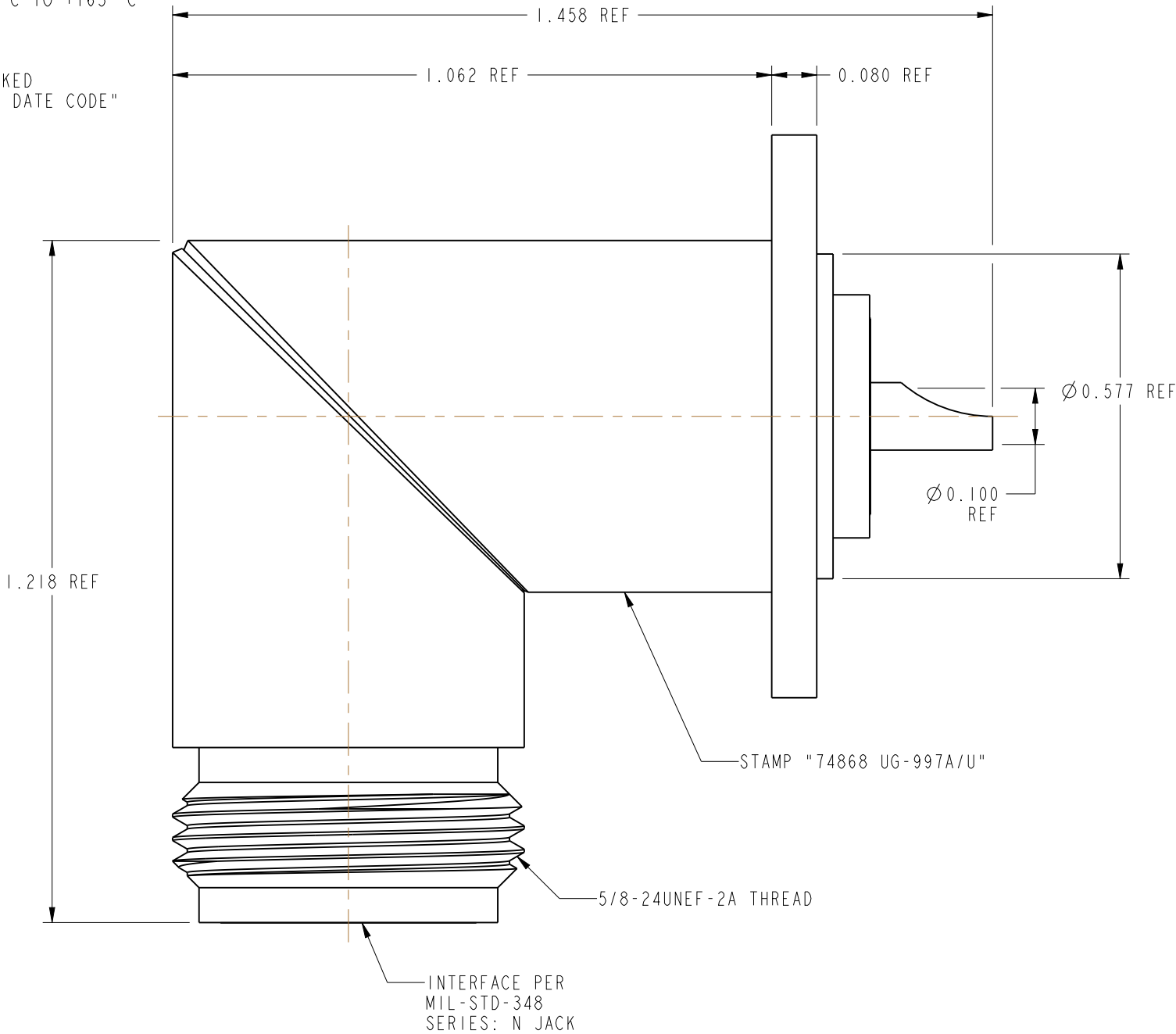

CUSTOMER OUTLINE DRAWING
ALL OTHER SHEETS ARE FOR INTERNAL USE ONLY

<div>UNLESS OTHERWISE SPECIFIED, DIMENSIONS ARE IN INCHES AND TOLERANCES ARE: 2 PLACE DECIMAL 3 PLACE DECIMAL ANGLES ±.015 (0,381 mm) ±.005 (0,127 mm) ± 1°</div> <div>NOTICE - These drawings, specifications, or other data (1) are, and remain the property of Amphenol corp. (2) must be returned upon request; and (3) are confidential and not to be disclosed to any person other than those to whom they are given by Amphenol Corp. the furnishing of these drawings, specifications, or other data by Amphenol Corp., or to any other person to anyone for any purpose is not to be regarded by implication or otherwise in any manner licensing, granting rights to permitting such holder or any other person to manufacture, use or sell any product, process or design, patented or otherwise, that may in any way be related to or disclosed by said drawings, specifications, or other data.</div>	MATERIAL	DRAWN	DATE	TITLE		Amphenol RF www.amphenolrf.com	
	SEE NOTES	MADHAN G	02-Jan-15				
	REFERENCE	ENGINEER	DATE	N RIGHT ANGLE JACK RECEPTACLE		DRAWING NO.8975	
	EAR #	D.ROYCE	19-Jan-91			ITEM NO.8975	
	CONFIGURATION LEVEL: In Work	APPROVED	DATE	SCALE: 3.8:1.0		PART NO.8975	
	FINISH	K. CAPOZZI	6/18/15	SHEET 2 OF 2			
		CAD FILE		DWG SIZE		REV	
				B		W	