

Model 72917
4mm Banana Plug to 2mm Sheathed Banana Jack Adapter

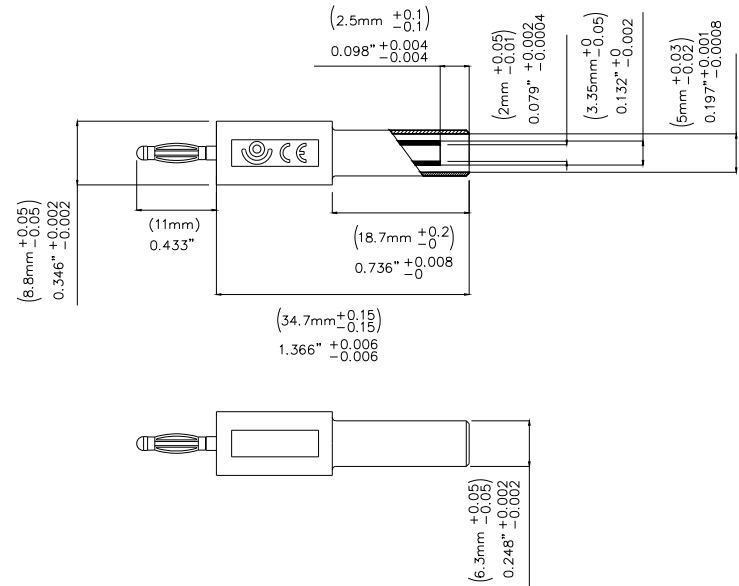

Easy Adaptation from 2mm to 4mm Test

Features

- Accepts 2mm safety-sheathed banana plugs
- Converts to standard 4mm banana plug
- Rating: 33 Vac / 70 Vdc, 10A

Materials

- Insulation: Polyamide
- Plug body: Nickel-plated Brass

Ordering Information

Model: 72916- Color Sold in packages of 10 pieces
Available colors: Black (-0) or Red (-2)

Specifications

Max Current	Max. 10A
Max Voltage	33 V AC / 70 V DC
Temperature	-20° C + 80° C
Max Resistance	Less than 0.8 mΩ

Rating: *hands free testing* in controlled environment:
70Vrms max. For CE compliance: Not intended for hand-held use at voltages above 33Vrms/70Vdc