

CONTACT ORIENTATION ON ROLL

NOTES: (UNLESS OTHERWISE SPECIFIED)

- MATERIAL:
 - CONTACT BODY: COPPER ALLOY.
 - OUTER SPRING: STAINLESS STEEL.
- SPECIFICATIONS:
 - CURRENT RATING: 5A MAX.
 - TERMINATION TYPE: CRIMPING.
 - WIRE RANGE: 26~24AWG.
 - WIRE INSULATION DIA(MAX): $\varnothing 2.2\text{mm}$.
- ROHS COMPLIANT.
- ALL DIMENSIONS ARE FOR REFERENCE USE ONLY.
- AVAILABLE TOOLS:
 - HAND CRIMPER: MFX-3958. A3
 - CRIMP APPLICATOR: MFX-3957.
 - EXTRACTION TOOL: QXRT20.

P/N	CONTACT PLATING(MATING AREA)
SP24W2T	TIN PLATING OVER NICKEL.
SP24W2N	NICKEL PLATING OVER COPPERIZE.
SP24W2F	GOLD FLASH PLATING OVER NICKEL.
SP24W2G5	5 μ " GOLD PLATING OVER NICKEL.
SP24W2G10	10 μ " GOLD PLATING OVER NICKEL.
SP24W2G15	15 μ " GOLD PLATING OVER NICKEL.
SP24W2G30	30 μ " GOLD PLATING OVER NICKEL.

A2

REVISIONS					
REV	ECO	DESCRIPTION	DATE	BY	APPR
A1	-	RELEASED DRAWING	Nov-8-17	Rookie	Tommy
A2	-	ADD THE G5 PART NUMBER	Jan-28-19	Blink	Tommy
A3	-	CHANGE HAND CRIMPER	Nov-8-19	Flan	Tommy

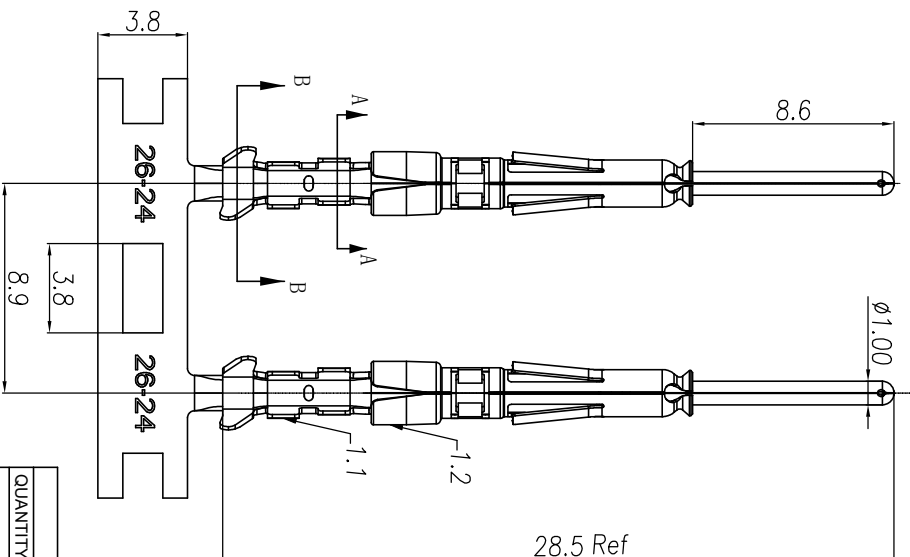

SECTION A-A

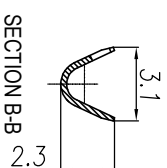
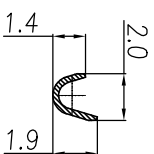

SECTION B-B

QUANTITY	PART NUMBER	DESCRIPTION	ITEM
		MATERIALS LIST	

UNLESS OTHERWISE SPECIFIED			
1) All dimensions are in millimeters.	DRAWN:	RAI	DATE: Nov-8-19
2) Tolerances are as follows:	CHECKED:	MWH	DATE: Nov-8-19
1 Pt. DEC 20-08	ENGINEER:		
3 Pt. DEC 20-08	APPROVE:	Tommy	DATE: Nov-8-19
3) Note reference =	CUSTOMER:		

PROCESS SPECIFICATIONS		MATERIAL SPECIFICATIONS		SCALE	
NEXT ASSY:		ECO-MATE PIN CONTACT.		SCALE: NONE	
THE DRAWING IS SUBJECT TO THE SPECIFICATIONS AND PERFORMANCE DATA OF THE MANUFACTURING PROCESS. THE MANUFACTURING PROCESS IS THE PROPERTY OF AMPHENOL. ALL DIMENSIONS ARE IN MILLIMETERS UNLESS OTHERWISE SPECIFIED.		STAMPED: 24-28AWG, SIZE 20		DRAWING NO: SP24W2XX	
AMPHENOL		Sine Systems - www.amphenol-sine.com		REVISION: A3	
44724 Montey Drive		Clinton Township, MI 48038		SHEET 1 OF 1	

Amphenol

ECO-MATE PIN CONTACT.

SIZE	TYPE	DWG NO	REVISION
B	C-	SP24W2XX	A3