

NOTES:

1. MATERIALS AND FINISHES:
 HD-BNC STR PLUG - BRASS, NICKEL PLATING
 CABLE - BELDEN 4794R, BLACK
2. ELECTRICAL:
 A. IMPEDANCE: 75 OHM
3. PACKAGING:
 A. QUANTITY: SINGLE PACK
 B. MARKING: BAG TO BE MARKED
 "AMPHENOL RF, 95-850-214-XXX AND DATE CODE"

THIRD ANGLE PROJ.

REVISIONS

REV	DESCRIPTION	DATE	ECO	APPR
A	RELEASE TO MFG.	04-Oct-18	9289	VR

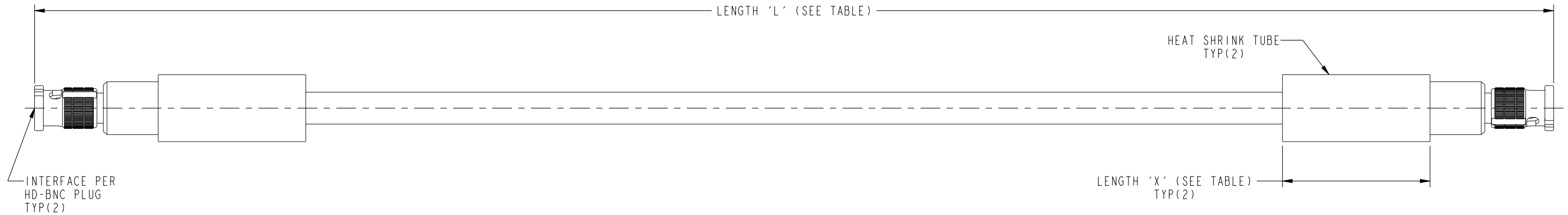
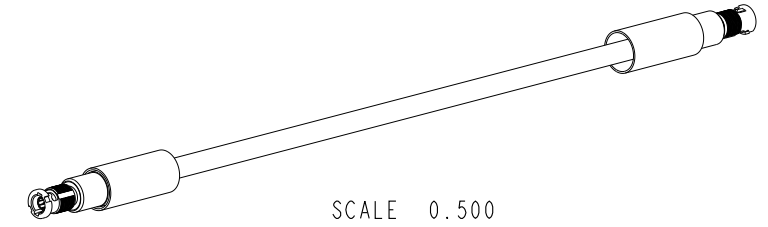

LENGTH TABLE			
PART NUMBER (IMPERIAL)	PART NUMBER (METRIC)	LENGTH IN INCHES [METERS] 'L'	LENGTH 'X' IN INCHES [METERS] MIN
95-850-214-006	-	6.00 [0.152]	0.75 [0.019]
-	95-850-214M025	9.84 [0.250]	
95-850-214-012	-	12.00 [0.305]	
95-850-214-018	-	18.00 [0.457]	1.50 [0.038]
-	95-850-214M050	19.69 [0.500]	
95-850-214-024	-	24.00 [0.610]	
-	95-850-214M075	29.53 [0.750]	
95-850-214-036	-	36.00 [0.914]	
-	95-850-214M100	39.37 [1.000]	
95-850-214-048	-	48.00 [1.219]	1.50 [0.038]
-	95-850-214M200	78.74 [2.000]	
-	95-850-214M400	157.48 [4.000]	

TOLERANCE TABLE	
LENGTH IN INCHES/FT [METERS]	TOLERANCE
0" - 23.90" [0 - 0.607]	±0.25" [0.006]
24.00" - 59.00" [0.610 - 1.499]	±0.50" [0.013]
5.0' - 24.9' [1.524 - 7.617]	±2.5%
25.0' & UP [7.620 & UP]	±5.0%

DESIGN REQUIREMENTS:

- | | |
|--|--|
| <input checked="" type="checkbox"/> FREQUENCY: DC - 12 GHz | <input checked="" type="checkbox"/> CONTINUITY |
| <input type="checkbox"/> VSWR: _____ : 1 MAX | <input checked="" type="checkbox"/> HI-POT: 300 VRMS |
| <input type="checkbox"/> INS. LOSS: _____ dB MAX | <input type="checkbox"/> OTHER |

CUSTOMER OUTLINE DRAWING
 ALL OTHER SHEETS ARE FOR INTERNAL USE ONLY

UNLESS OTHERWISE SPECIFIED, DIMENSIONS ARE IN INCHES AND TOLERANCES ARE: 2 PLACE DECIMAL 3 PLACE DECIMAL ANGLES ±.015 (0.381 mm) ±.005 (0.127 mm) ± 1°	MATERIAL	DRAWN	DATE	TITLE 75 OHM HD-BNC STR PLUG TO HD-BNC STR PLUG USING BELDEN 4794R CABLE VARIOUS LENGTH		Amphenol RF www.amphenolrf.com	
	SEE NOTES	VIJAY N M	24-Sep-18				
NOTICE - These drawings, specifications, or other data (1) are, and remain the property of Amphenol corp. (2) must be returned upon request; and (3) are confidential and not to be disclosed to any person other than those to whom they are given by Amphenol Corp. the furnishing of these drawings, specifications, or other data by Amphenol Corp., or to any other person to anyone for any purpose is not to be regarded by implication or otherwise in any manner licensing, granting rights to permitting such holder or any other person to manufacture, use or sell any product, process or design, patented or otherwise, that may in any way be related to or disclosed by said drawings, specifications, or other data.	REFERENCE	ENGINEER	DATE	SCALE: 1.5:1.0 SHEET 2 OF 2		DRAWING NO. 95-850-214-XXX ITEM NO. 95-850-214-XXX	
	EAR # 8593	VIJAY N M	24-Sep-18				
	CONFIGURATION LEVEL: In Work	APPROVED	DATE		DWG SIZE B		REV A
FINISH	K.CAPOZZI	04-Oct-18		PART NO. 95-850-214-XXX			