

| DRAWING REVISIONS | | | |
|-------------------|------------|-----|---------|
| REV | DOCUMENT | APP | DATE |
| A | DO 06-1033 | AKG | 6-15-06 |

| SIZE | A | B | C | D | E | F | G | H | J | K | PART NO. |
|------|-------|-------|-------|------|------|-------|------|------|------|------|---------------|
| 9 | 1.209 | .984 | .642 | .500 | .313 | .592 | .749 | .314 | .360 | .187 | 702 12 09 010 |
| 15 | 1.536 | 1.312 | .970 | .500 | .313 | .918 | .749 | .314 | .360 | .187 | 702 12 15 010 |
| 25 | 2.079 | 1.852 | 1.510 | .500 | .313 | 1.462 | .749 | .314 | .360 | .187 | 702 12 25 010 |
| 37 | 2.724 | 2.500 | 2.158 | .500 | .313 | 2.114 | .749 | .314 | .360 | .187 | 702 12 37 010 |

- NOTES:
- UNLESS OTHERWISE SPECIFIED, ALL DIMENSIONS ARE REFERENCE ONLY.
 - SMALLEST UNIT PACKAGE MUST BE MARKED PER EM-25 FIGURE 1, PARAGRAPH 7 AND FIGURE 3.
 - INK MARK PER EM-9 THE "CINCH" LOGO PER EM-40, CINCH CATALOG NUMBER PER BOX AND "RoHS" AND DATE CODE PER EM-4-4, 1716 HIGH CHARACTERS. METHOD 19 OF EM-9 IS PREFERRED METHOD.
 - PARTS TO BE BULK PACKED 1000 PCS PER PACKAGE
 - RoHS NON COMPLIANT PART NO.'S.: 232 34 09 000, 232 34 15 000, 232 34 25 000 AND 232 34 37 000.

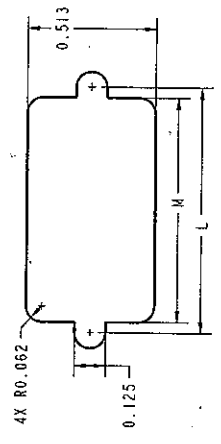
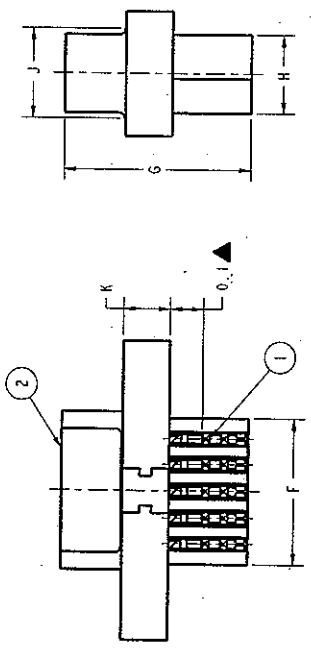
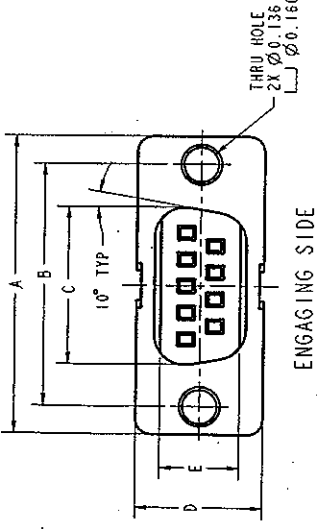

| SIZE | L | M | H |
|------|-------|-------|---|
| 9 | .894 | .900 | |
| 15 | 1.312 | 1.202 | |
| 25 | 1.852 | 1.743 | |
| 37 | 2.500 | 2.391 | |

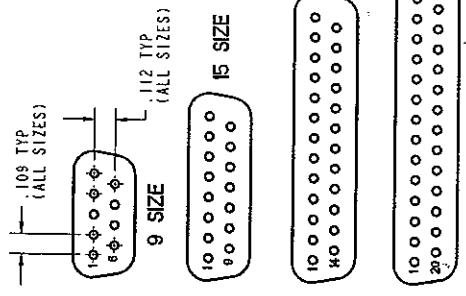

RoHS COMPLIANT

| | | |
|--|-------------------------|---------|
| ENGLISH INCHES | PRO/E | Cinch |
| DO NOT SCALE DRAWING | DATE | 1/27/06 |
| UNLESS OTHERWISE SPECIFIED, ALL DIMENSIONS ARE IN INCHES | DESIGN ENGINEER | JIMENEZ |
| FILED PATH | DESIGN ENGINEERING MGR. | A. BALI |
| FILE NAME | MFG. ENGINEERING | A. BALI |
| DATE | QUALITY ASSURANCE | M. CRUZ |
| TIME | DATE | 5/5/06 |
| PROJECT NUMBER | SCALE | 2:1 |
| 71785 B | | |

702 12 09 010

71785 B

2:1

SHEET 1 OF 2