

4

3

2

1

THIS DRAWING IS UNPUBLISHED. RELEASED FOR PUBLICATION 20  
 © COPYRIGHT 20 BY - ALL RIGHTS RESERVED.

REVISIONS					
P	LTR	DESCRIPTION	DATE	DWN	APVD
	A	INITIAL	09MAY2015	DW	CW
	B	ECR-15-013292	24SEP2015	DL	CW

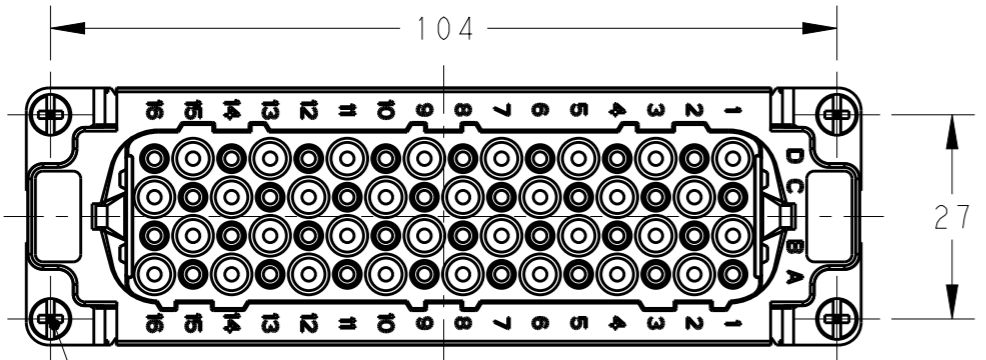

4X M3 SCREW, RECOMMENDED  
TIGHTENING TORQUE 0.5Nm

M4 SCREW  
RECOMMENDED  
TIGHTENING TORQUE  
1.2Nm

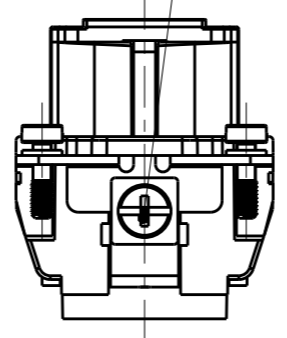
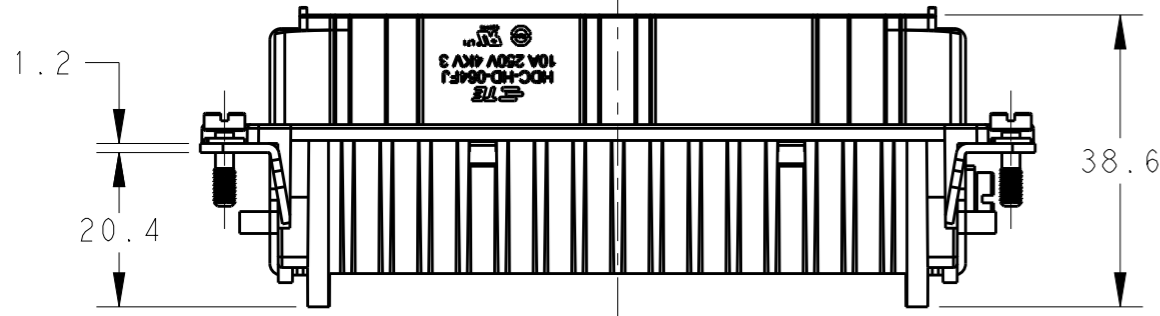

NOTES:  
 1. TECHNICAL CHARACTERISTICS:  
 INSULATION MATERIAL: PC  
 RATED VOLTAGE: 250 V  
 RATED CURRENT: 10 A  
 INSULATION RESISTANCE: >=400MΩ  
 RATED IMPULSE VOLTAGE: 4 KV  
 POLLUTION DEGREE: 3  
 FLAMMABILITY: UL94V-0  
 MATING CYCLES: 500 CYCLES  
 OPERATION TEMPERATURE: -40-+125°C  
 WIRE RANGE: 0.14-2.5 mm<sup>2</sup> (26-14 AWG)  
 CONTACT TYPE: STAMPING CONTACT  
 2. CONTACT NEED TO BE ORDERED SEPARATELY.

注释:  
 1. 技术参数:  
 绝缘材料: PC  
 额定电压: 250V  
 额定电流: 10A  
 绝缘电阻: >=400MΩ  
 额定脉冲电压: 4 KV  
 污染等级: 3  
 阻燃等级: UL94V-0  
 插拔次数: 500次  
 工作温度: -40-+125°C  
 接线范围: 0.14-2.5 mm<sup>2</sup> (26-14 AWG)  
 接线类型: 冲压端子 冷压接  
 2. 端子需要单独订购.

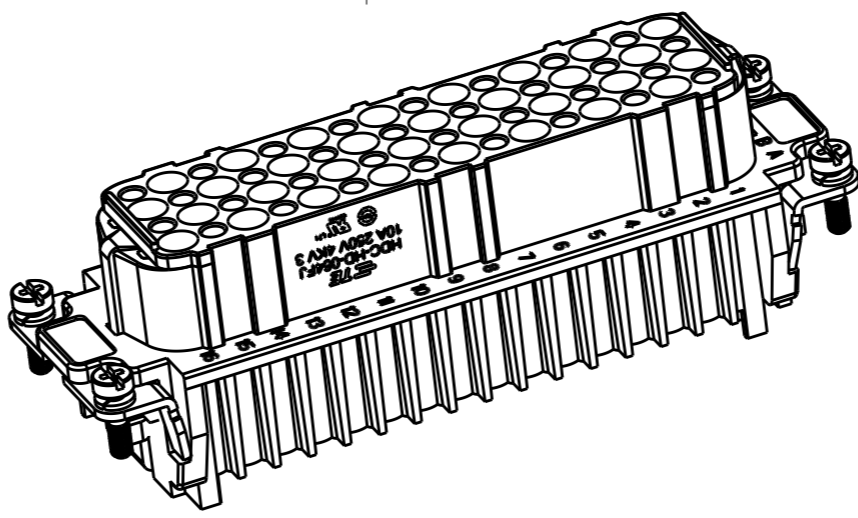
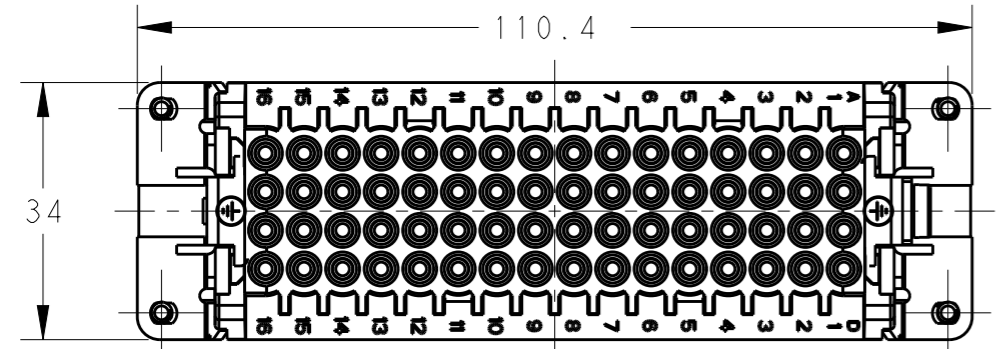

PANEL CUT FOR INSERTS USE  
WITHOUT HOODS/ HOUSINGS

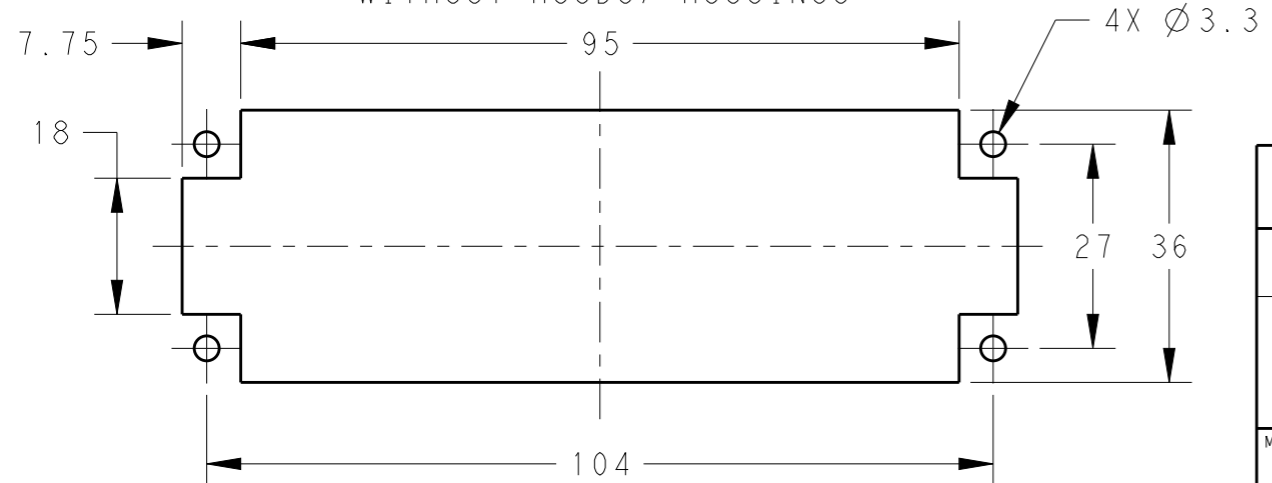

THIS DRAWING IS A CONTROLLED DOCUMENT.

DIMENSIONS:		TOLERANCES UNLESS OTHERWISE SPECIFIED:	
mm			
	0 PLC	±	-
	1 PLC	±	-
	2 PLC	±	-
	3 PLC	±	-
	4 PLC	±	-
	ANGLES	±	-
MATERIAL		FINISH	
-		-	
-		-	

DWN	09MAY2015
David Wang	
CHK	09MAY2015
Chris Wang	
APVD	09MAY2015
Xiang Xu	
PRODUCT SPEC	108-137135
APPLICATION SPEC	114-137135
WEIGHT	-
Customer Drawing	

HD-064-FJ		T2020642201-100	
DESCRIPTION		PART NUMBER	
TE Connectivity			
NAME: HD-064-FJ			
SIZE	CAGE CODE	DRAWING NO	RESTRICTED TO
A3	00779	©-T2020642201100	-
SCALE: 1:1		SHEET: 1 OF 1	REV: B