

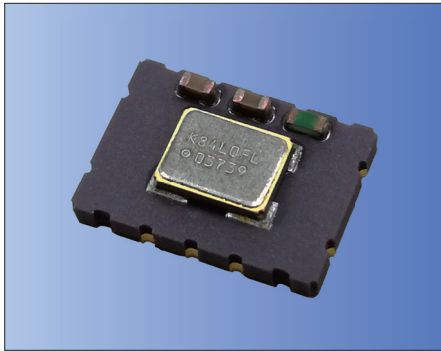

7.0×5.0mm



RoHS Compliant

Features

- High stability and high reliability
- 2.7 to 5.5V drive available
- Clipped sine wave or CMOS level output
- Low phase noise
- Disable Function (KT7050A)

Applications

- 5G, Smallcell, Stratum3
- SONET/ SDH/ Ethernet

How to Order

KT7050 □ 20000 K A W 33 T xx
① ② ③ ④ ⑤ ⑥ ⑦ ⑧ ⑨

| | | | |
|------------------------|---------------------------|-------------|--------|
| ①Series | ②Land Type | | |
| ③Output Frequency | A | 10Pads | |
| ④Freq. Temp. Chrst. | B | 4Pads | |
| ⑤Lower Operating Temp. | ⑥Upper Operating Temp. | | |
| KAW | ±0.28×10 ⁻⁶ | -40°C | +85°C |
| ⑦Supply Voltage | ⑧Voltage Control Function | | |
| 33 | 3.3V | T | TCXO |
| | | Spec. Code* | VCTCXO |

*Please contact us for Spec. Code.

⑨Individual Specification

Packaging (Tape & Reel 1000 pcs./ reel)

- Compliant to the GR1244-Core & GR253-Core
- Recommended in Microsemi's ZLAN-68 app. note for Stratum3 applications based on tests performed by Kyocera.

Specifications

| Item | Symbol | Conditions | Min. | Max. | Unit | |
|--|-------------------|---|---------------------|---------------------|--------------------|---------|
| Output Frequency Range | f _o | Standard Frequency: 10, 19.2, 20, 24.576, 26, 30.72, 38.88, 40 | 10 | 40 | MHz | |
| Frequency Tolerance | f _{tol} | vs Temperature (-40 to +85°C) [±(f _{max} -f _{min})/ 2f _o] | -0.28 | +0.28 | × 10 ⁻⁶ | |
| | | vs Voltage | -0.1 | +0.1 | | |
| Supply Voltage | V _{cc} | | +2.7 | +5.5 | V | |
| Current Consumption | I _{cc} | CMOS Output | — | 6 | mA | |
| Frequency Aging | f _{age} | 20years aging @40°C Including temp characteristics, initial tolerance, rated power supply voltage change and load change. | -4.6 | +4.6 | × 10 ⁻⁶ | |
| Voltage Control Range | f _{cont} | Positive *100k ohm min | ±5 | ±20 | × 10 ⁻⁶ | |
| Output Level | V _{pp} | Clipped Sine, Load: 10k ohm // 10pF | 0.8 | — | Vp-p | |
| Low Level Output Voltage | V _{oL} | CMOS, Load: 15pF I _{oL} =4mA | — | 10% V _{cc} | V | |
| High Level Output Voltage | V _{oH} | CMOS, Load: 15pF I _{oH} =-4mA | 90% V _{cc} | — | V | |
| Rise / Fall Time (10%V _{cc} to 90%V _{cc}) | Tr/ Tf | CMOS, Load: 15pF | — | 8 | ns | |
| Symmetry | SYM | 50% V _{cc} | 45 | 55 | % | |
| Phase Noise | — | @20MHz | @10Hz offset | — | -90 | dBc/ Hz |
| | | | @100Hz offset | — | -120 | |
| | | | @1kHz offset | — | -140 | |
| | | | @10kHz offset | — | -150 | |
| | | | @100kHz offset | — | -150 | |

* Please contact us for other specifications.

Crystal Oscillators

Dimensions

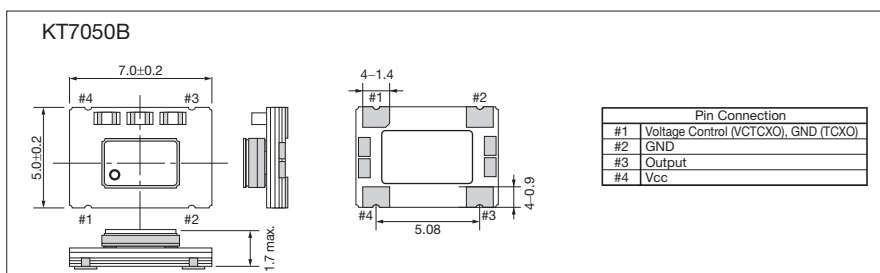
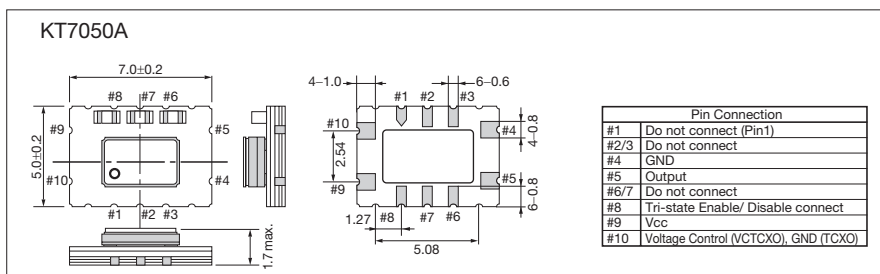

Recommended Land Pattern

(Unit: mm)

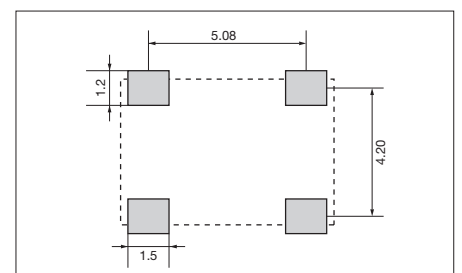
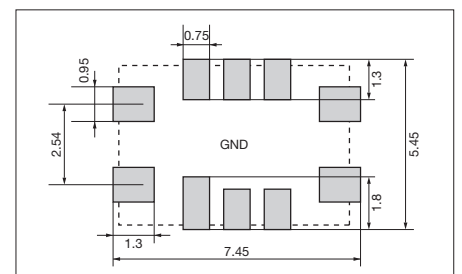

Mouser Electronics

Authorized Distributor

Click to View Pricing, Inventory, Delivery & Lifecycle Information:

[Kyocera:](#)

[KT2016K26000ZAW18T5S](#)