

PRODUCT NO.
10074141-001LF
10074141-003LF

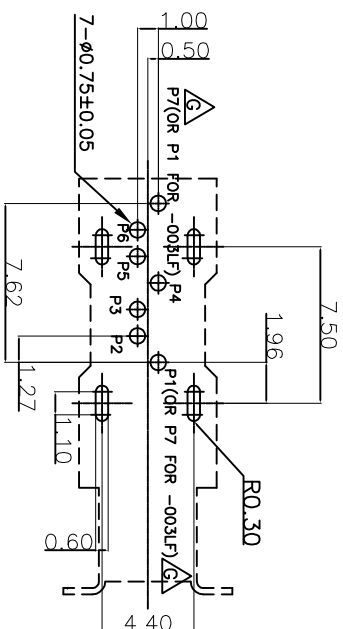
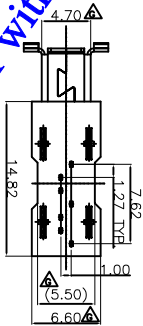
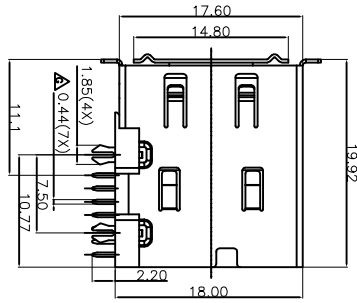
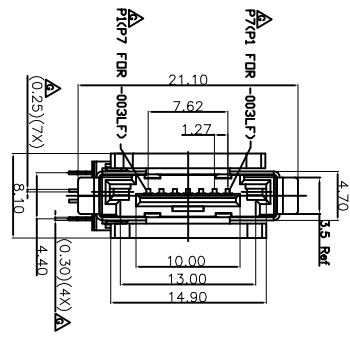

RECOMMEND P.C.B.O.A.R.D. LAYOUT
PCB TOLERANCE:±0.05

- NOTES:
1. MATERIAL: HOUSING:THERMAL/PLASTIC HIGH TEMP WITH 30% G/F U194 V-0
 2. FINISH: 50U" MIN. NICKEL UNDERPLATING OVER ALL SHELL/BOARD LOOK:50U" MIN. NICKEL PLATING OVER ALL IN A WAVE SOLDER APPLICATION WITH A 1.6MM PCB
 3. THE HOUSING WILL WITHSTAND TO 280C FOR 10 SEC
 4. PRODUCT SPEC : GS-12-386
 5. PACKING SPEC : GS-14-1109
 6. A SYMBOL Δ WILL BE NEXT TO ANY DIMENSION, VIEW OR NOTE WHICH HAS BEEN MODIFIED WITH THE CURRENT DRAWING REVISION
- PACKING: TRAY PACKING
BLANK: TRAY PACKING
1: 15U" GOLD PLATING
2: 0.7U" GOLD PLATING
3: 15U" GOLD PLATING WITH NEW PINOUT ASSIGNMENT
- 0: LAYOUT?!

PDFill PDF Editor with Free Writer and Tools

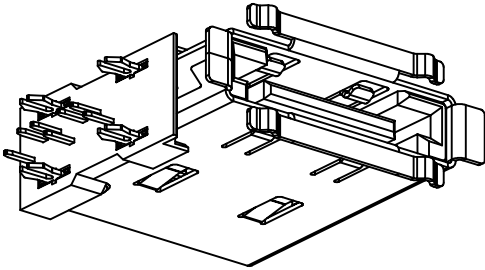

PIN DEFINITION

ESATA	NAME	TYPE
P1	GND	GND
P2	A+	A+
P3	A-	A-
P4	GND	GND
P5	B-	B-
P6	B+	B+
P7	GND	GND

mat'l. code	14	surface	ISO 1302	ISO 406	ISO 150	100	projection	product family	533
ltr	ecm no	dr	date	tolerances unless otherwise specified	angles	linear	scale 2:1	title	E-SATA_UP_RIGHT
A	107-1074S	LIN	2007-05-23		.XX±0.38			dwg no	10074141
B	108-1082S	LIN	2008-04-28		.XX±0.25			sheet 1 of 3	131
C	110-0184S	LIN	2010-12-14		.XXX±0.100			size	A3
D	1-00544QS	LIN	2007-05-21						
E	2011-10-17	ENG							
F	2012-06-08	CH							
G	2016-03-03	DR							
Sheet	Revision	G	G	G	G	G	G	G	G
Index	Sheet	1	2	3	106	108	110	112	114
					116	118	120	122	124
					126	128	130	132	134
					136	138			

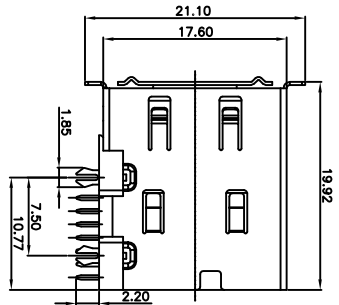
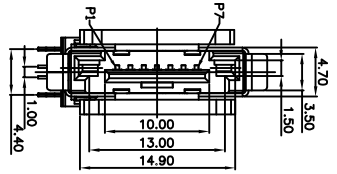
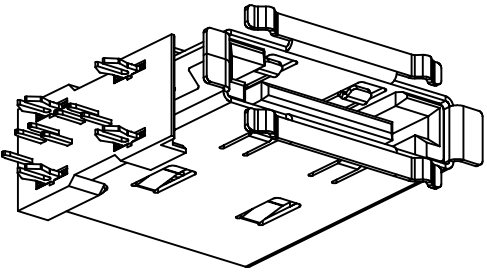

PDFfill PDF Editor With Free Writer and Tools

PIN DEFINITION

ESATA	NAME	TYPE
	P1	GND
	P2	A+
	P3	A-
	P4	GND
	P5	B-
	P6	B+
	P7	GND

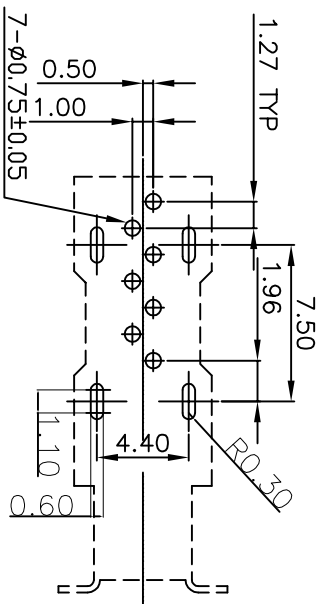

P.C. BOARD MOUNTING DIMENSIONS T=1.60mm
PCB TOLERANCE: ±0.05

- NOTES:
1. MATERIAL: HOUSING:THERMAL PLASTIC HIGH TEMP WITH 30% G/F U94 V-0
CONTACT: COPPER ALLOY
SHELL: COPPER ALLOY
SHELL/BOARD LOCK: COPPER ALLOY
COLOR: BLACK
 2. CONTACT: GOLD PLATING ON CONTACT AREA
100µ" MIN. MATT TIN PLATING ON SOLDERMILLS
50µ" MIN. NICKEL UNDERPLATING OVER ALL BOARD LOCK: 50µ" MIN. NICKEL PLATING OVER ALL SHELL/BOARD LOCK: 50µ" MIN. NICKEL PLATING OVER ALL
 3. IN A WAVE SOLDER APPLICATION WITH A 1.5MM P25
N/A WAVE SOLDER APPLICATION WITH A 1.5MM P25
 4. PRODUCT SPEC : GS-12-398
 5. PACKING SPEC : GS-14-1109
 6. PRODUCT NUMBERING:
10074141 - 0 0 0 LF - LEAD FREE
PACKING:
BLANK: TRAY PACKING
1: 1.5" GOLD PLATING
2: 0.7" GOLD PLATING
8. A SYMBOL Δ WILL BE NEXT TO ANY DIMENSION, VIEW OR NOTE, WHICH HAS BEEN MODIFIED WITH THE CURRENT DRAWING REVISION

mat'l. code	surface	sg	tolerance	projection	product family
14	ISO 1302	∇	ISO 406 ISO 100	MM	533

ltr	ecm no	dr	date	ISO 1302	tolerance	sg	tolerance	projection	product family
A	107-1074S	LNK	2007-05-23		angle	∇	.XX±0.25	MM	E-SATA_UP_RIGHT
B	108-1082S	LNK	2008-04-28		linear	∇	.XX±0.25	MM	DIP_TYPE
C	110-0184S	LNK	2010-12-14		$\sigma \pm Z$	∇	.XXX±0.100	SCALE 2:1	
D	T-00544QS	LNK	2011-08-31		STERLING	LNK	2007-05-21		
E	ex-s-0078H	HKL	2011-10-17		ENG	HKL	2016-03-03		
F	ex-s-0118H	HKL	2012-06-08		CH	HKL	2016-03-03		
G	ex-s-234H	HKL	2016-03-03		DPD	KPTAY	2016-03-03		
Sheet	Revision	G	G	G	G	G	G	G	G
Index	Sheet	1	2	3	106	108	110	112	114
					116	118	120	122	124
					126	128	130	132	134
					136	138			



Amphenol
FCI

type PRODUCT-CUSTOMER_DWG Drw/wing

dwg no 10074141 sheet 2 of 3 size A3

123 125 127 129 131 133 135 137 139

121 123 125 127 129 131 133 135 137 139

121 123 125 127 129 131 133 135 137 139

121 123 125 127 129 131 133 135 137 139

121 123 125 127 129 131 133 135 137 139

121 123 125 127 129 131 133 135 137 139

121 123 125 127 129 131 133 135 137 139

121 123 125 127 129 131 133 135 137 139

121 123 125 127 129 131 133 135 137 139

121 123 125 127 129 131 133 135 137 139

121 123 125 127 129 131 133 135 137 139

121 123 125 127 129 131 133 135 137 139

121 123 125 127 129 131 133 135 137 139

121 123 125 127 129 131 133 135 137 139

121 123 125 127 129 131 133 135 137 139

121 123 125 127 129 131 133 135 137 139

121 123 125 127 129 131 133 135 137 139

121 123 125 127 129 131 133 135 137 139

121 123 125 127 129 131 133 135 137 139

121 123 125 127 129 131 133 135 137 139

121 123 125 127 129 131 133 135 137 139

121 123 125 127 129 131 133 135 137 139

121 123 125 127 129 131 133 135 137 139

121 123 125 127 129 131 133 135 137 139

121 123 125 127 129 131 133 135 137 139

121 123 125 127 129 131 133 135 137 139

121 123 125 127 129 131 133 135 137 139

121 123 125 127 129 131 133 135 137 139

121 123 125 127 129 131 133 135 137 139

121 123 125 127 129 131 133 135 137 139

121 123 125 127 129 131 133 135 137 139

121 123 125 127 129 131 133 135 137 139

121 123 125 127 129 131 133 135 137 139

121 123 125 127 129 131 133 135 137 139

121 123 125 127 129 131 133 135 137 139

121 123 125 127 129 131 133 135 137 139

121 123 125 127 129 131 133 135 137 139

121 123 125 127 129 131 133 135 137 139

121 123 125 127 129 131 133 135 137 139

121 123 125 127 129 131 133 135 137 139

121 123 125 127 129 131 133 135 137 139

121 123 125 127 129 131 133 135 137 139

121 123 125 127 129 131 133 135 137 139

121 123 125 127 129 131 133 135 137 139

121 123 125 127 129 131 133 135 137 139

121 123 125 127 129 131 133 135 137 139

121 123 125 127 129 131 133 135 137 139

121 123 125 127 129 131 133 135 137 139

121 123 125 127 129 131 133 135 137 139

121 123 125 127 129 131 133 135 137 139

121 123 125 127 129 131 133 135 137 139

121 123 125 127 129 131 133 135 137 139

121 123 125 127 129 131 133 135 137 139

121 123 125 127 129 131 133 135 137 139

121 123 125 127 129 131 133 135 137 139

121 123 125 127 129 131 133 135 137 139

121 123 125 127 129 131 133 135 137 139

121 123 125 127 129 131 133 135 137 139

121 123 125 127 129 131 133 135 137 139

121 123 125 127 129 131 133 135 137 139

121 123 125 127 129 131 133 135 137 139

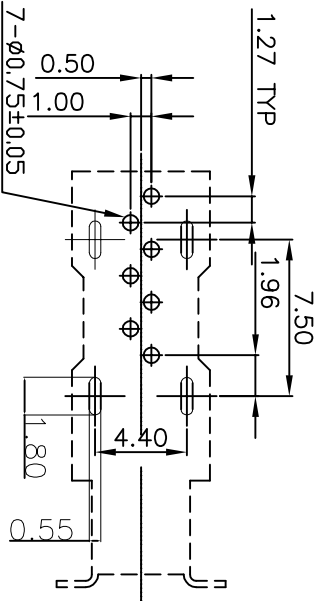
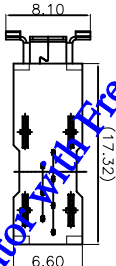
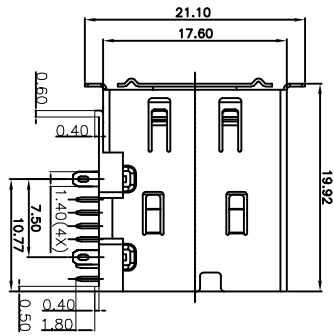
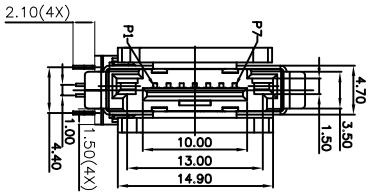

P.C.B. BOARD MOUNTING DIMENSIONS T=1.60mm
PCB TOLERANCE: ±0.05

PIN DEFINITION	
ESATA	NAME TYPE
	P1 GND
	P2 A+
	P3 A-
	P4 GND
	P5 B-
	P6 B+
	P7 GND

PDFFill PDF Editor with Free Writer and Tools

mat'l. code	14	surface sg	tolerance	projection	product family
lfr ecn no	dr date	ISO 1302	ISO 406	ISO 100	533
A	107-1074S.LIN	2007-05-23	angles	.X±0.38	E-SATA_UP_RIGHT DIP_TYPE
B	108-1082S.LIN	2008-04-28	line ar	.XX±0.25	
C	110-0184S.LIN	2010-12-14	σ±Z	.XXX±0.100	scale 2:1
D	T-00544QS.LIN	2011-08-31	STERLING.LIN	2007-05-24	
E	EX-S-007881	HKL	2011-10-17	ENGJ	HKLIM
F	EX-S-011878	HKL	2012-06-08	CHT	HKLIM
G	EX-S-23408	HKL	2016-03-03	QPPD	KPTAY
Sheet	Revision	1	2	3	107 109 111 113 115 117 119 121
Index	Sheet	G	G	G	106 108 110 112 114 116 118 120 122 124 126 128 130 132 134 136 138

- NOTES:
1. MATERIAL: THERMOPLASTIC HIGH TEMP WITH 30% G/F UL94 V-0
 2. FINISH: CONTACT: COPPER ALLOY; SHELL/BOARD LOCK: COPPER ALLOY
 3. CONTRACT/GOLD PLATING ON CONTACT AREA
 4. BOARD LOCK: 50μ" MIN. NICKEL UNDERPLATING OVER ALL SHELL/BOARD LOCK; 50μ" MIN. NICKEL PLATING OVER ALL
 5. IN A WAVE SOLDER APPLICATION WITH A 1.5MM PCB
 6. PRODUCT SPEC : 05-12-386
 7. PACKING SPEC : 05-14-1109
 8. PRODUCT NUMBERING: 10074141 - 2 0 X X X LF — LEAD FREE
6. A SYMBOL Δ WILL BE NEXT TO ANY DIMENSION, VIEW OR NOTE, WHICH HAS BEEN MODIFIED WITH THE CURRENT DRAWING REVISION
- 2: LAYOUTS
 1: 15μ" GOLD PLATING
 2: 0.7μ" GOLD PLATING
 PACKING: TRAY PACKING
 BLANK: TRAY PACKING