

DESCRIPTION: 0.085 RIBBON - DIP SOLDER

	014	024	036	050
A	1.516	1.941	2.441	3.055
	38.50	49.30	62.00	77.60
B	1.004	1.429	1.941	2.538
	25.50	36.30	49.30	64.47

MATERIAL:

INSULATION: PBT - UL 94V-0 RATED
 CONTACTS: PHOSPHOR BRONZE
 CONTACT PLATING: GOLD FLASH IN THE MATING AREA
 BRIGHT TIN IN THE SOLDER AREA
 SHELL: STEEL, NICKEL PLATED

ELECTRICAL:

CURRENT RATING: 1 AMPS
 VOLTAGE RATING: 1,000V AC r.m.s.
 INSULATION RESISTANCE: 1,000MegOhms Min. @ 500VDC
 CONTACT RESISTANCE: 30MilliOhms Max.
 OPERATING TEMPERATURE: -55°C TO +125°C

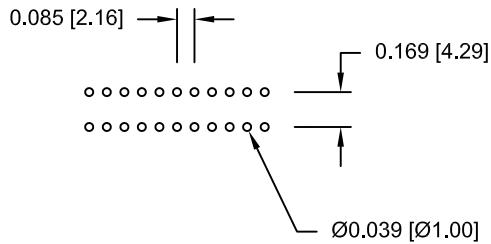
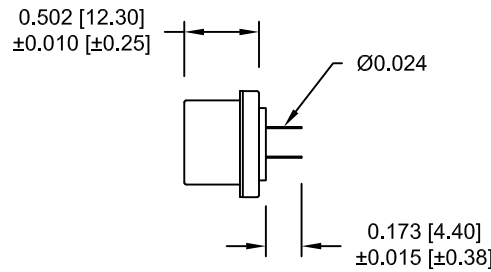
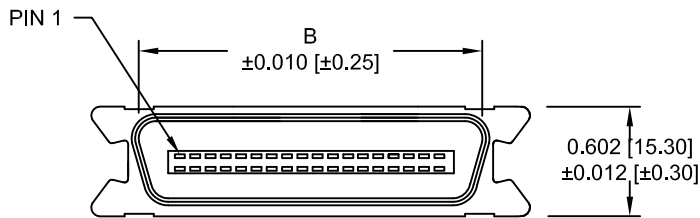
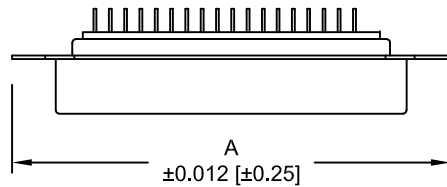

111-YYY-1 1 3 L 10 1

SERIES _____
 POSITIONS _____
 036 _____
 050 _____
 GENDER _____
 1 = MALE _____
 TERMINATION _____
 1 = DIP SOLDER _____
 RoHS COMPLIANT _____
 L = LOW TEMP. PROCESS _____
 SHELL PLATING _____
 3 = NICKEL _____
 HARDWARE _____
 10 = BAIL LATCH RECEPTACLE _____
 PLATING _____
 1 = GOLD FLASH _____

UNITS = inch[mm]

DO NOT SCALE FROM DRAWING



THESE DRAWINGS AND SPECIFICATIONS ARE THE PROPERTY OF NorComp AND SHALL NOT BE REPRODUCED, COPIED OR USED AS THE BASIS FOR THE MANUFACTURE OF SALE OF APPARATUS WITHOUT WRITTEN PERMISSION.

DRAWN: WAYNE ROBBINS		DATE: 09-15-05	
SCALE: NTS	SHEET 1	OF 1	REV 7
DWG NO. 111-YYY-113L101			

RoHS COMPLIANT

NorComp