

# HDC140 Series

Low Profile SMD Drum Core Inductors

**HALO**  
ELECTRONICS, INC.



## Product Features:

- Low cost series of miniature power inductors
- Ideal for portable equipment such as hand-held PDA's, palmtop computers as well as test equipment
- Available in tape and reel packaging.
- Please contact your representative for custom designs.

| Part Number   | IND $\pm 20\%$<br>( $\mu\text{H}$ ) | DCR (max)<br>(ohm) | SRF (typ)<br>(MHz) | IDC (max) <sup>1</sup><br>(A) |
|---------------|-------------------------------------|--------------------|--------------------|-------------------------------|
| HDC140-100MTR | 10                                  | 0.11               | 35                 | 2.4                           |
| HDC140-150MTR | 15                                  | 0.15               | 33                 | 2.0                           |
| HDC140-220MTR | 22                                  | 0.23               | 25                 | 1.6                           |
| HDC140-330MTR | 33                                  | 0.30               | 19                 | 1.4                           |
| HDC140-470MTR | 47                                  | 0.39               | 14                 | 1.0                           |
| HDC140-680MTR | 68                                  | 0.66               | 12                 | 0.9                           |
| HDC140-101MTR | 100                                 | 0.84               | 10                 | 0.7                           |
| HDC140-151MTR | 150                                 | 1.20               | 8.0                | 0.6                           |
| HDC140-221MTR | 220                                 | 1.9                | 6.0                | 0.5                           |
| HDC140-331MTR | 330                                 | 2.7                | 5.0                | 0.4                           |
| HDC140-471MTR | 470                                 | 4.0                | 4.0                | 0.3                           |
| HDC140-681MTR | 680                                 | 5.3                | 3.0                | 0.2                           |
| HDC140-102MTR | 1000                                | 8.4                | 2.5                | 0.1                           |

## Notes:

1. DC current that will cause inductance (L) drop by 10% from nominal value
2. Operating temperature range of -40C to +85C

# HDC140 Series

## Package Dimensions (mm)



## Recommended Solder Pad

## Tape & Reel Specifications

### HDC140-

1500 PARTS PER REEL

### CARRIER TAPE DIMENSIONS (mm)



### REEL DIMENSIONS (mm)



2880 Lakeside Drive #116  
 Santa Clara, CA 95054  
 (650) 903-3800  
[www.haloelectronics.com](http://www.haloelectronics.com)

HALO® Electronics is a leading supplier of high quality communication magnetics including signal transformers, filters, CMR chokes, PoE power transformers, DC/DC converters, and integrated Ethernet connectors. HALO's leading edge technology solutions are manufactured in ISO9001 and ISO14001 factories offering high quality products at a competitive price.

# HDC205 Series

SMD Drum Core Inductors

**HALO**  
ELECTRONICS, INC.



## Product Features:

- Low cost series of SMD miniature power inductors
- The high energy storage capability makes the HDC205 series ideal for DC-DC conversion in handheld PDA's and notebook computers
- Available in tape and reel packaging.
- Please contact your representative for custom designs.

| Part Number   | IND $\pm 20\%$<br>( $\mu\text{H}$ ) | DCR (max)<br>(ohm) | SRF (typ)<br>(MHz) | IDC (max) <sup>1</sup><br>(A) |
|---------------|-------------------------------------|--------------------|--------------------|-------------------------------|
| HDC205-1R0MTR | 1.0                                 | .009               | 100                | 9.0                           |
| HDC205-1R5MTR | 1.5                                 | .010               | 90                 | 8.0                           |
| HDC205-2R2MTR | 2.2                                 | .012               | 80                 | 7.0                           |
| HDC205-3R3MTR | 3.3                                 | .015               | 65                 | 6.4                           |
| HDC205-4R7MTR | 4.7                                 | .018               | 45                 | 5.4                           |
| HDC205-6R8MTR | 6.8                                 | .027               | 38                 | 4.6                           |
| HDC205-100MTR | 10                                  | .038               | 30                 | 3.8                           |
| HDC205-150MTR | 15                                  | .046               | 27                 | 3.0                           |
| HDC205-220MTR | 22                                  | .085               | 19                 | 2.6                           |
| HDC205-330MTR | 33                                  | 0.10               | 15                 | 2.0                           |
| HDC205-470MTR | 47                                  | 0.14               | 12                 | 1.6                           |
| HDC205-680MTR | 68                                  | 0.20               | 10                 | 1.4                           |
| HDC205-101MTR | 100                                 | 0.28               | 9.0                | 1.2                           |
| HDC205-151MTR | 150                                 | 0.40               | 6.0                | 1.0                           |
| HDC205-221MTR | 220                                 | 0.61               | 5.0                | 0.8                           |
| HDC205-331MTR | 330                                 | 1.02               | 4.5                | 0.6                           |
| HDC205-471MTR | 470                                 | 1.27               | 3.5                | 0.5                           |
| HDC205-681MTR | 680                                 | 2.02               | 2.5                | 0.4                           |
| HDC205-102MTR | 1000                                | 3.00               | 2.0                | 0.3                           |

## Notes:

1. DC current that will cause inductance (L) drop by 10% from nominal value
2. Operating temperature range of -40C to +85C

# HDC205 Series

## Package Dimensions (mm)

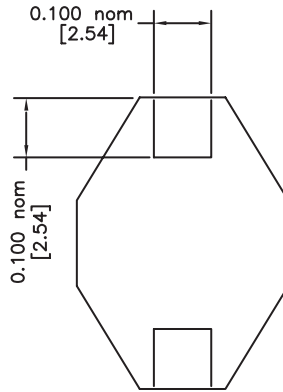
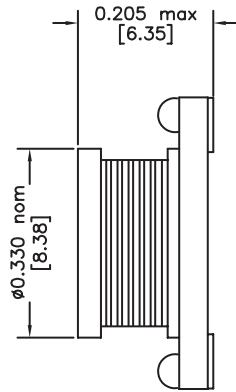
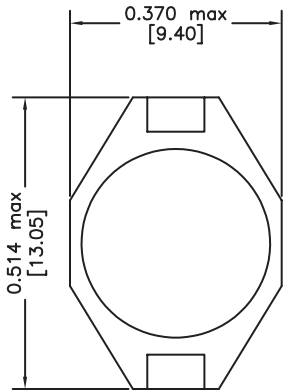

## Recommended Solder Pad

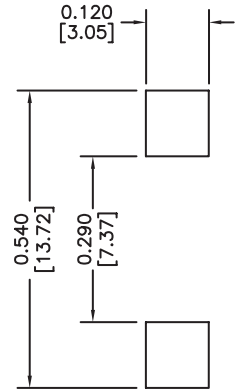

## Tape & Reel Specifications

### HDC205-

1000 PARTS PER REEL

### CARRIER TAPE DIMENSIONS (mm)

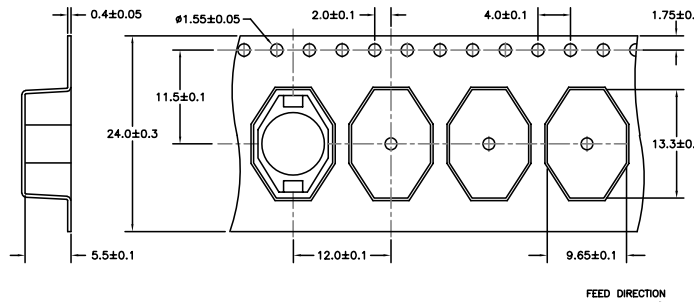

### REEL DIMENSIONS (mm)



2880 Lakeside Drive #116  
 Santa Clara, CA 95054  
 (650) 903-3800  
[www.haloelectronics.com](http://www.haloelectronics.com)

HALO® Electronics is a leading supplier of high quality communication magnetics including signal transformers, filters, CMR chokes, PoE power transformers, DC/DC converters, and integrated Ethernet connectors. HALO's leading edge technology solutions are manufactured in ISO9001 and ISO14001 factories offering high quality products at a competitive price.

# HDC450 Series

High Profile SMD Drum Core Inductors

**HALO**  
ELECTRONICS, INC.



## Product Features:

- High current, low cost series of power inductors provides excellent current handling capabilities
- Available in tape and reel packaging.
- Please contact your representative for custom designs.

| Part Number   | IND $\pm 20\%$<br>( $\mu\text{H}$ ) | DCR (max)<br>(ohm) | SRF (typ)<br>(MHz) | IDC (max) <sup>1</sup><br>(A) |
|---------------|-------------------------------------|--------------------|--------------------|-------------------------------|
| HDC450-100MTR | 10                                  | 0.04               | 22                 | 8.0                           |
| HDC450-150MTR | 15                                  | 0.05               | 18                 | 7.0                           |
| HDC450-220MTR | 22                                  | 0.066              | 11                 | 5.5                           |
| HDC450-330MTR | 33                                  | 0.08               | 9.0                | 4.0                           |
| HDC450-470MTR | 47                                  | 0.11               | 8.0                | 3.8                           |
| HDC450-680MTR | 68                                  | 0.17               | 7.0                | 3.0                           |
| HDC450-101MTR | 100                                 | 0.22               | 5.0                | 2.5                           |
| HDC450-151MTR | 150                                 | 0.34               | 4.0                | 2.0                           |
| HDC450-221MTR | 220                                 | 0.44               | 3.5                | 1.6                           |
| HDC450-331MTR | 330                                 | 0.70               | 2.5                | 1.2                           |
| HDC450-471MTR | 470                                 | 0.95               | 2.0                | 1.0                           |
| HDC450-681MTR | 680                                 | 1.20               | 2.0                | 1.0                           |
| HDC450-102MTR | 1000                                | 2.00               | 1.5                | 0.8                           |

## Notes:

1. DC current that will cause inductance (L) drop by 10% from nominal value
2. Operating temperature range of -40C to +85C

# HDC450 Series

## Package Dimensions (mm)

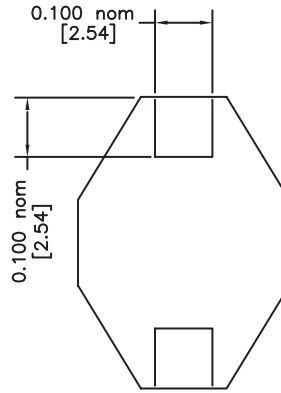
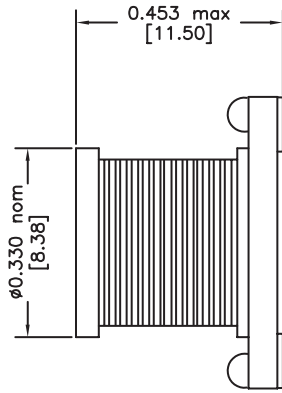
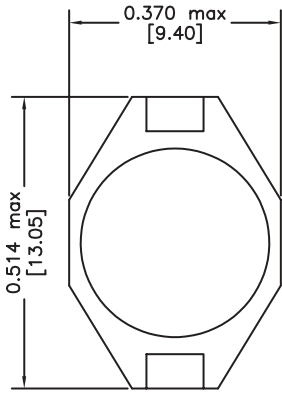

## Recommended Solder Pad

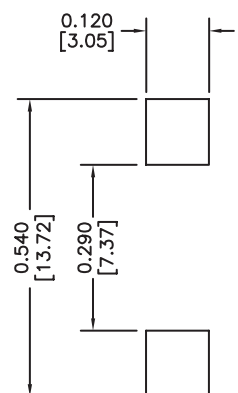

## Tape & Reel Specifications

### HDC450-

250 PARTS PER REEL

### CARRIER TAPE DIMENSIONS (mm)



### REEL DIMENSIONS (mm)



2880 Lakeside Drive #116  
 Santa Clara, CA 95054  
 (650) 903-3800  
[www.haloelectronics.com](http://www.haloelectronics.com)

HALO® Electronics is a leading supplier of high quality communication magnetics including signal transformers, filters, CMR chokes, PoE power transformers, DC/DC converters, and integrated Ethernet connectors. HALO's leading edge technology solutions are manufactured in ISO9001 and ISO14001 factories offering high quality products at a competitive price.