

**DC BLOCK N****0.01 - 6 GHZ****R443.171.000****Series : DC BLOCK**

scale 1/1

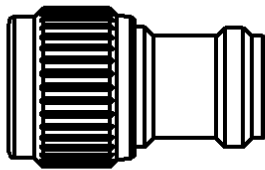
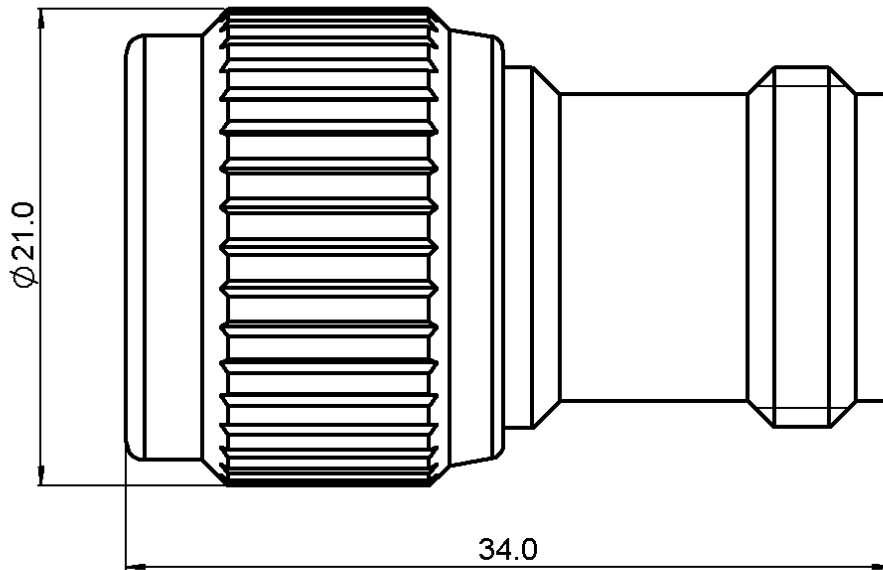
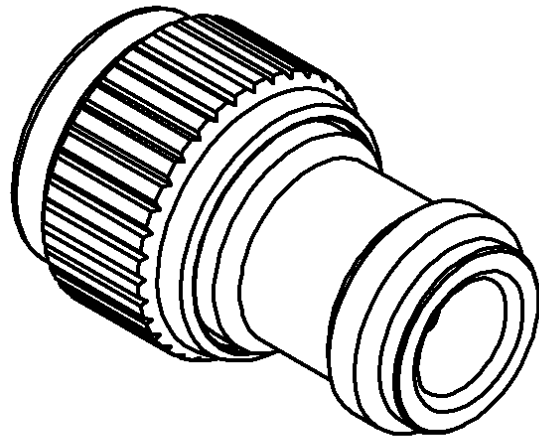

Il dimensions are in mm.

COMPONENTS	MATERIALS	PLATING(μm)
BODY	BRASS	NICKEL 2
MALE CENTER CONTACT	BRASS	GOLD 0.5 OVER NICKEL 2
FEMALE CENTER CONTACT	BERYLLIUM COPPER	GOLD 0.5 OVER NICKEL 2
OUTER CONTACT		
INSULATOR	PTFE	
GASKET	SILICONE RUBBER	
SUBSTRATE		
RESISTOR		
OTHERS PARTS		

**Issue : A      0717**

In the effort to improve our products, we reserve the right to make changes judged to be necessary.

**DC BLOCK N****0.01 - 6 GHZ****R443.171.000****Series : DC BLOCK****ELECTRICAL CHARACTERISTICS**

Frequency (GHz)	0.01 - 3	3 - 6
V.S.W.R ( $\leq$ )	1.20	1.30
Insertion Loss $\leq$	0.30	0.50

Operating Frequency Range	0.01 - 6 GHz	GHz
Impedance	50	$\Omega$

Average power at 25°C	10	W (Free Air Cooled)
Typical capacitance	4700	pF
Main line maximum Voltage	60	V

**MECHANICAL CHARACTERISTICS**

Connectors	N	Male Female	MIL C39012
Weight	42,6700	g	

**ENVIRONMENTAL CHARACTERISTICS**

Operating temperature range	-40/+85 °C
Storage temperature range	-40/+85 °C

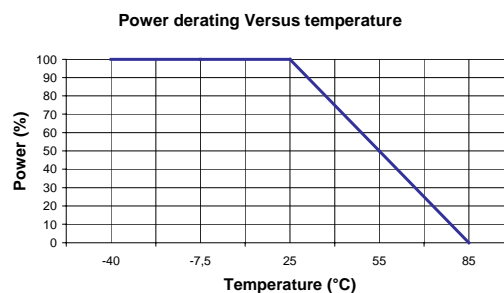
**SPECIFICATION****OTHER CHARACTERISTICS****Issue : A 0717**

In the effort to improve our products, we reserve the right to make changes judged to be necessary.