

NOTE:

1. ALL DIMENSIONS IN MM [INCH]
2. GENERAL TOLERANCE: X.X=±0.4
X.XX=±0.25
3. MATERIAL: CRS TYPE SAE 1050
HEAT TREAT TO RC 44-48
4. PLATING SPEC: SULFAMATE NICKEL, DUCTILE
NICKEL PLATE .00015/.00025
COPPER STRIKE .00020/.00050
5. NO. OF TEETH : 8 EQUALLY SPACED.
6. MINIMUM PROJECTION OF ANY SINGLE
TOOTH SHALL BE .00015, PART TO HAVE A MIN OF THE
TEETH ON ONE SIDE, 2 SIDES IS OPTIONAL.
7. 2002/95/EC (ROHS) COMPLIANT

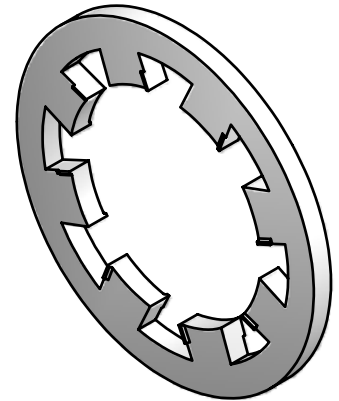

ISOMETRIC

TOOTH PROJECTION
SEE NOTE #6 $.46 \pm .05$
 $[0.018 \pm .002$ in]TOOTH WIDTH
SEE NOTE #5**E-SWITCH®**

TITLE HDW22 LOCKWASHER (FITS 10-48 BUSHING)

C	16820	REVISED AND REDRAWN	1/3/07	TN
REV	PCR NO	DESCRIPTION	DATE	BY

THE INFORMATION CONTAINED IN THIS DOCUMENT IS PROPRIETARY
TO E-SWITCH AND IS NOT TO BE COPIED OR TRANSFERRED

SCALE 8:1	DATE 1/3/2007	DR TN	DWG T200000	REV C
--------------	------------------	----------	----------------	----------