



Copyright FCI.

1 2 3 4

A

B

C

D

A

B

C

D

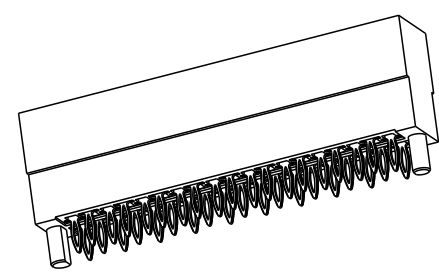
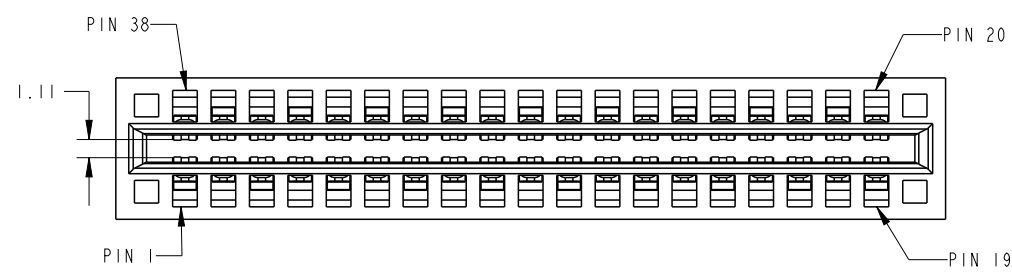

SCALE 1:1

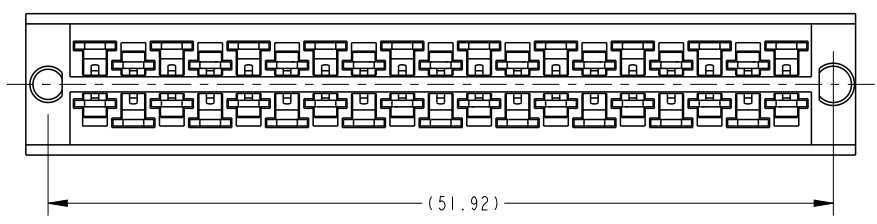
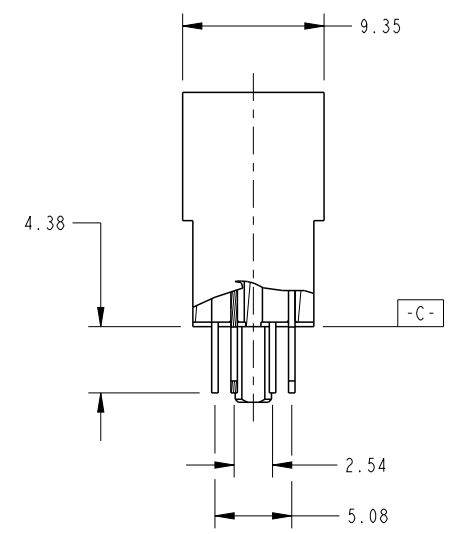
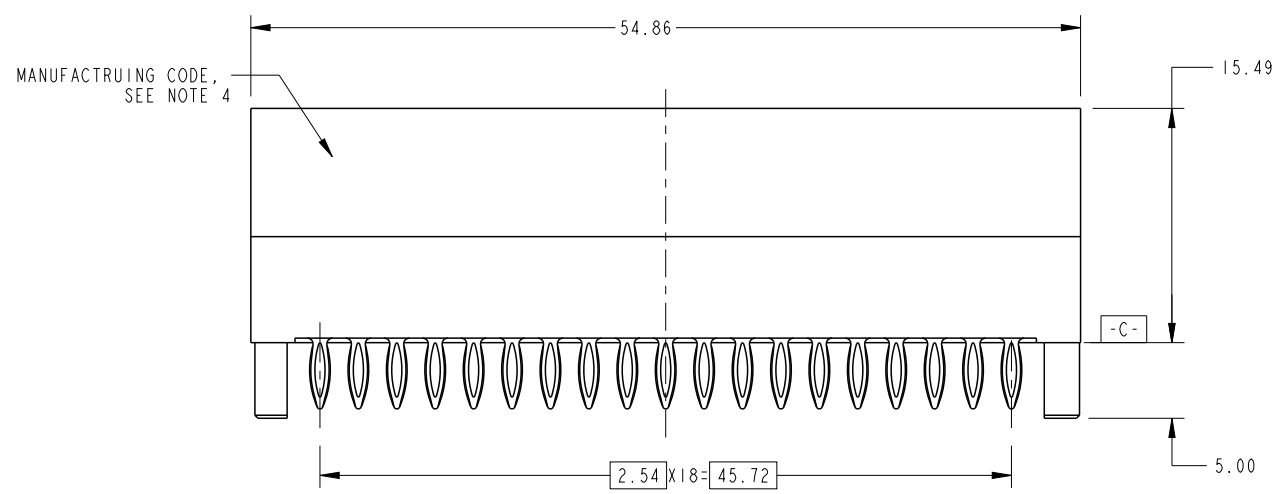

spec ref	*	dr	Jackie Huang	2014/05/26	projection	MM	size	A4	scale	2:1
tolerance std	TOLERANCES UNLESS OTHERWISE SPECIFIED	eng	Hai-Ling Liu	2014/06/13			ecn no	-		
		chr	-	-			rel level	Released		
		appr	Pei-Ming Zheng	2014/06/13	product family					
surface	linear	0.X	±0.50		title	PRESS FIT TYPE POWER EDGE CONNECTOR	dwg no	10130319-004LF	rev	A
		0.XX	±0.25							
		0.XXX	±0.10							
	angular	0°	±2°	www.fci.com	cat. no.	Product - Customer Drw	sheet 1 of 2			

PrintE File - REV C - 2009-06-09

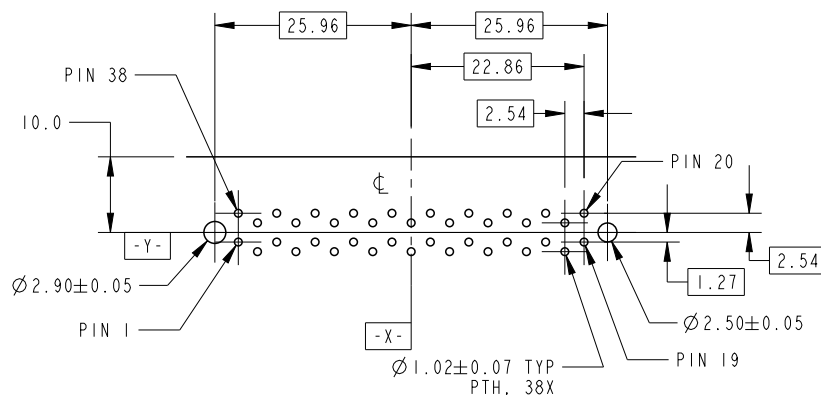

RECOMMENDED PCB LAYOUT
PCB THICKNESS: 3.18mm

CONNECTOR NOTE:

1. HOUSING MATERIAL: HIGH TEMPERATURE THERMOPLASTIC
UL 94V-0, FLAME RETARDANT HALOGEN FREE
2. TERMINAL: COPPER ALLOY
3. CONTACT FINISH REF GS-12-259 SECTION 4.2.2
4. MANUFACTURING CODE REF GS-24-007.

PCB NOTE:

5. ALL THROUGH HOLES ARE LOCATED WITH A TRUE POSITION OF 0.1mm.
6. ALL DIAMETERS ARE FINISHED HLD SIZES.
7. $\varnothing 1.15\text{mm}$ DRILLED HOLES, PLATED WITH 0.007mm MIN. HASL-FREE Pb.
OVER 1.03mm TO 0.08mm Cu PLATING TO ACHIEVE A $1.02\pm 0.07\text{mm}$ HOLE.

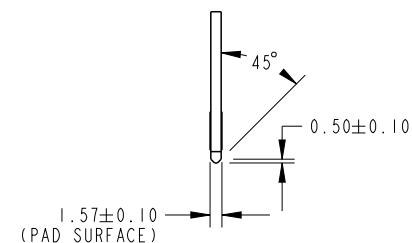
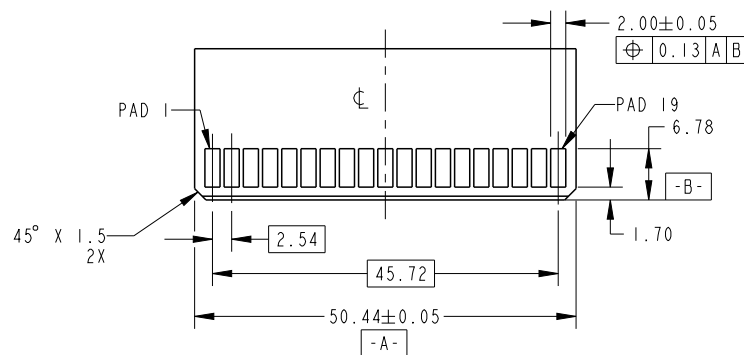

dr	Jackie Huang	2014/05/26	<div>projection</div> <div></div>	<div>MM</div> <div></div>	size	A4	scale	1:1
eng	Hai-Ling Liu	2014/06/13			ecn no	-		
chr	-	-			rel level	Released		
appr	Pei-Ming Zheng	2014/06/13	product family					
		title			dwg no		rev	
		PRESS FIT TYPE			10130319-004LF		A	
		POWER EDGE CONNECTOR						
www.fci.com		cat. no.		Product - Customer Drw			sheet 2 of 2	