

BS-21740-000

SHT 1.1

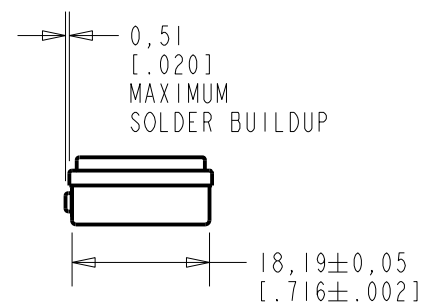
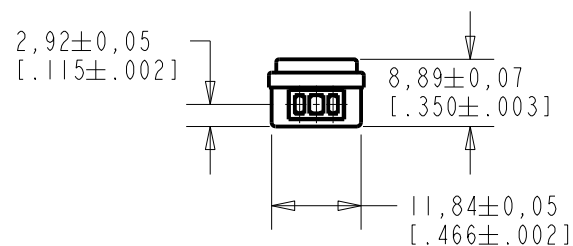
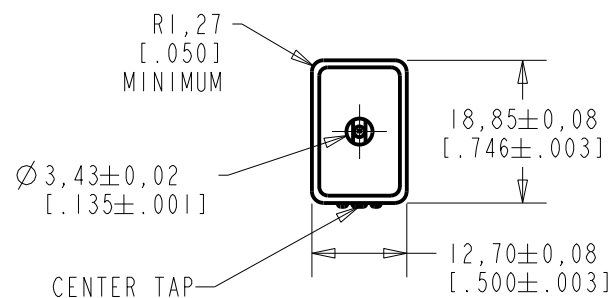

SCALE 1:1
NOMINAL WEIGHT
5.1 GRAMS

DIMENSIONS IN MILLIMETERS [INCHES]

KNOWLES ELECTRONICS
ITASCA, ILLINOIS U.S.A.

Revision	C.O. #	Implementation Date	RELEASE LEVEL	REVISION
C	MI0104194	6-24-11	Active	C
B	MI0102962	7-30-09		
A	MI0101091	5-16-06		
SCALE: 1:1			DR. BY	
DO NOT SCALE DRAWING			MMM	5-16-06
TITLE: BEEPER-SPEAKER			CK. BY	DATE
OUTLINE DRAWING			GJP	6-6-06
BS-21740-000			APP. BY	DATE
SHT 1.1			GJP	6-6-06

BEEPER-SPEAKER RESPONSE:

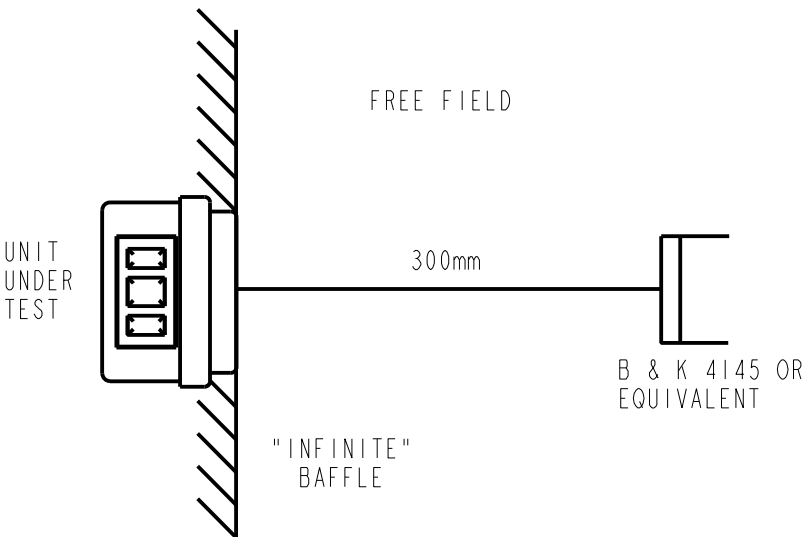

FIG. 1

NOTES:

1. SENSITIVITY IN dB RELATIVE TO .0002 MICROBAR (2×10^{-5} N/m²) FOR THE CONDITIONS SHOWN IN "2 & 3" BELOW.
2. MEASUREMENTS MADE WITH UNIT MOUNTED FLUSH IN AN "INFINITE" BAFFLE FACING A FREE FIELD. A B & K 1" FREE FIELD MICROPHONE MOUNTED AT NORMAL INCIDENCE AT A DISTANCE 300mm FROM THE BAFFLE IS USED TO MONITOR THE SOUND PRESSURE. SEE FIG 1.
3. ELECTRICAL SIGNAL (ACROSS WINDINGS IN SERIES):
SOURCE RESISTANCE: <1 OHM
DC CURRENT: 0.0 mA
SIGNAL: 5.2 VOLTS PEAK-TO-PEAK SQUARE WAVE
4. NOMINAL IMPEDANCE (WINDINGS IN SERIES): 340 OHMS AT 1kHz
5. NOMINAL DC RESISTANCE (WINDINGS IN SERIES): 67 OHMS
6. SENSITIVITY:
85 dB MINIMUM AT SOME FREQUENCY BETWEEN 1800 AND 2200 Hz
83 dB MINIMUM AT SOME FREQUENCY BETWEEN 2800 AND 3200 Hz

NOTE: THE PEAKS OF OUTPUT MAY LIE JUST OUTSIDE THE FERQUENCY LIMITS.

KNOWLES ELECTRONICS
ITASCA, ILLINOIS U.S.A.

Revision	C.O. #	Implementation Date	RELEASE LEVEL		REVISION
C	M10104194	6-24-11	Active		C
B	M10102962	7-30-09			
A	M10101091	5-16-06			
WHEN TEST LIMITS ARE USED TO ESTABLISH INCOMING INSPECTION ACCEPTANCE/REJECTION CRITERIA, CORRELATION OF TEST EQUIPMENT WITH KNOWLES IS ALSO REQUIRED FOR ELIMINATION OF EQUIPMENT AND TEST METHOD VARIATION				DR. BY	DATE
				MMM	5-16-06
TITLE: BEEPER - SPEAKER PERFORMANCE SPECIFICATION				CK. BY	DATE
				GJP	6-6-06
BS-21740-000 SHT 2.1				APP. BY	DATE
				GJP	6-6-06

SENSITIVITY IN dB RELATIVE TO 1.0 VOLT/0.1 Pa (N/m²)
FOR CONDITIONS SHOWN BELOW.

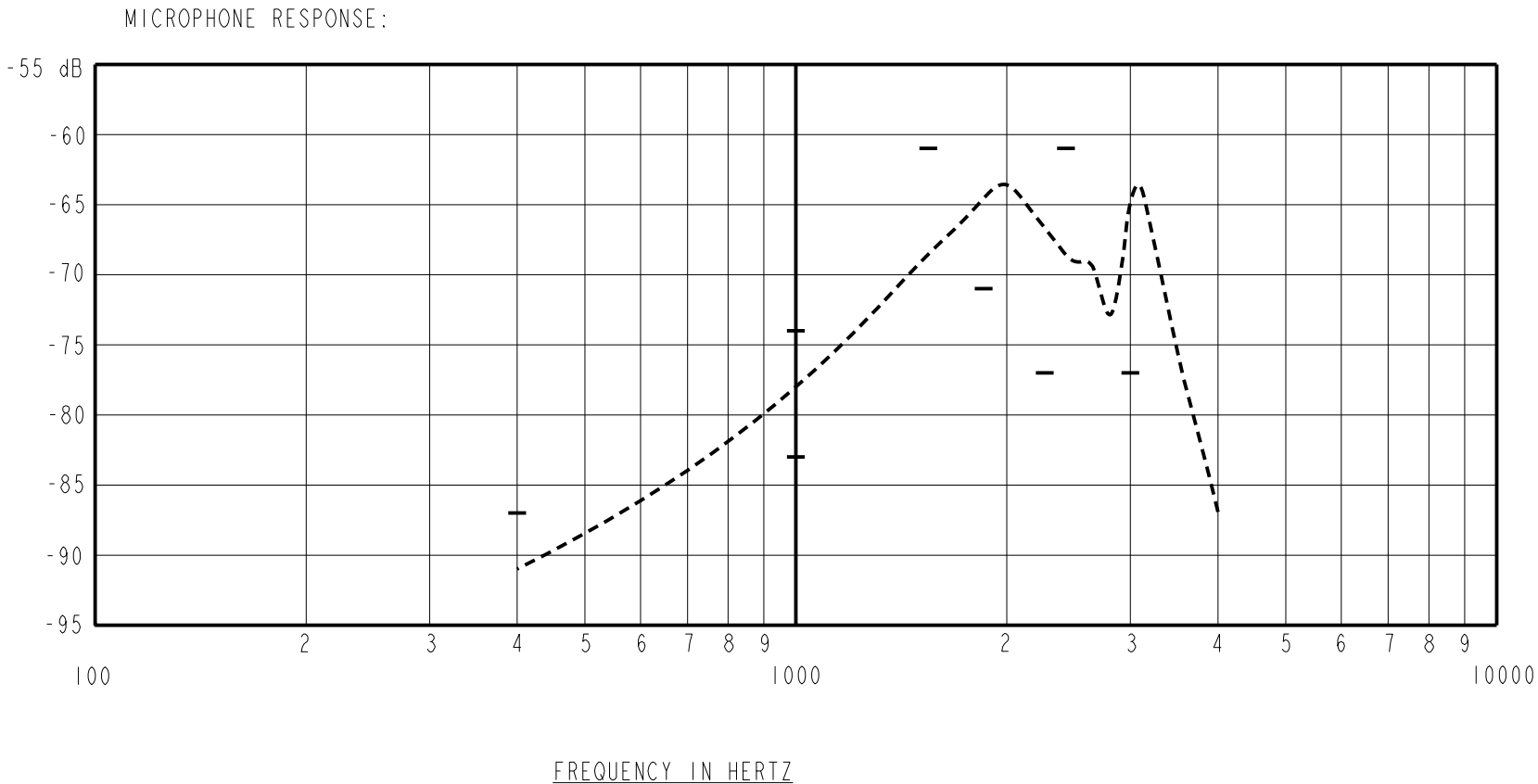

SENSITIVITY				DEVICE CONFORMITY	
FREQUENCY	MIN.	NOM.	MAX.	RANGE OF DEVIATION FROM 1KHZ	
400	---	-91	---	-17	-9
1000	-83	-78	-74	0.0	0.0
1500	---	---	---	---	17
1800	---	---	---	7	---
2200	---	---	---	1	---
2500	---	---	---	---	17
3000	---	---	---	1	---

NOTES:

- MEASUREMENTS MADE WITH 1000Ω RESISTANCE LOAD, AND 10 μBAR FIELD.
- OUTPUT MEASURED BETWEEN OUTER TERMINAL PADS.

KNOWLES ELECTRONICS
ITASCA, ILLINOIS U.S.A.

Revision	C.O. #	Implementation Date	RELEASE LEVEL		REVISION
C	M10104194	6-24-11	Active		C
B	M10102962	7-30-09			
A	M10101091	5-16-06			
WHEN TEST LIMITS ARE USED TO ESTABLISH INCOMING INSPECTION ACCEPTANCE/REJECTION CRITERIA, CORRELATION OF TEST EQUIPMENT WITH KNOWLES IS ALSO REQUIRED FOR ELIMINATION OF EQUIPMENT AND TEST METHOD VARIATION			DR. BY	DATE	
			MMM	5-16-06	
TITLE: BEEPER-SPEAKER PERFORMANCE SPECIFICATION			CK. BY	DATE	
			GJP	6-6-06	
BS-21740-000 SHT 2.2			APP. BY	DATE	
			GJP	6-6-06	