

ITEM #	PART #	QTY	DESCRIPTION
1	TJT-120-8	1	JACK ASSEMBLY, EXTERNAL THREAD
2	TJT-120-3	1	LOCK WASHER
3	TJT-120-2	1	NUT

B

TJT-120DC

NOTES:
1) TERMINALS 1,2,3,& 4 ARE BERY. CU.
2) FINISH: ALL TERMINALS PER QQ-N-290, TYPE 1, CLASS 7, NICKEL
3) ASSEMBLY TO MATE WITH TELEPHONE PLUGS TYPE U-93A/U, U-174/U, & NEXUS TP-120
4) TERMINALS 1 & 3 ARE FOR MICROPHONE CIRCUIT, TERMINALS 2 & 4 ARE FOR EARPHONE CIRCUIT
5) INSERTION FORCE: 13 LBS MAX
WITHDRAWL FORCE: 5 LBS MIN, 10 LBS MAX
6) ELECTRICAL:
A) DIALECTRIC STRENGTH - 500 VOLTS RMS MIN BETWEEN ANY PAIR OF CONTACTS.
B) INSULATION RESISTANCE - 100 MEGAOHMS MIN BETWEEN ANY PAIR OF CONTACTS
7) RECOMMENDED PANEL CUTOUT TO BE $\varnothing .703 \pm .003$

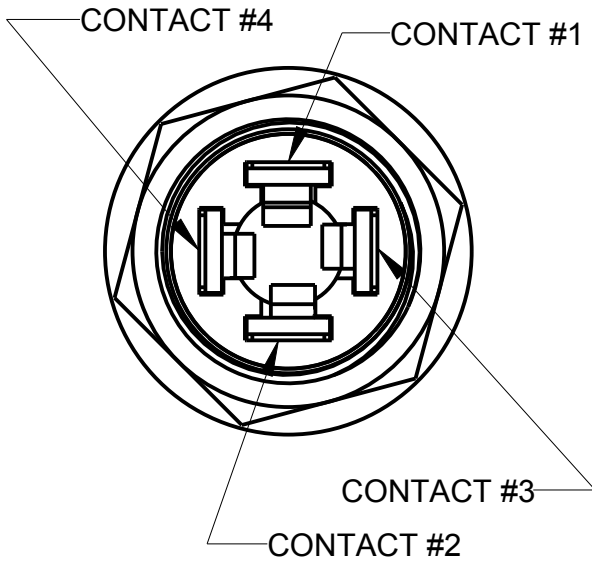
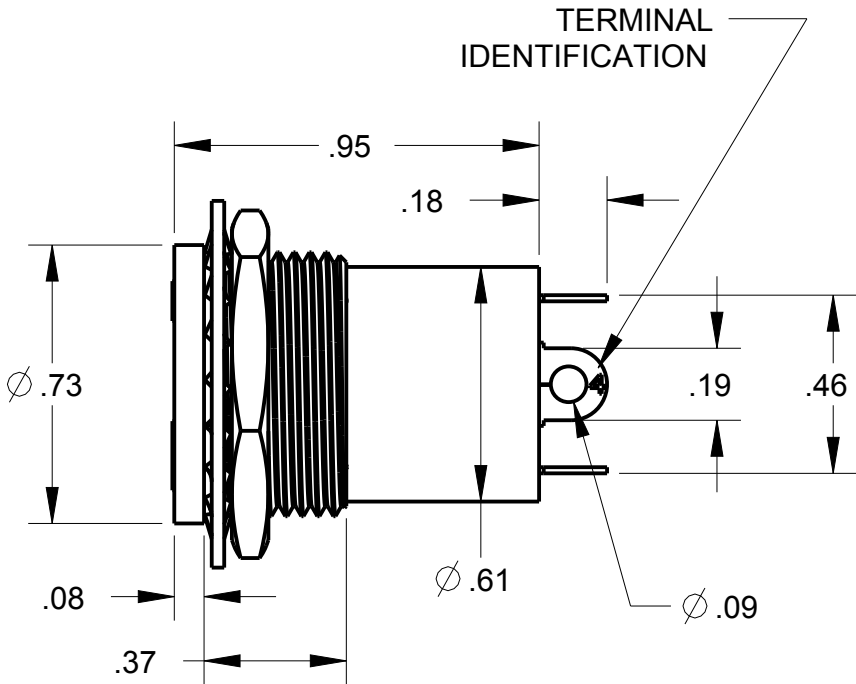
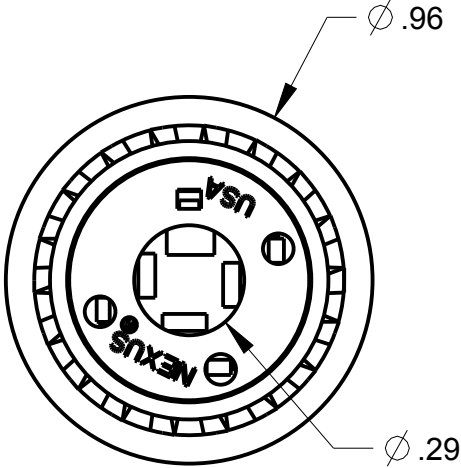
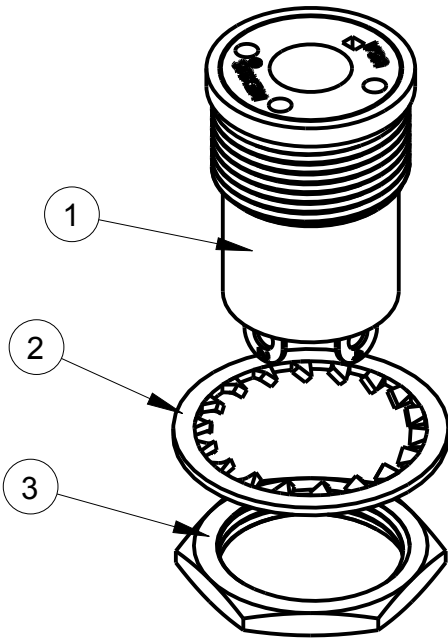

THIS DOCUMENT CONTAINS PROPRIETARY INFORMATION OF NEXUS, INCORPORATED AND SUCH INFORMATION MAY NOT BE DISCLOSED TO OTHERS FOR ANY PURPOSE OR USED FOR ANY PURPOSE WITHOUT THE WRITTEN CONSENT OF NEXUS.

B	ADD NOTE #7	184	10/4 2013	HR
A	NEW RELEASE		3/15 2013	HR
LET.	REVISION	CN #	DATE	CHK.

DWN.BY HR	DATE 3/15/13	MATERIAL		
CHECKED BY	DATE	FINISH		
APPR.BY	DATE	WEIGHT —	SCALE = 1.00 :1	NEXUS STAMFORD,CONN
UNLESS OTHERWISE SPECIFIED: DIMENSIONS ARE IN INCHES &/OR [mm] TOLERANCES: DECIMAL: .XX[X.X] .XXX[X.XX] ± .01[0.3] ± .003[0.08] FRACTION: X/X 1/64 ANGLES: X ± .5°		TITLE PHONE JACK ASSEMBLY		
		DO NOT SCALE DWG.	SHEET 1 OF 1	
		SIZE B	DWG. NO. TJT-120DC	