

REVISIONS				
REV. SYM.	E.C.O. NUMBER	DESCRIPTION	BY DATE	APP'D DATE
1		ORIGINAL RELEASE	JWJ 3/16/04	RRR 3/16/04

UNCONTROLLED DOCUMENT

WILL NOT BE UPDATED

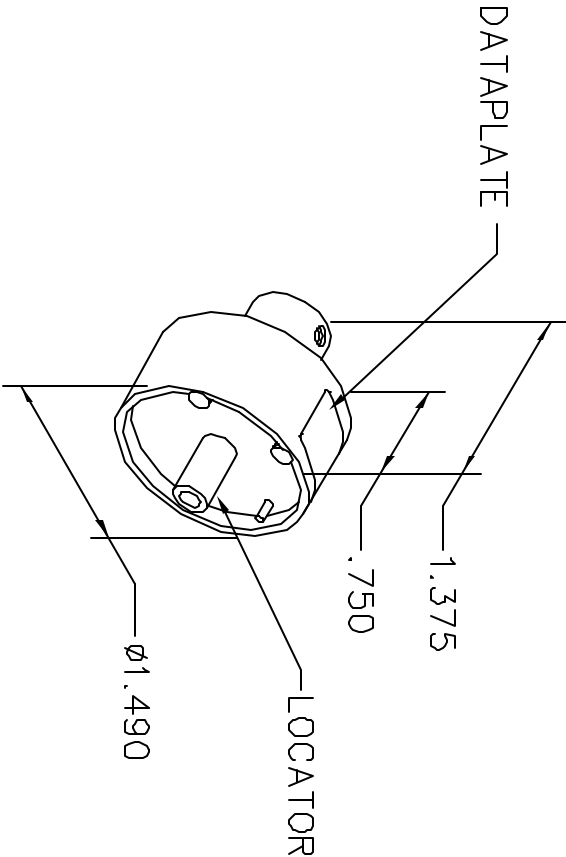

CONTACTS CKB	0.22	0.38	0.60	0.93	1.34	1.91	2.50	mm 2
S1545-0008-B	P	2	3	4	5			SEL NO
S1545-0009-B	S							
S1545-0007-B	P			4	5	6	7	
S1545-0005-B	S							
S1545-0006-B	P				6	7	8	
S1545-0004-B	S							

DATAPLATE

LOCATOR	
HOLE DIMENSIONS	ADDITIONAL FEATURES
ø.187	└┐ ø.203
▽ 1.14 MIN.	▽ .160

RESTRICTED & CONFIDENTIAL

CONFIDENTIAL PROPERTY OF DANIELS MANUFACTURING CORP. NOT TO BE DISCLOSED TO OTHERS. REPRODUCED OR USED FOR ANY OTHER PURPOSE, EXCEPT AS AUTHORIZED IN WRITING BY DANIELS MANUFACTURING. MUST BE RETURNED TO DANIELS MANUFACTURING CORP. ON COMPLETION OF ORDER OR OTHER PURPOSE FOR WHICH LENT.

DO NOT SCALE DRAWING

DRN. J. JOYCE
CHKD. RRR
APP'D.
DATE

DATE 3/16/04
DATE 3/16/04
DATE

NOTE:
THIS DRAWING IS AN OUTLINE DRAWING OF THE RESPECTIVE DMC PART NUMBER INDICATED. ACTUAL DMC PART NUMBER IS DRAWING NUMBER WITHOUT THE "-ENV" SUFFIX.

TITLE
SINGLE POSITION HEAD ENVELOPE DRAWING

WHERE USED: AFB
SIZE SCALE
A NTS
POSTING

CAD P/N TP900-1-ENV
DWG. NO. TP900-1-ENV
SHEET 1 OF 1
REV. 1

DMC DANIELS MANUFACTURING CORP. ORLANDO, FLORIDA CAGE 11851