

1.25MM CENTER FFC JUMPER CABLE (HIGH TEMPERATURE) CHART

"A" DIM.	1.18 +/- .079 INCHES 30 +/-2.00 MM		2 +/- .079 INCHES 51 +/-2.00 MM		3 +/- .118 INCHES 76 +/-3.00 MM		4 +/- .118 INCHES 102 +/-3.00 MM		5 +/- .157 INCHES 127 +/-4.00 MM		6 +/- .157 INCHES 152 +/-4.00 MM		7 +/- .157 INCHES 178 +/-4.00 MM		8 +/- .157 INCHES 203 +/-4.00 MM		9 +/- .197 INCHES 229 +/-5.00 MM		10 +/- .197 INCHES 254 +/-5.00 MM		12 +/- .197 INCHES 305 +/-5.00 MM		
	STIFFENER	TYPE "A"	TYPE "D"	TYPE "A"	TYPE "D"	TYPE "A"	TYPE "D"	TYPE "A"	TYPE "D"	TYPE "A"	TYPE "D"	TYPE "A"	TYPE "D"	TYPE "A"	TYPE "D"	TYPE "A"	TYPE "D"	TYPE "A"	TYPE "D"	TYPE "A"	TYPE "D"	TYPE "A"	TYPE "D"
CKTS: 4	151680701	151680700	151680703	151680702	151680705	151680704	151680707	151680706	151680709	151680708	151680711	151680710	151680713	151680712	151680715	151680714	151680717	151680716	151680719	151680718	151680721	151680720	
CKTS: 6	151680101	151680102	151680103	151680104	151680105	151680106	151680107	151680108	151680109	151680110	151680111	151680112	151680113	151680114	151680115	151680116	151680117	151680118	151680119	151680120	151680121	151680122	151680122
CKTS: 8	151680123	151680124	151680125	151680126	151680127	151680128	151680129	151680130	151680131	151680132	151680133	151680134	151680135	151680136	151680137	151680138	151680139	151680140	151680141	151680142	151680143	151680144	151680144
CKTS: 10	151680145	151680146	151680147	151680148	151680149	151680150	151680151	151680152	151680153	151680154	151680155	151680156	151680157	151680158	151680159	151680160	151680161	151680162	151680163	151680164	151680165	151680166	151680166
CKTS: 12	151680167	151680168	151680169	151680170	151680171	151680172	151680173	151680174	151680175	151680176	151680177	151680178	151680179	151680180	151680181	151680182	151680183	151680184	151680185	151680186	151680187	151680188	151680188
CKTS: 14	151680189	151680190	151680191	151680192	151680193	151680194	151680195	151680196	151680197	151680198	151680199	151680200	151680201	151680202	151680203	151680204	151680205	151680206	151680207	151680208	151680209	151680210	151680210
CKTS: 16	151680211	151680212	151680213	151680214	151680215	151680216	151680217	151680218	151680219	151680220	151680221	151680222	151680223	151680224	151680225	151680226	151680227	151680228	151680229	151680230	151680231	151680232	151680232
CKTS: 18	151680233	151680234	151680235	151680236	151680237	151680238	151680239	151680240	151680241	151680242	151680243	151680244	151680245	151680246	151680247	151680248	151680249	151680250	151680251	151680252	151680253	151680254	151680254
CKTS: 20	151680255	151680256	151680257	151680258	151680259	151680260	151680261	151680262	151680263	151680264	151680265	151680266	151680267	151680268	151680269	151680270	151680271	151680272	151680273	151680274	151680275	151680276	151680276
CKTS: 22	151680277	151680278	151680279	151680280	151680281	151680282	151680283	151680284	151680285	151680286	151680287	151680288	151680289	151680290	151680291	151680292	151680293	151680294	151680295	151680296	151680297	151680298	151680298
CKTS: 24	151680299	151680300	151680301	151680302	151680303	151680304	151680305	151680306	151680307	151680308	151680309	151680310	151680311	151680312	151680313	151680314	151680315	151680316	151680317	151680318	151680319	151680320	151680320
CKTS: 26	151680321	151680322	151680323	151680324	151680325	151680326	151680327	151680328	151680329	151680330	151680331	151680332	151680333	151680334	151680335	151680336	151680337	151680338	151680339	151680340	151680341	151680342	151680342
CKTS: 28	151680343	151680344	151680345	151680346	151680347	151680348	151680349	151680350	151680351	151680352	151680353	151680354	151680355	151680356	151680357	151680358	151680359	151680360	151680361	151680362	151680363	151680364	151680364
CKTS: 30	151680365	151680366	151680367	151680368	151680369	151680370	151680371	151680372	151680373	151680374	151680375	151680376	151680377	151680378	151680379	151680380	151680381	151680382	151680383	151680384	151680385	151680386	151680386
CKTS: 32	151680387	151680388	151680389	151680390	151680391	151680392	151680393	151680394	151680395	151680396	151680397	151680398	151680399	151680400	151680401	151680402	151680403	151680404	151680405	151680406	151680407	151680408	151680408
CKTS: 34	151680409	151680410	151680411	151680412	151680413	151680414	151680415	151680416	151680417	151680418	151680419	151680420	151680421	151680422	151680423	151680424	151680425	151680426	151680427	151680428	151680429	151680430	151680430
CKTS: 36	151680431	151680432	151680433	151680434	151680435	151680436	151680437	151680438	151680439	151680440	151680441	151680442	151680443	151680444	151680445	151680446	151680447	151680448	151680449	151680450	151680451	151680452	151680452
CKTS: 38	151680453	151680454	151680455	151680456	151680457	151680458	151680459	151680460	151680461	151680462	151680463	151680464	151680465	151680466	151680467	151680468	151680469	151680470	151680471	151680472	151680473	151680474	151680474
CKTS: 40	151680475	151680476	151680477	151680478	151680479	151680480	151680481	151680482	151680483	151680484	151680485	151680486	151680487	151680488	151680489	151680490	151680491	151680492	151680493	151680494	151680495	151680496	151680496

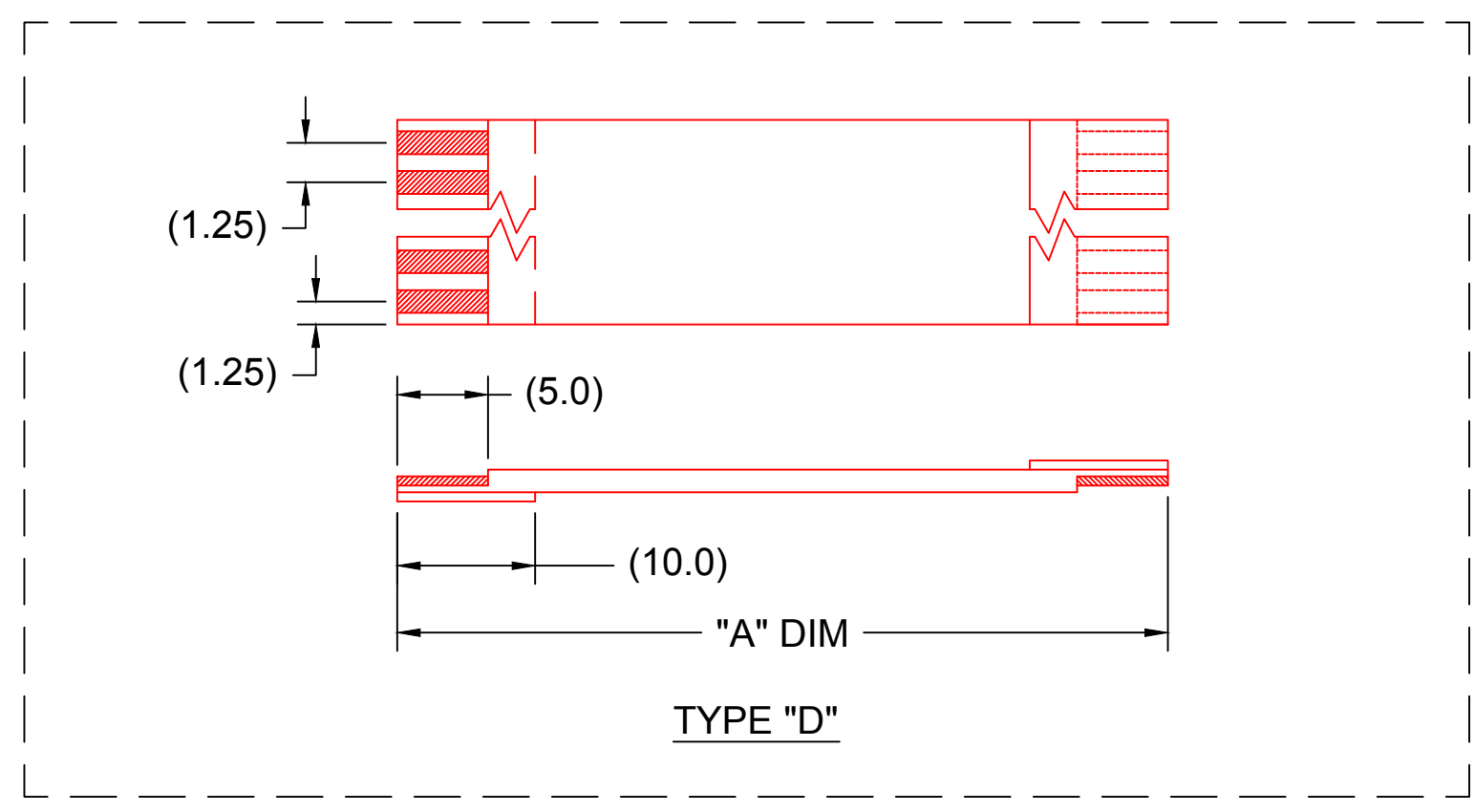
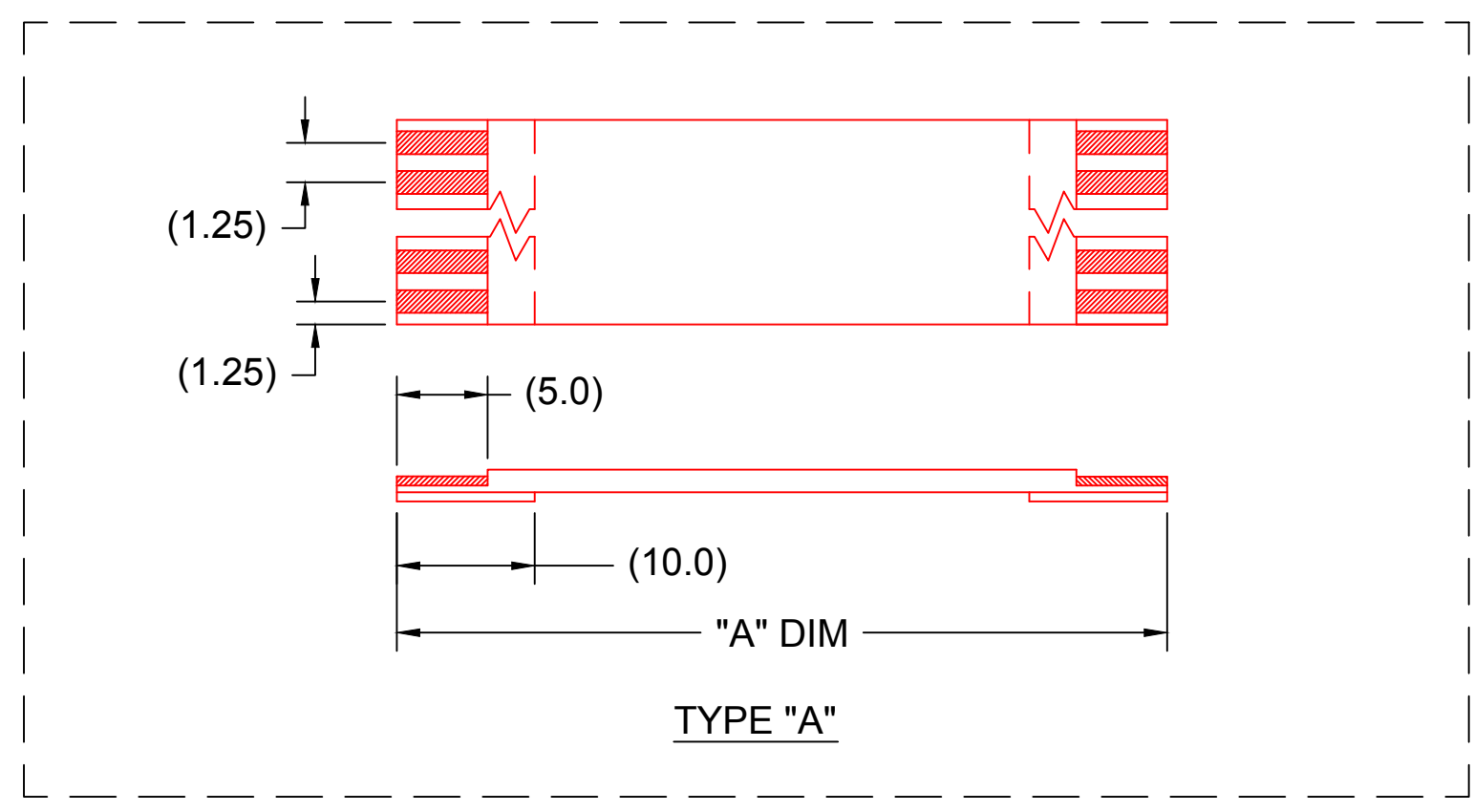

NOTES:
 1. NO PRINTING ON JUMPER CABLE UNLESS OTHERWISE SPECIFIED. IF PRINTING IS REQUIRED, THEN IT WOULD BE CONSIDERED A SPECIAL JUMPER CABLE.

RELEASED EC NO: USW2012-0099 DRWN: JLW 2011/10/28 DESCRIPTION REV 1	QUALITY SYMBOL	GENERAL TOLERANCES (UNLESS SPECIFIED)		DIMENSION STYLE		SCALE	DESIGN UNITS	THIRD ANGLE PROJECTION		
	▽=0 ∇=0	mm	INCH	MM		---	METRIC			
		4 PLACES	±---	±---	DRAWN BY	DATE	TITLE			
		3 PLACES	±---	±---	CHECKED BY	DATE	1.25MM CENTER FFC JUMPER CABLE			
		2 PLACES	±---	±---	APPROVED BY	DATE	MOLEX INCORPORATED			
	1 PLACE	±---	±---	SFULTON 2011/11/03		DOCUMENT NO.		SD-15168-001		
		ANGULAR ±1/2°		MATERIAL NO.		SHEET NO.				
		DRAFT WHERE APPLICABLE MUST REMAIN WITHIN DIMENSIONS		SEE CHART		SD-15168-001		1 OF 2		
		SIZE C	THIS DRAWING CONTAINS INFORMATION THAT IS PROPRIETARY TO MOLEX INCORPORATED AND SHOULD NOT BE USED WITHOUT WRITTEN PERMISSION							

1.25MM CENTER FFC JUMPER CABLE (HIGH TEMPERATURE) CHART

"A" DIM.	1.18 +/- .079 INCHES 30 +/-2.00 MM		2 +/- .079 INCHES 51 +/-2.00 MM		3 +/- .118 INCHES 76 +/-3.00 MM		4 +/- .118 INCHES 102 +/-3.00 MM		5 +/- .157 INCHES 127 +/-4.00 MM		6 +/- .157 INCHES 152 +/-4.00 MM		7 +/- .157 INCHES 178 +/-4.00 MM		8 +/- .157 INCHES 203 +/-4.00 MM		9 +/- .197 INCHES 229 +/-5.00 MM		10 +/- .197 INCHES 254 +/-5.00 MM		12 +/- .197 INCHES 305 +/-5.00 MM	
STIFFENER	TYPE "A"	TYPE "D"	TYPE "A"	TYPE "D"	TYPE "A"	TYPE "D"	TYPE "A"	TYPE "D"	TYPE "A"	TYPE "D"	TYPE "A"	TYPE "D"	TYPE "A"	TYPE "D"	TYPE "A"	TYPE "D"	TYPE "A"	TYPE "D"	TYPE "A"	TYPE "D"	TYPE "A"	TYPE "D"
CKTS: 5	151680723	151680722	151680725	151680724	151680727	151680726	151680729	151680728	151680731	151680730	151680733	151680732	151680735	151680734	151680737	151680736	151680739	151680738	151680741	151680740	151680743	151680742
CKTS: 7	151680745	151680744	151680747	151680746	151680749	151680748	151680751	151680750	151680753	151680752	151680755	151680754	151680757	151680756	151680759	151680758	151680761	151680760	151680763	151680762	151680765	151680764
CKTS: 9	151680767	151680766	151680769	151680768	151680771	151680770	151680773	151680772	151680775	151680774	151680777	151680776	151680779	151680778	151680781	151680780	151680783	151680782	151680785	151680784	151680787	151680786
CKTS: 11	151680789	151680788	151680791	151680790	151680793	151680792	151680795	151680794	151680797	151680796	151680799	151680798	151680801	151680800	151680803	151680802	151680805	151680804	151680807	151680806	151680809	151680808
CKTS: 13	151680811	151680810	151680813	151680812	151680815	151680814	151680817	151680816	151680819	151680818	151680821	151680820	151680823	151680822	151680825	151680824	151680827	151680826	151680829	151680828	151680831	151680830
CKTS: 15	151680833	151680832	151680835	151680834	151680837	151680836	151680839	151680838	151680841	151680840	151680843	151680842	151680845	151680844	151680847	151680846	151680849	151680848	151680851	151680850	151680853	151680852
CKTS: 17	151680855	151680854	151680857	151680856	151680859	151680858	151680861	151680860	151680863	151680862	151680865	151680864	151680867	151680866	151680869	151680868	151680871	151680870	151680873	151680872	151680875	151680874
CKTS: 19	151680877	151680876	151680879	151680878	151680881	151680880	151680883	151680882	151680885	151680884	151680887	151680886	151680889	151680888	151680891	151680890	151680893	151680892	151680895	151680894	151680897	151680896
CKTS: 21	151680899	151680898	151680901	151680900	151680903	151680902	151680905	151680904	151680907	151680906	151680909	151680908	151680911	151680910	151680913	151680912	151680915	151680914	151680917	151680916	151680919	151680918
CKTS: 23	151680921	151680920	151680923	151680922	151680925	151680924	151680927	151680926	151680929	151680928	151680931	151680930	151680933	151680932	151680935	151680934	151680937	151680936	151680939	151680938	151680941	151680940
CKTS: 25	151680943	151680942	151680945	151680944	151680947	151680946	151680949	151680948	151680951	151680950	151680953	151680952	151680955	151680954	151680957	151680956	151680959	151680958	151680961	151680960	151680963	151680962
CKTS: 27	151680965	151680964	151680967	151680966	151680969	151680968	151680971	151680970	151680973	151680972	151680975	151680974	151680977	151680976	151680979	151680978	151680981	151680980	151680983	151680982	151680985	151680984
CKTS: 29	151680987	151680986	151680989	151680988	151680991	151680990	151680993	151680992	151680995	151680994	151680997	151680996	151680999	151680998	151681001	151681000	151681003	151681002	151681005	151681004	151681007	151681006
CKTS: 31	151681009	151681008	151681011	151681010	151681013	151681012	151681015	151681014	151681017	151681016	151681019	151681018	151681021	151681020	151681023	151681022	151681025	151681024	151681027	151681026	151681029	151681028
CKTS: 33	151681031	151681030	151681033	151681032	151681035	151681034	151681037	151681036	151681039	151681038	151681041	151681040	151681043	151681042	151681045	151681044	151681047	151681046	151681049	151681048	151681051	151681050
CKTS: 35	151681053	151681052	151681055	151681054	151681057	151681056	151681059	151681058	151681061	151681060	151681063	151681062	151681065	151681064	151681067	151681066	151681069	151681068	151681071	151681070	151681073	151681072
CKTS: 37	151681075	151681074	151681077	151681076	151681079	151681078	151681081	151681080	151681083	151681082	151681085	151681084	151681087	151681086	151681089	151681088	151681091	151681090	151681093	151681092	151681095	151681094
CKTS: 39	151681097	151681096	151681099	151681098	151681101	151681100	151681103	151681102	151681105	151681104	151681107	151681106	151681109	151681108	151681111	151681110	151681113	151681112	151681115	151681114	151681117	151681116

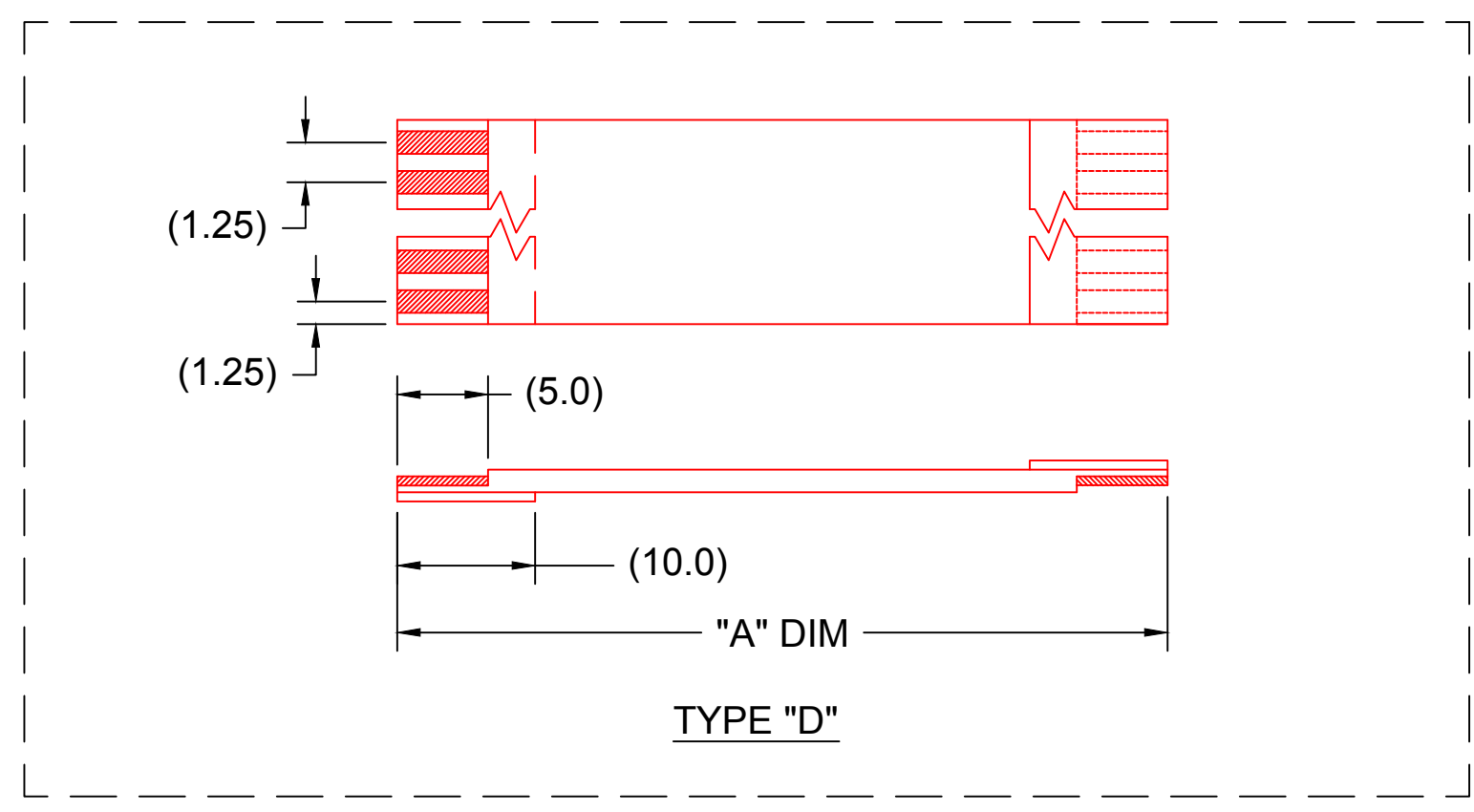
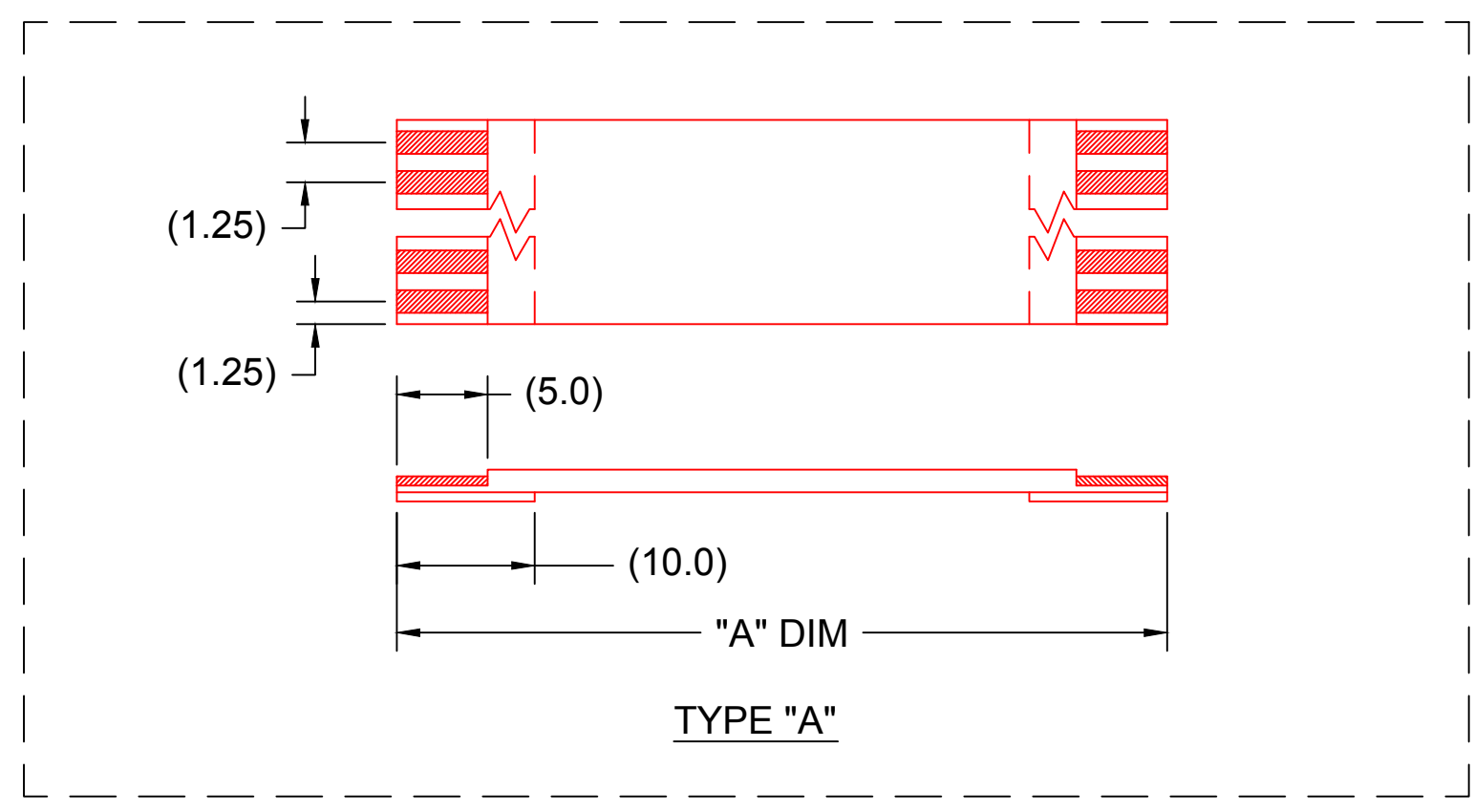

NOTES:
 1. NO PRINTING ON JUMPER CABLE UNLESS OTHERWISE SPECIFIED. IF PRINTING IS REQUIRED, THEN IT WOULD BE CONSIDERED A SPECIAL JUMPER CABLE.

SEE SHEET 1	EC NO: DRWN: 1	DESCRIPTION REV	QUALITY SYMBOL	GENERAL TOLERANCES (UNLESS SPECIFIED)	DIMENSION STYLE	SCALE	DESIGN UNITS	THIRD ANGLE PROJECTION
			▽=0	mm INCH	MM	---	METRIC	1.25MM CENTER FFC JUMPER CABLE
			▽C=0	4 PLACES ±--- ±---	DRAWN BY DATE	TITLE		
				3 PLACES ±--- ±---	CHECKED BY DATE			
	2 PLACES ±--- ±---	APPROVED BY DATE						
	1 PLACE ±--- ±---	ANGULAR ±1/2°		SFULTON 2011/11/03				
		DRAFT WHERE APPLICABLE MUST REMAIN WITHIN DIMENSIONS		SEE CHART				
				SIZE C	THIS DRAWING CONTAINS INFORMATION THAT IS PROPRIETARY TO MOLEX INCORPORATED AND SHOULD NOT BE USED WITHOUT WRITTEN PERMISSION			
							Molex MOLEX INCORPORATED	SHEET NO. 2 OF 2
							SD-15168-001	