



Main

| | |
|------------------------------------|----------------------|
| Range of product | OsiSense XU |
| Product or component type | Backlight |
| Accessory / separate part category | Lighting accessory |
| Light source | LED red : 60 x 60 mm |

Complementary

| | |
|---------------------------|---|
| Material | Aluminium box Acrylic front face |
| Product compatibility | XUW |
| Product weight | 0.35 lb(US) (0.16 kg) |
| [Us] rated supply voltage | 24 V DC with reverse polarity protection |
| Supply voltage limits | 23...25 V DC |
| Current consumption | <= 320 mA (no-load) |
| Electrical connection | 1 m cable + 1 female connector M12 5 pins |

Environment

| | |
|---------------------------------------|------------------------------|
| product certifications | CE |
| ambient air temperature for operation | 32...95 °F (0...35 °C) |
| ambient air temperature for storage | 32...95 °F (0...35 °C) |
| IP degree of protection | IP30 conforming to IEC 60529 |

Offer Sustainability

| | |
|--|--|
| Not Green Premium product | Not Green Premium product |
| WARNING: This product can expose you to chemicals including: | WARNING: This product can expose you to chemicals including: |
| Diisononyl phthalate (DINP), which is known to the State of California to cause cancer, and | Diisononyl phthalate (DINP), which is known to the State of California to cause cancer, and |
| Di-isodecyl phthalate (DIDP), which is known to the State of California to cause birth defects or other reproductive harm. | Di-isodecyl phthalate (DIDP), which is known to the State of California to cause birth defects or other reproductive harm. |
| For more information go to www.p65warnings.ca.gov | For more information go to www.p65warnings.ca.gov |

Dimensions

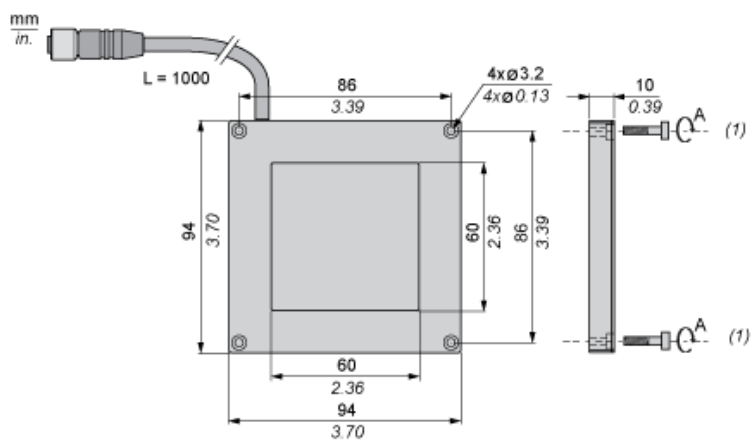

(1) Tightening torque: A = 1.2 N.m (10.6 lb-in).