

4

3

2

1

THIS DRAWING IS UNPUBLISHED. RELEASED FOR PUBLICATION ,19 .
 © COPYRIGHT 19 BY AMP INCORPORATED. ALL RIGHTS RESERVED.

LOC	DIST	REVISIONS			
P	LTR	DESCRIPTION	DATE	DWN	APVD
CM	25	M	REVISED PER EC 0G3B-0025-02	22-JAN-02	KW DC

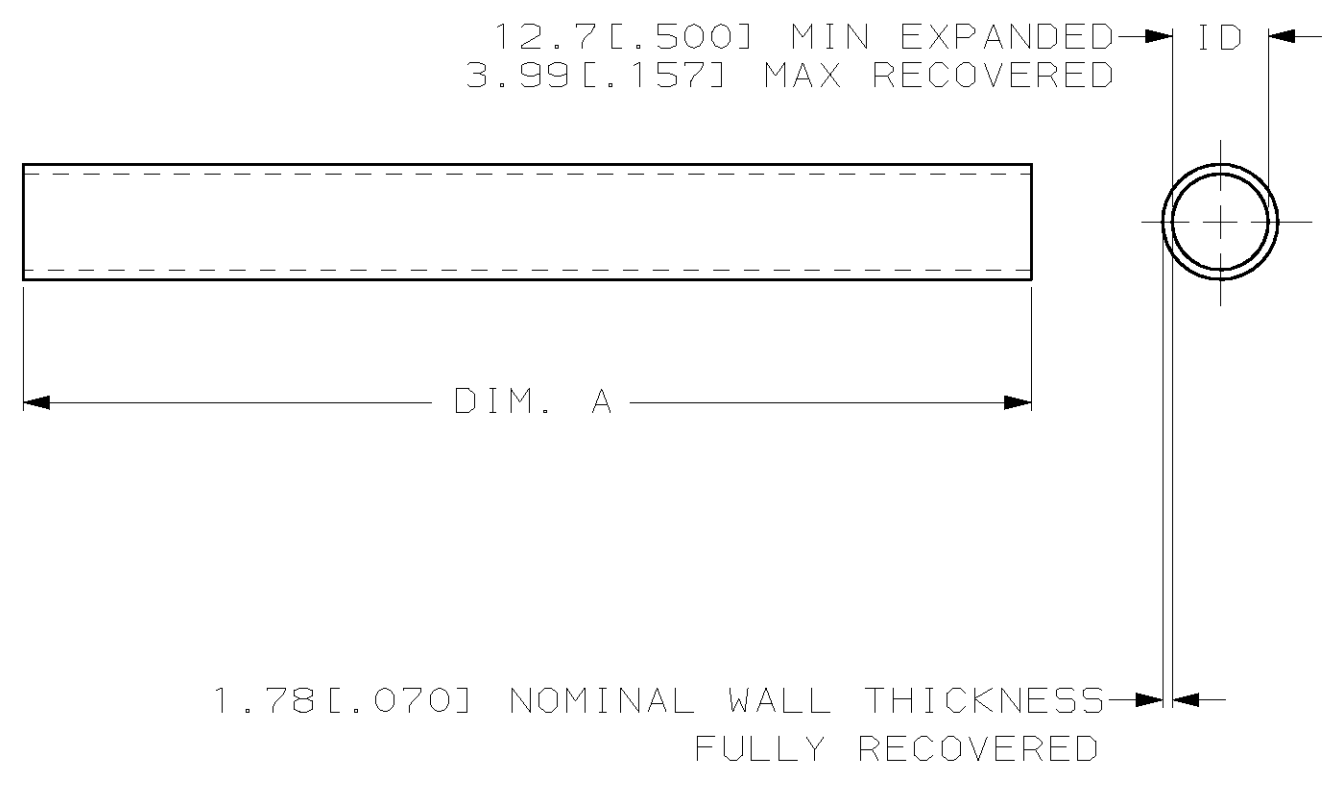

- 1 MATERIAL: TUBING- BLACK POLYOLEFIN, HEAT SHRINKABLE, TYP DWP31, FLAME RETARDANT. MEETS UL224 ALL TUBING.
- 2. ADHESIVE APPLIED TO THE ENTIRE INSIDE OF TUBING.
- 3 KIT CONSISTS OF 6 PIECES PACKAGED IN A POLYBAG.
- 4 KIT CONSISTS OF 3 PIECES PACKAGED IN A POLYBAG.

4	304.8±6.4 [12.00±.25]	8-603315-3
	101.6±2 [4.00±.08]	1-603315-4
	1219.2 ^{+25.4} ₀ [48.00 ^{+1.00} _{-.00}]	603315-4
3	304.8±6.4 [12.00±.25]	603315-3
	DIMENSION A	PART NO.

THIS DRAWING IS A CONTROLLED DOCUMENT FOR AMP INCORPORATED. IT IS SUBJECT TO CHANGE AND THE CONTROLLING ENGINEERING ORGANIZATION SHOULD BE CONTACTED FOR THE LATEST REVISION.		DWN B. SIMPSON 7/11/95	AMP Incorporated Harrisburg, PA 17105-3608	
DIMENSIONS: mm [INCHES]		CHK D. AHERON 7/18/95	NAME AMPSULATION, DWP31, HST, 1/2 INCH ID, WITH ADHESIVE	
TOLERANCES UNLESS OTHERWISE SPECIFIED: 0 PLC ±- 1 PLC ±- 2 PLC ±- 3 PLC ±- 4 PLC ±- ANGLES ±-		APVD D. KAAT 7/18/95	DRAWING NO A3 00779 C-603315	
MATERIAL 1		PRODUCT SPEC -	SCALE NONE	SHEET 1 OF 1
FINISH -		APPLICATION SPEC -	REV M	
		WEIGHT -	CUSTOMER DRAWING	