

NOTES:

1. MATERIAL: SEE TABLE
2. FINISHES: SEE TABLE
3. PACKAGING: PART IS PACKED IN CLEAR POLY BAG WITH BARCODE LABEL ATTACHED
4. MATES WITH: BRAD FEMALE RECEPTACLE
5. WIRE RANGE: 8 AWG - 14 AWG (10mm² - 2.5mm²)
6. CABLE OD RANGE: .48 - .81 (12.2mm - 20.6mm)
7. ELECTRICAL SPECIFICATIONS:
 - VOLTAGE RATING: 600V AC
 - CURRENT RATING:
 - 8 AWG - 25 AMPS
 - 10 AWG - 25 AMPS
 - 12 AWG - 20 AMPS
 - 14 AWG - 15 AMPS
8. ENVIRONMENTAL PROTECTION: IP67, IP69K

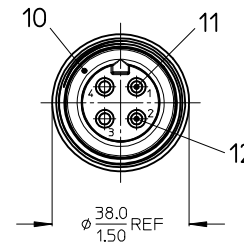
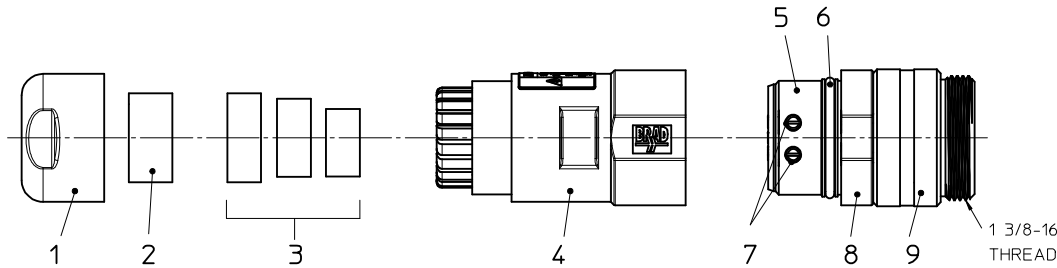
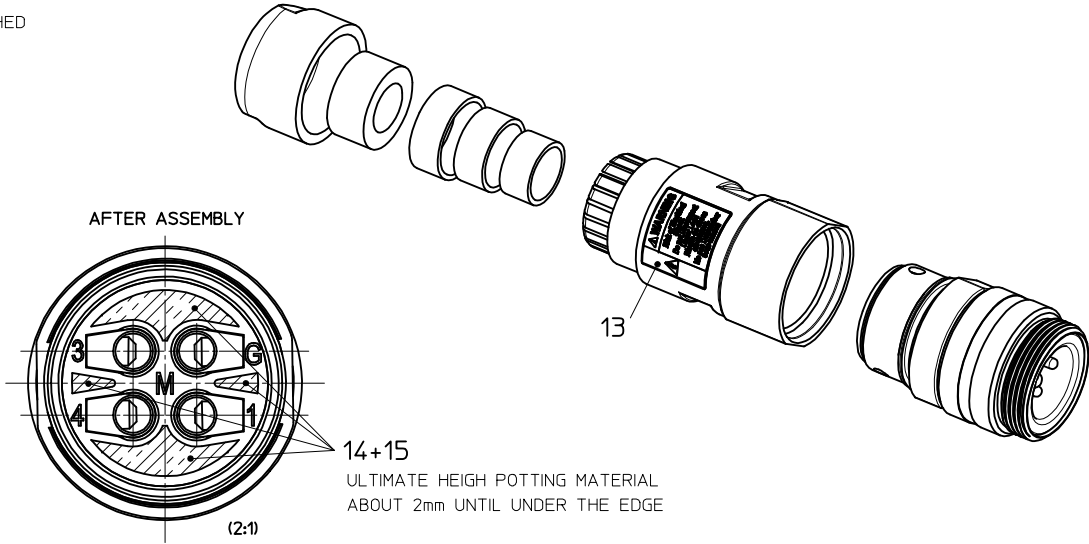
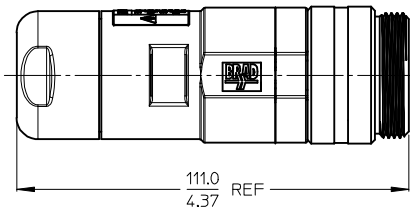

MATERIAL NO.	ENGINEERING NO.
1300700024 (FINISHED PART)	CA4006-39
1203360005 (PRE-ASSEMBLED)	1930 00090 08004

ITEM	QTY	COMPONENT	MATERIAL	FINISH
1	1	NUT M32	PA66	BK
2	1	GASKET MD 14,8x12,25	CR	GY
3	3	GASKETS MD (SMALL/MEDIUM/LARGE)	CR	BK
4	1	HOUSING FA M32	PA66	BK
5	1	INSERT ADAPTER	PA66	BK
6	1	GASKET OR 29x2,5	NBR	BK
7	4	SCREW M4x10	V2A	-
8	1	COUPLING RING	PA66	BK
9	1	NUT, INTERNAL THREAD	AL	AN (NATURAL)
10	1	INSERT AC	PVC	-
11	2	CONTACT MA	CU ALLOY	AU PLATED
12	1	CONTACT MA LEAD, PIN	CU ALLOY	AU PLATED
13	1	WARNING LABEL	PLASTIC FILM	-
14	-	POTTING MATERIAL	WEVO RESIN PU 552 FL NATUR 50	-
15	-	IMPIS RESIN HARDNER	-	-

ENTER DESCRIPTION
 EC NO: IPG2013-0945
 DRAWN:RSCHIEBER 2012/12/19
 CHKD:APOHL 2013/01/09
 APPR:CBURGER 2013/06/03

REV	DESCRIPTION
1	

QUALITY SYMBOLS	GENERAL TOLERANCES (UNLESS SPECIFIED)
▽=0	
▽=0	
	ANGULAR ±1/2°
	DRAFT WHERE APPLICABLE MUST REMAIN WITHIN DIMENSIONS

DIMENSION STYLE		SCALE	DESIGN UNITS	THIRD ANGLE PROJECTION
MM/IN		1:1	METRIC	
DRAWN BY	DATE	TITLE		
RSCHIEBER	2012/10/15	FA 4P AC MA STR UNSH		
CHECKED BY	DATE			
APUHL	2012/10/24			
APPROVED BY	DATE			
CBURGER	2013/06/03			

MATERIAL NO.	DOCUMENT NO.	SHEET NO.
SEE CHART	SD-120336-002	1 OF 1
THIS DRAWING CONTAINS INFORMATION THAT IS PROPRIETARY TO MOLEX INCORPORATED AND SHOULD NOT BE USED WITHOUT WRITTEN PERMISSION		