

REVISIONS			
LTR	DESCRIPTION	DATE	APPROVED
B		5-18-83	<i>DR. REE</i>
C	CHANGED -13 NYLON, 30% GLASS FILLED WAS -13 NYLON, 35% GLASS FILLED	12/13/83	<i>93</i>

SPLIT NUT
TYPE C

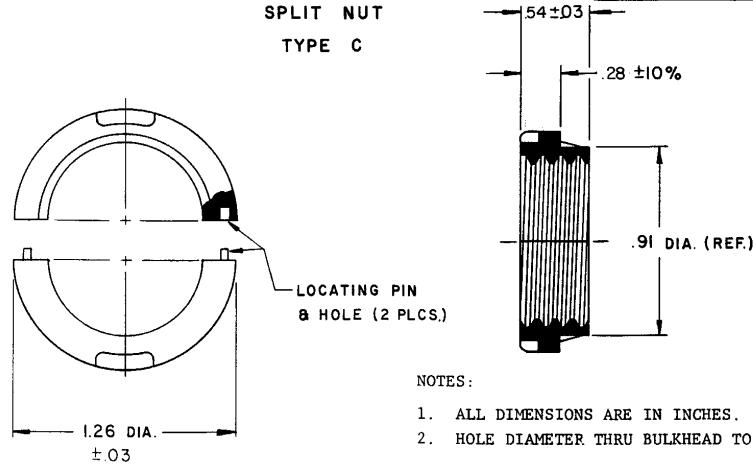

NOTES:

1. ALL DIMENSIONS ARE IN INCHES.
2. HOLE DIAMETER THRU BULKHEAD TO BE .94 ± .02

ORDERING INFORMATION:

BASE PART NUMBER 207A412 -13

FEEDTHROUGH MATERIAL -13 NYLON, 30% GLASS FILLED

If this document is printed it becomes uncontrolled.
Check for the latest revision.

SPECIFICATION CONTROL DRAWING (LIMITED DISTRIBUTION)

THIS DRAWING AND THE INFORMATION SET FORTH HEREON ARE THE PROPERTY OF RAYCHEM CORPORATION, AND ARE TO BE HELD IN TRUST AND CONFIDENCE. PUBLICATION, DUPLICATION, DISCLOSURE, OR USE FOR ANY PURPOSE NOT EXPRESSLY AUTHORIZED IN WRITING BY RAYCHEM CORPORATION IS PROHIBITED.	DRAWN	C. WARREN 11/2/82	Raychem RAYCHEM CORPORATION 300 CONSTITUTION DRIVE MENLO PARK, CALIFORNIA 94025	
	CHECKED	<i>S. J. ...</i> 11-2-82		
	DEGN APPD		TITLE	SPLIT NUT-TYPE C
	MFG APPD	<i>B. ...</i> 11/8/82	CODE IDENT.	NO. 06080
	OC APPD	<i>D. Hay</i> 11-8-82	DWG. NO.	207A412-13
MKTG APPD	<i>J. HOFFMAN</i> 11/8/82	SIZE B	SCALE	
TECH SER	<i>RELIANA</i> 11/8/82	PROJECT	SHEET OF	
DO NOT SCALE THIS DRAWING				