



Mn-Zn

# Large Size Ferrite Cores for High Power

# T series

---

**REMINDERS FOR USING THESE PRODUCTS**

Please be sure to read this manual thoroughly before using the products.

The products listed on this catalog are intended for use in general electronic equipment (AV equipment, telecommunications equipment, home appliances, amusement equipment, computer equipment, personal equipment, office equipment, measurement equipment, industrial robots) under a normal operation and use condition.

The products are not designed or warranted to meet the requirements of the applications listed below, whose performance and/or quality require a more stringent level of safety or reliability, or whose failure, malfunction or trouble could cause serious damage to society, person or property.

When using the products for specific purposes, please first make confirmations in areas such as safety, reliability, and quality.

Please understand that we are not in a position to be held responsible for any damage or the like caused by any use exceeding the range or conditions of this specification sheet or by any use in the specific applications.

- |                                                             |                                                                              |
|-------------------------------------------------------------|------------------------------------------------------------------------------|
| (1) Aerospace/Aviation equipment                            | (8) Public information-processing equipment                                  |
| (2) Transportation equipment (electric trains, ships, etc.) | (9) Military equipment                                                       |
| (3) Medical equipment                                       | (10) Electric heating apparatus, burning equipment                           |
| (4) Power-generation control equipment                      | (11) Disaster prevention/crime prevention equipment                          |
| (5) Atomic energy-related equipment                         | (12) Safety equipment                                                        |
| (6) Seabed equipment                                        | (13) Other applications that are not considered general-purpose applications |
| (7) Transportation control equipment                        |                                                                              |

When using this product in general-purpose standard applications, you are kindly requested to take into consideration securing protection circuit/equipment or providing backup circuits, etc to ensure higher safety.

# Large Size Ferrite Cores for High Power

Product compatible with RoHS directive  
Halogen-free

## Overview of the T Series

### FEATURES

- Large size cores for transformers with large power outputs.
- Can also be used in reactors.

### APPLICATION

- Large size industrial equipment, transformers for consumer equipment
- Reactors

### PART NUMBER CONSTRUCTION

PE22	T	51	×	13	×	31
Material	Core shape	Outside Diameter		Thickness		Inside Diameter
PE22	T	51		13		31
PC40		62		20		39
		72				48
		80				50
		96				70
		104				80

### RANGE OF USE AND STORAGE TEMPERATURE

Temperature range	
Operating temperature (°C)	Storage temperature (°C)
−30 to +105	−30 to +85

○ RoHS Directive Compliant Product: See the following for more details. <https://product.tdk.com/info/en/environment/rohs/index.html>

○ Halogen-free: Indicates that Cl content is less than 900ppm, Br content is less than 900ppm, and that the total Cl and Br content is less than 1500ppm.

 Please be sure to request delivery specifications that provide further details on the features and specifications of the products for proper and safe use.  
Please note that the contents may change without any prior notice due to reasons such as upgrading.

## Mn-Zn系 T Cores

## SHAPES AND DIMENSIONS

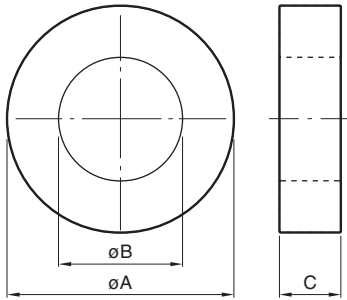

PE22	T	51	×	13	×	31
Material	Core shape	Outside Diameter		Thickness		Inside Diameter

Part No.	Dimensions			Effective parameter						Electrical characteristics
	øA	øB	C	Core factor		Effective cross-sectional area	Effective magnetic path length	Effective core volume	Weigh	AL-value
	(mm)			C <sub>1</sub> (mm <sup>-1</sup> )	C <sub>2</sub> ×10 <sup>-2</sup> (mm <sup>-3</sup> )	A <sub>e</sub> (mm <sup>2</sup> )	ℓ <sub>e</sub> (mm)	V <sub>e</sub> (mm <sup>3</sup> )	(g)	(nH/N <sup>2</sup> ) 1kHz 0.4A/m 23°C
PE22 T51×13×31 PC40 T51×13×31	51.0±1.0	31.0±0.6	13.0±0.5	0.97084	0.76235	127	124	15740	80 80	2330±25% 2980±25%
PE22 T62×13×39 PC40 T62×13×39	62.5±1.2	39.0±0.8	13.5±0.5	0.98689	0.63377	156	154	23930	121 121	2290±25% 2930±25%
PE22 T72×20×48 PC40 T72×20×48	72.0±1.5	48.0±0.9	20.0±0.5	0.77481	0.32729	237	183	43420	217 217	2920±25% 3730±25%
PE22 T80×20×50 PC40 T80×20×50	80.0±1.6	50.0±1.0	20.0±0.5	0.66842	0.22694	295	197	57990	294 294	3380±25% 4320±25%
PE22 T96×20×70 PC40 T96×20×70	96.0±1.9	70.0±1.4	20.0 ±0.5	0.99464	0.38574	258	256	66130	325 325	2270±25% 2910±25%
PE22 T104×20×80 PC40 T104×20×80	104.0±2.1	80.0±1.6	20.0±0.5	1.19742	0.50179	239	286	68180	333 333	1890±25% 2410±25%