

THIS DOCUMENT IS THE PROPERTY OF KEYSTONE ELECTRONICS CORP. AND SHALL NOT BE REPRODUCED, DISTRIBUTED OR USED AS A BASIS FOR MANUFACTURE WITHOUT PRIOR WRITTEN PERMISSION FROM KEYSTONE ELECTRONICS CORP.

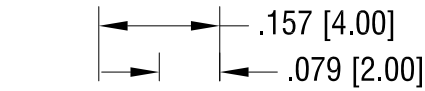

ACTUAL SIZE

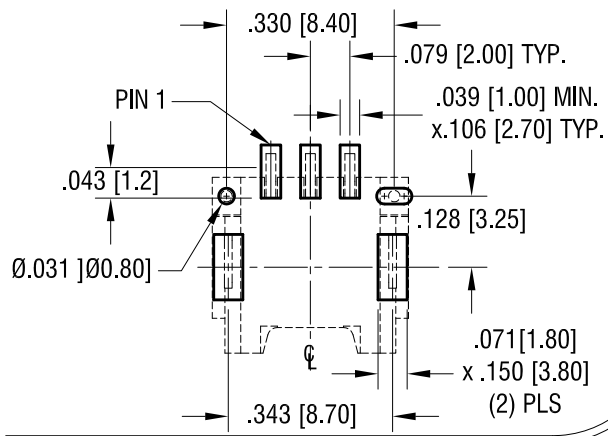
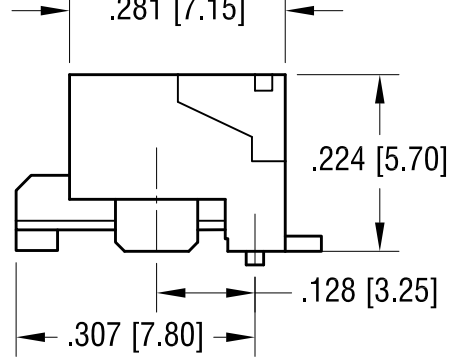
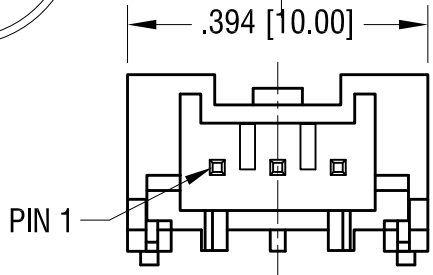
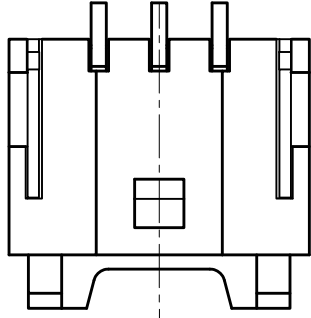
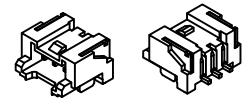

NOTE:

1. INSULATION: MAT'L- PA66, UL94V-0
2. POST: MAT'L- COPPER ALLOY TIN PLATED
3. WAFER: MAT'L- GLASS FILLED PBT, UL94V-0 COLOR- NATURAL

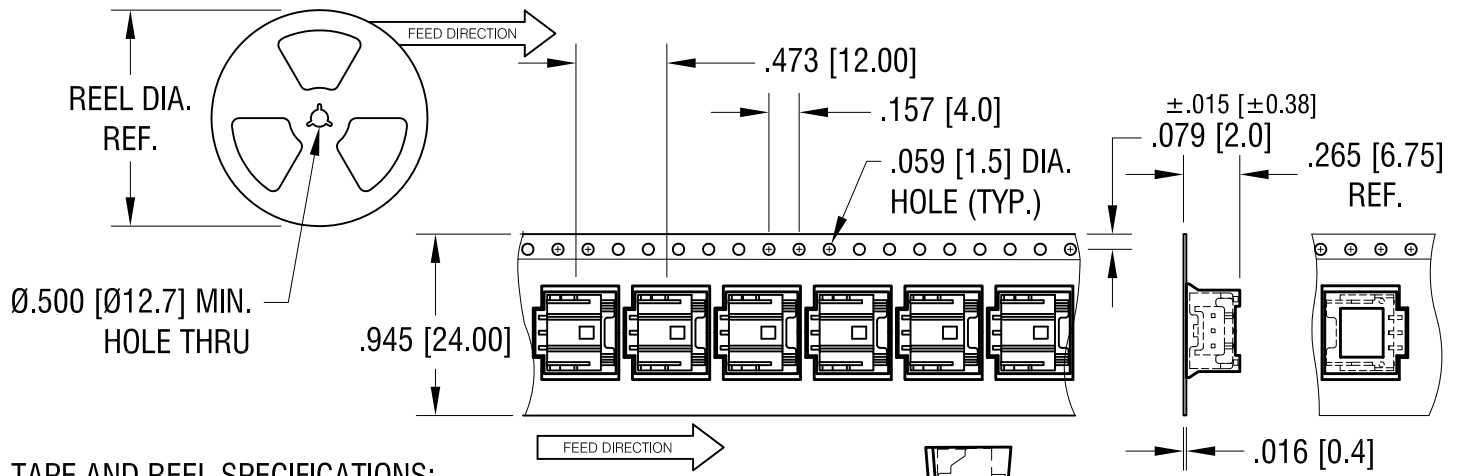

TAPE AND REEL SPECIFICATIONS:

4. TAPE: MAT'L - ALL CONDUCTIVE POLYSTYRENE CARRIER ANSI/EIA-481 STANDARD
5. REEL: 15.0 [380.8] DIA. 1000 PIECES PER REEL

KEYSTONE ELECTRONICS CORP.			
www.keyelco.com • NEW HYDE PARK, NY 11040 • Tel (516) 328-7500			
PART NAME			
SM SIDE ENTRY CONNECTOR (3 CIRCUITS)			
MATERIAL			
AS NOTED			
FINISH		DRN BY	DATE
AS NOTED		NT	3.07.16
		APP'D	SCALE
		LN	4X
TOLERANCES	INCH [MM]	CODE	DWG NO.
DECIMAL	± .005 [± 0.13]	C	976
ANGULAR	± 1°		
UNLESS OTHERWISE SPECIFIED			

DATE	DESCRIPTION	REV.	
------	-------------	------	--