

NOTE:

1. ELECTRIC PERFORMANCE
- IMPEDANCE ( $\Omega$ )

FREQUENCY RANGE

VSWR

INSERT LOSS (dBc)

PIM(dBc)

INSULATION RESISTANCE ( $M\Omega$ )

PROOF VOLTAGE (V)

CONDUCTOR RESISTANCE ( $m\Omega$ )
- : 50

: DC-6GHz

:  $\leq 1.065$  (DC-3GHz)

:  $\leq 1.2$  (3-6GHz)

:  $\leq 0.1$

:  $\leq -160$  (2X43dBm)

: >5000

: 2500

: OUTER CONDUCTOR <0.4

: INNER CONDUCTOR <0.8

- II. MECHANICAL PERFORMANCE
- NUT TORQUE 7/16

MECHANICAL WEAR
- : >25Nm

: 500

- III. MATERIAL AND PLATING
- INNER CONDUCTOR

OUTER CONDUCTOR

NUT

INSULATOR
- : SPRING COPPER PLATING Ag5  $\mu$ m

: BRASS PLATING COPPER-TIN-ZINC 2  $\mu$ m

: BRASS PLATING Ni5

: PTFE

- IV. ENVIRONMENT
- TEMP RANGE

WATERPROOF STANDARD

ROHS COMPLIANT
- : -55 °C TO +155 °C

: IP67

242136

DRAWING NO.

THIRD ANGLE PROJ.



REVISIONS

REV

DESCRIPTION

DATE

ECO

APPR

A

RELEASE TO MFG.

07-Sep-09

--

B

BOM UPDATED

03-Sep-10

2093

C

ADDED NOTES, ISOMETRIC VIEW &  
LOW PIM ADDED IN DESCRIPTION

01-Oct-12

2389

RAK

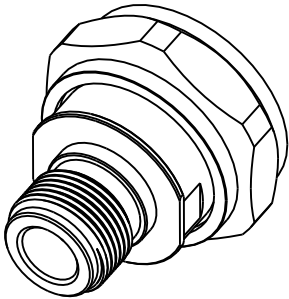

SCALE 1.000

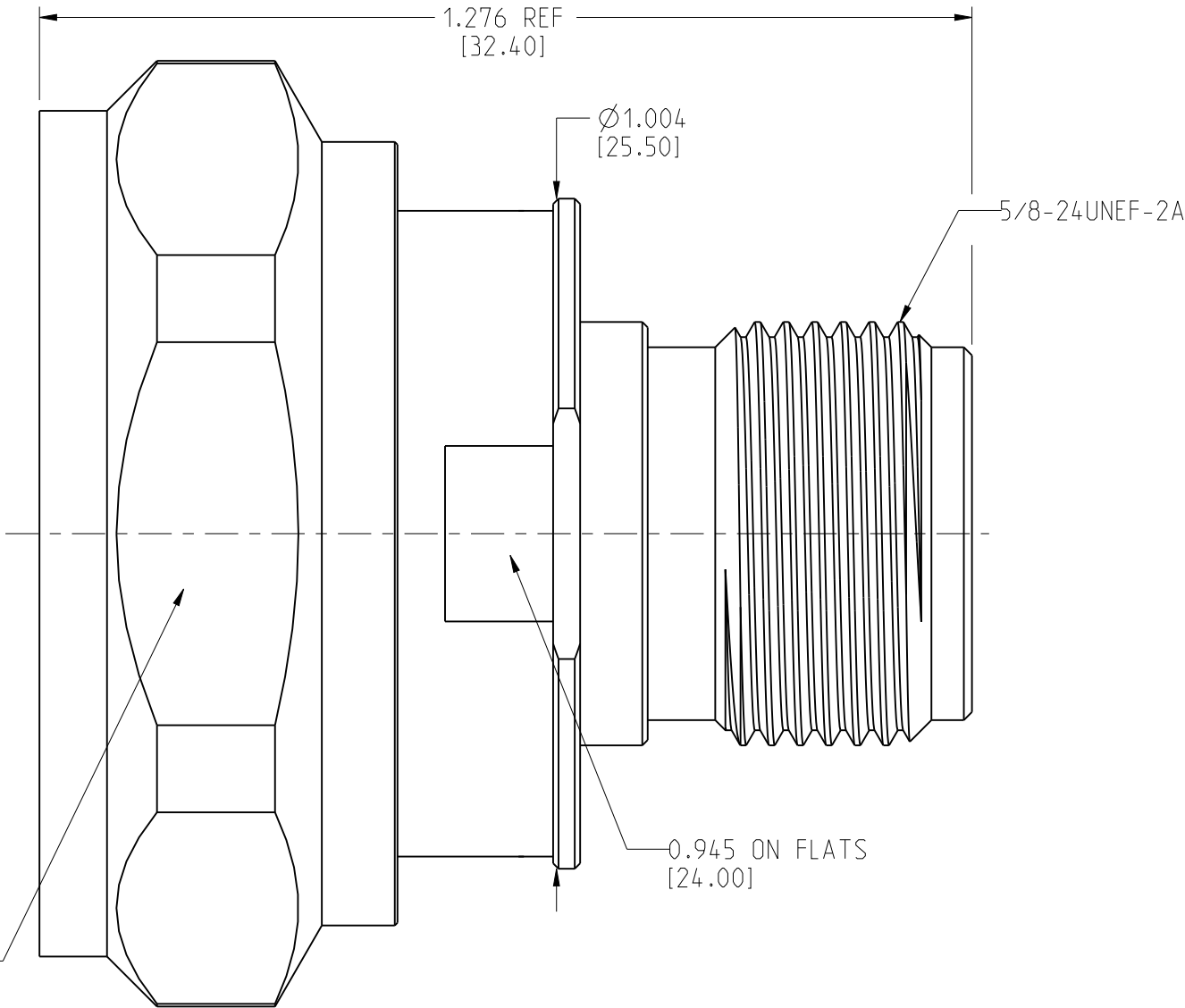

4	INNER CONDUCTOR	SPRING COPPER	SILVER	1
3	INSULATOR	PTFE	NATURAL	1
2	OUTER CONDUCTOR	BRASS	WHITE BRONZE	1
1	NUT	BRASS	NICKEL	1
NO	DESCRIPTION	MATERIAL	FINISH	QTY

UNLESS OTHERWISE SPECIFIED, DIMENSIONS ARE IN INCHES AND TOLERANCES ARE:  
2 PLACE DECIMAL 3 PLACE DECIMAL ANGLES  
 $\pm .015$  (0,381 mm)  $\pm .005$  (0,127 mm)  $\pm 1^\circ$

NOTICE - These drawings, specifications, or other data (1) are, and remain the property of Amphenol Corp. (2) must be returned upon request; and (3) are confidential and not to be disclosed to any person other than those to whom they are given by Amphenol Corp. The furnishing of these drawings, specifications, or other data by Amphenol Corp., or to any other person to anyone for any purpose is not to be regarded by implication or otherwise in any manner licensing, granting rights or permitting such holder or any other person to manufacture, use or sell any product, process or design, patented or otherwise, that may in any way be related to or disclosed by said drawings, specifications, or other data.

MATERIAL

SEE NOTES

REFERENCE

DRAWN

ABHAYA KISHORE

ENGINEER

ABHAYA KISHORE

APPROVED

CAD FILE

DATE

01-Oct-12

DATE

01-Oct-12

DATE

TITLE

7/16 MALE TO N FEMALE  
ADAPTER, LOW PIM.

Amphenol  
Connex

SCALE: 4.0:1

SHEET 1 OF 1

DWG SIZE

B

DRAWING NO.

242136

REV

C