



KPPX/KPJX Series
Snap and Lock PCB and Cable Mount

Features 

- Laptop Computers, Power Supplies and Other Portable Digital Equipment Applications
- Snap and Lock Feature Helps to Prevent Accidental Disconnects
- 3 or 4 Pins Transmit Power, or One Pin Can be Used For Signal Transmission
- For Signal and DC Power Applications
- Plugs Supplied in Kits Ready for Assembly
- CSA/NRTL Certified File No. LR78160

Performance Specifications

Materials and Finish

- Jack**
- Shield:** Tin Plated
- Body:** PBT UL94 V-0 Rated
- HT Body:** High Temperature Thermoplastic, UL94 V-0 Rated
- Plug**
- Body:** ABS, UL 94HB Rated
- Insert:** Nylon, UL 94HB Rated

Electrical Characteristics

- Contact Rating**
- 3 Position:** Pin 1 and 2, 24V DC at 7.5A Max., Pin 3, 24V DC 1.0A Max.
- 4 Position:** 24V DC 7.5A Max. for all Pins
- Insulation Resistance:** 50 Megohms Min. at 250V DC
- Dielectric Withstanding Voltage:** 500V AC for 1 Minute
- Contact Resistance:** 30 milliohms Max.

Mechanical Characteristics

- Durability Test:** 1000 Cycles
- Suggested Wire Awg.:** #18 for Power Wires, #24 for Signal Wire

DC POWER CONNECTORS
KPJX / KPPX Series

Ordering Information

Series	Mounting Option	No of Contacts	Contact Type	Shield Option
Series				
KPJX - Right Angle Receptacle				
KPJX-CM - Receptacle, Cable Mount				
KPJX-PM - Receptacle, Panel Mount				
KPJXHT - High Temp Right Angle Receptacle				
KPPX - Snap and Lock DC Power Plug Cable Mount				
Number of Contacts				
3 Pin				
4 Pin				
Contact Type				
S - Socket (KPJX Only)				
P - Plug (KPPX Only)				
Shield Option				
Blank - Non-Shielded				
S - Shielded (KPJX, KPJX-PM and KPJXHT only)				

KPJX-3S

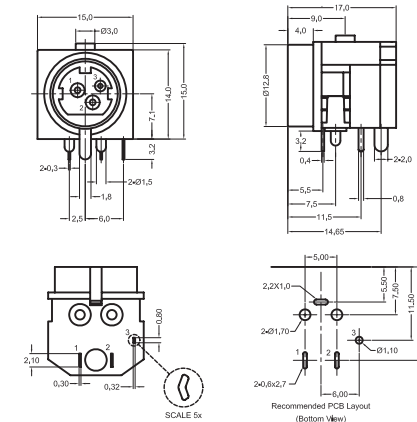

KPPX-xP

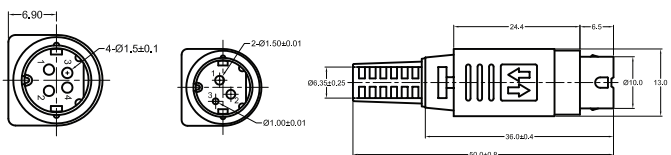

KPJX-CM-xS

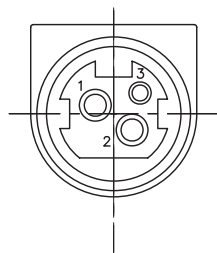

3 PIN CONFIGURATION

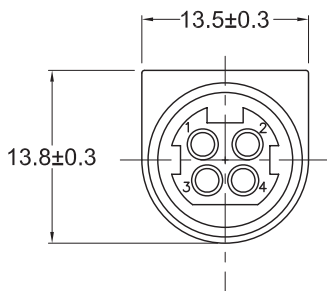

4 PIN CONFIGURATION

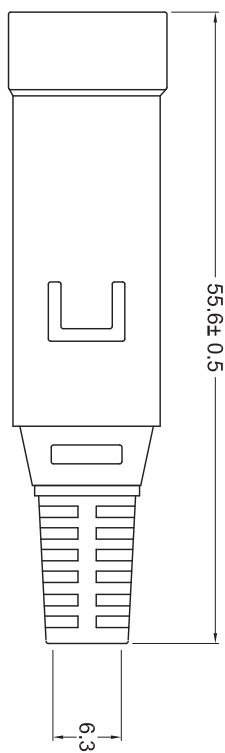

KPJX-PM-3S

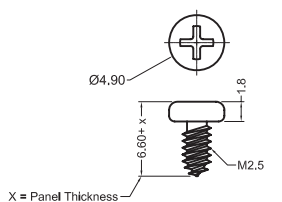
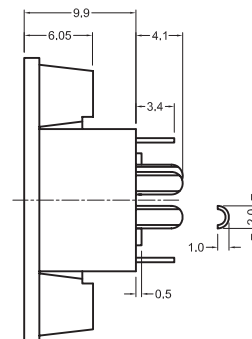
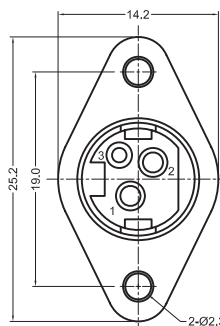

Recommended Mounting Screw

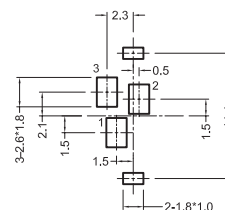

Recommended PCB Layout

KPJX-PM-4S

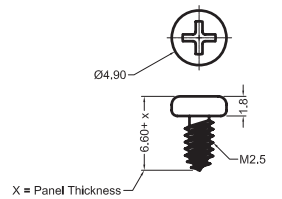
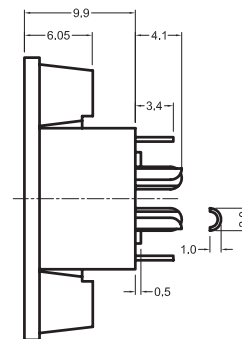
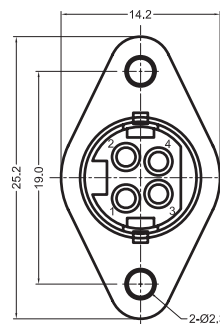

Recommended Mounting Screw

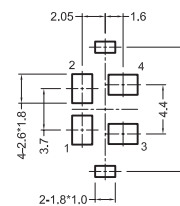

Recommended PCB Layout