

REV.	DATE	DESCRIPTION
NC	12/16/01	INITIAL RELEASE
A	07/24/05	UPDATE DRAWING FORMAT

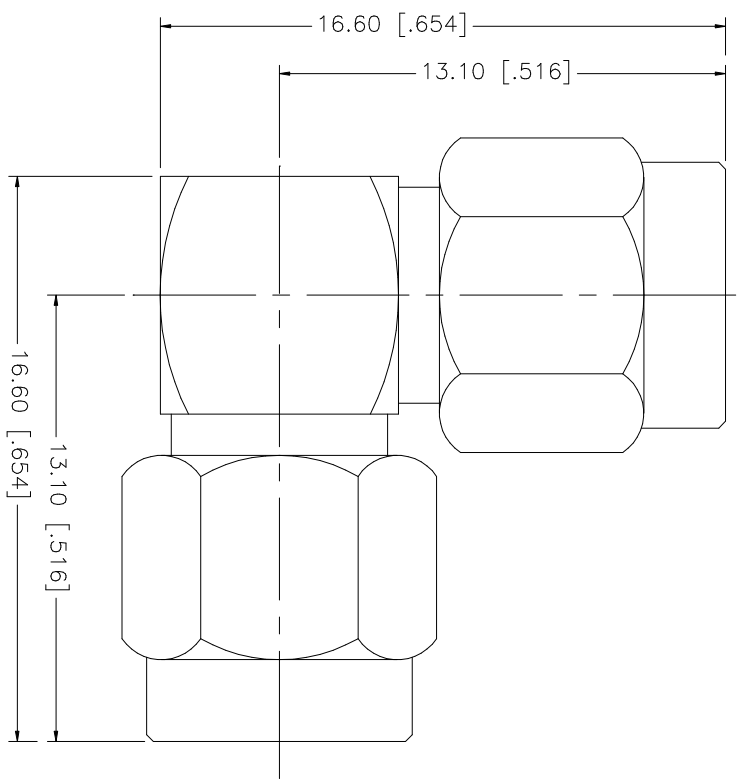

8						<p>UNLESS OTHERWISE SPECIFIED DIMENSIONS ARE INCHES AND FOR CUSTOMER REFERENCE ONLY.</p> <p>UNLESS OTHERWISE SPECIFIED TOLERANCES FOR MILLIMETERS ARE:</p> <p>0.3 - 8mm ± 0.20mm 8 - 30mm ± 0.40mm 30 - 120mm ± 0.50mm</p> <p>UNLESS OTHERWISE SPECIFIED TOLERANCES FOR INCHES ARE:</p> <p>.020 - .315 = ± 0.007" .315 - 1.180 = ± 0.015" 1.180 - 4.724 = ± 0.020"</p> <p>DO NOT SCALE DRAWING</p>
7						
6						
5						
4						
3	CONTACT PIN	BER, COPPER	GOLD	1		
2	INSULATOR	TEFLON	NATURAL	1		
1	BODY	BRASS	GOLD	1		
	DESCRIPTION	MATERIAL	FINISH	QTY		
APPROVALS		DATE				
DRAWN G.R.S.		07/24/05				
CHECKED						
ISSUED						
SHEET 1 OF 1						
CAD FILE C:/132/132339.DWG						
DWG. NO. 132339.DWG		REV. A	SIZE A	SCALE NA		
<p style="text-align: center;">Amphenol Connex</p> <p style="text-align: center;">PART DESCRIPTION SMA R/A PLUG-PLUG ADAPTER</p>						
PART NO.		132339				