

NOTES:

- 1. MATERIALS AND FINISHES:  
 HD-BNC STR CRIMP PLUG - 34-1017-300  
 CABLE - BELDEN 1694A
- 2. ELECTRICAL:  
 A. IMPEDANCE: 75 OHM

- 3. PACKAGING:  
 A. QUANTITY: SINGLE PACK  
 B. MARKING: BAG TO BE MARKED  
 "AMPHENOL RF, 95-850-160XXXX, AND DATE CODE"

THIRD ANGLE PROJ.

REVISIONS

| REV | DESCRIPTION    | DATE    | ECO   | APPR   |
|-----|----------------|---------|-------|--------|
| A   | RELEASE TO MFG | 5/15/15 | 50370 | NR/BCG |
| B   | HST REMOVED    | 6/30/15 | 50581 | NR/BCG |

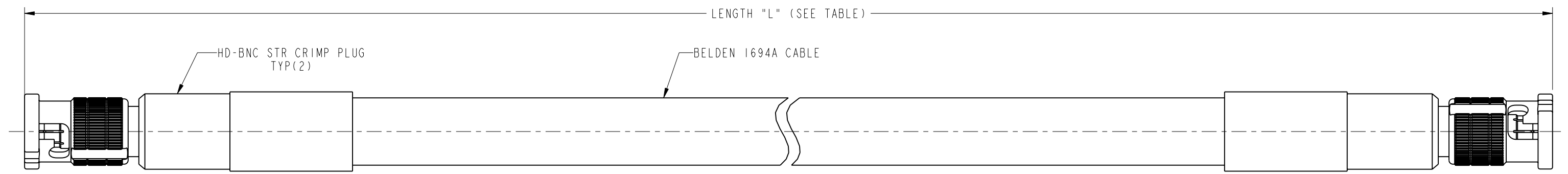

| LENGTH TABLE           |                      |                               |
|------------------------|----------------------|-------------------------------|
| PART NUMBER (IMPERIAL) | PART NUMBER (METRIC) | LENGTH "L" IN INCHES [METERS] |
| 95-850-160-006         | -                    | 6.00 [0.152]                  |
|                        | 95-850-160M025       | 9.84 [0.250]                  |
| 95-850-160-012         | -                    | 12.00 [0.305]                 |
| 95-850-160-018         | -                    | 18.00 [0.457]                 |
|                        | 95-850-160M050       | 19.69 [0.500]                 |
| 95-850-160-024         | -                    | 24.00 [0.610]                 |
|                        | 95-850-160M075       | 29.53 [0.750]                 |
| 95-850-160-036         | -                    | 36.00 [0.914]                 |
|                        | 95-850-160M100       | 39.37 [1.000]                 |
| 95-850-160-048         | -                    | 48.00 [1.219]                 |
|                        | 95-850-160M125       | 49.21 [1.250]                 |
|                        | 95-850-160M150       | 59.06 [1.500]                 |
| 95-850-160-060         | -                    | 60.00 [1.524]                 |
| 95-850-160-072         | -                    | 72.00 [1.829]                 |
|                        | 95-850-160M200       | 78.74 [2.000]                 |
|                        | 95-850-160M300       | 118.11 [3.000]                |
| 95-850-160-120         | -                    | 120.00 [3.048]                |
| 95-850-160-180         | -                    | 180.00 [4.572]                |
|                        | 95-850-160M500       | 196.85 [5.000]                |
| 95-850-160-300         | -                    | 300.00 [7.620]                |
|                        | 95-850-160M10L       | 393.70 [10.000]               |
| 95-850-160L050         | -                    | 600.00 [15.240]               |
|                        | 95-850-160M20L       | 787.40 [20.000]               |
| 95-850-160L075         | -                    | 900.00 [22.860]               |
|                        | 95-850-160M30L       | 1181.10 [30.000]              |
| 95-850-160L100         | -                    | 1200.00 [30.480]              |

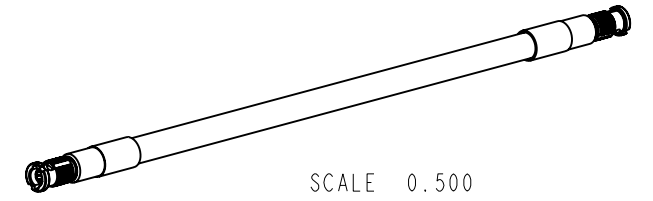

**DESIGN REQUIREMENTS:**

|                                                           |                                                       |
|-----------------------------------------------------------|-------------------------------------------------------|
| <input checked="" type="checkbox"/> FREQUENCY DC TO 3 GHz | <input checked="" type="checkbox"/> CONTINUITY        |
| <input type="checkbox"/> VSWR: ----- MAX                  | <input checked="" type="checkbox"/> HI-POT : 500 VRMS |
| <input type="checkbox"/> INS. LOSS ----- dB MIN           | <input type="checkbox"/> OTHER                        |

**CUSTOMER OUTLINE DRAWING**  
 ALL OTHER SHEETS ARE FOR INTERNAL USE ONLY

|                                                                                                                                                                                                                                                                                                                                                                                                                                                                                                                                                                                                                                                                                                                                       |                               |           |           |                                                                                                   |                                   |
|---------------------------------------------------------------------------------------------------------------------------------------------------------------------------------------------------------------------------------------------------------------------------------------------------------------------------------------------------------------------------------------------------------------------------------------------------------------------------------------------------------------------------------------------------------------------------------------------------------------------------------------------------------------------------------------------------------------------------------------|-------------------------------|-----------|-----------|---------------------------------------------------------------------------------------------------|-----------------------------------|
| UNLESS OTHERWISE SPECIFIED, DIMENSIONS ARE IN INCHES AND TOLERANCES ARE:<br>2 PLACE DECIMAL 3 PLACE DECIMAL ANGLES<br>±.015 (0.381 mm) ±.005 (0.127 mm) ± 1°                                                                                                                                                                                                                                                                                                                                                                                                                                                                                                                                                                          | MATERIAL                      | DRAWN     | DATE      | TITLE                                                                                             | Amphenol RF<br>www.amphenolrf.com |
|                                                                                                                                                                                                                                                                                                                                                                                                                                                                                                                                                                                                                                                                                                                                       | SEE NOTES                     | STAMM     | 18-Nov-16 | HD-BNC STR CRIMP PLUG TO<br>HD-BNC STR CRIMP PLUG,<br>USING BELDEN 1694A CABLE,<br>VARIOUS LENGTH |                                   |
| NOTICE - These drawings, specifications, or other data (1) are, and remain the property of Amphenol corp. (2) must be returned upon request; and (3) are confidential and not to be disclosed to any person other than those to whom they are given by Amphenol Corp. the furnishing of these drawings, specifications, or other data by Amphenol Corp., or to any other person to anyone for any purpose is not to be regarded by implication or otherwise in any manner licensing, granting rights to permitting such holder or any other person to manufacture, use or sell any product, process or design, patented or otherwise, that may in any way be related to or disclosed by said drawings, specifications, or other data. | REFERENCE                     | ENGINEER  | DATE      | SCALE: 2.5:1.0 SHEET 2 OF 2                                                                       | DRAWING NO.95-850-160XXXX         |
|                                                                                                                                                                                                                                                                                                                                                                                                                                                                                                                                                                                                                                                                                                                                       | EAR # 6513                    | KARTHIK R | 09-Dec-14 |                                                                                                   | ITEM NO.95-850-160XXXX            |
|                                                                                                                                                                                                                                                                                                                                                                                                                                                                                                                                                                                                                                                                                                                                       | CONFIGURATION LEVEL: Released | APPROVED  |           | DATE                                                                                              | DWG SIZE                          |
| FINISH                                                                                                                                                                                                                                                                                                                                                                                                                                                                                                                                                                                                                                                                                                                                |                               | RICKSON   | 18-Nov-16 | B                                                                                                 |                                   |
|                                                                                                                                                                                                                                                                                                                                                                                                                                                                                                                                                                                                                                                                                                                                       |                               | CAD FILE  |           | REV                                                                                               |                                   |
|                                                                                                                                                                                                                                                                                                                                                                                                                                                                                                                                                                                                                                                                                                                                       |                               |           |           | B                                                                                                 |                                   |