

2 W

DC- 8 GHz

SMC

COAXIAL ATTENUATOR

issue
15. jul. 93

Page
1 / 1

DRAWING

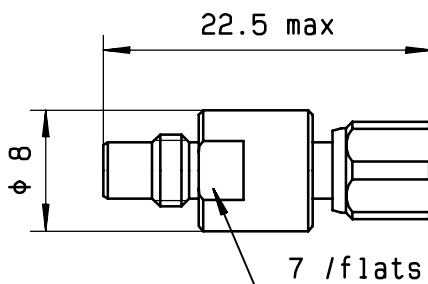

General tolerances: +/- 0.5 mm

R F CHARACTERISTICS

FREQUENCY RANGE : DC - 8 GHz
 IMPEDANCE : 50 Ohms
 ATTENUATION - NOMINAL : 10 dB

FREQUENCY	DC- 4 GHz	4 - 8 GHz
V.S.W.R	<= 1.15	<= 1.30
DEVIATION (dB)	+0.4 / - 0.4	+0.5 / - 0.5

TEMPERATURE SENSITIVITY : $4 \times 10^{-4} \frac{\text{dB}}{\text{dB} \times ^\circ\text{C}}$
 PEAK POWER at 25°C (1µs, 1%.) : 100 W
 AVERAGE POWER at 25°C : 2 W

MECHANICAL CHARACTERISTICS

CONNECTORS : SMC male/female per MIL-C 39012
 WEIGHT : < 5 g

ENVIRONMENTAL CHARACTERISTICS

OPERATING TEMPERATURE RANGE (°C) : -55 , +125
 STORAGE TEMPERATURE RANGE (°C) : -55 , +125

Power derating
Versus temperature

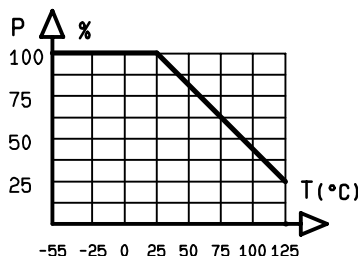

This information is given as an indication. In the continual goal to improve our products, we reserve the right to make any modifications judged necessary

QUALITY Dpt app. _____			
CREATION PEN : CAT			
EP : -----			
Nom : KL	15. jul. 93	New issue	HS
Date: 13. apr. 90	ISSUE	REVISIONS	NAME

4112-9211