

THIS COPY IS PROVIDED ON A RESTRICTED BASIS AND IS NOT TO BE USED IN ANY WAY DETRIMENTAL TO THE INTERESTS OF PANDUIT CORP.

NO WARRANTY, EXPRESSED OR IMPLIED, IS MADE BY PANDUIT WITH RESPECT TO ADHESIVE BOND PERFORMANCE. AMONG OTHER THINGS, THE CONDITIONS UNDER WHICH THESE MOUNTS MAY BE APPLIED AND/OR THE SURFACE TO WHICH THEY MAY BE APPLIED ARE BEYOND PANDUIT'S CONTROL.

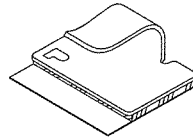
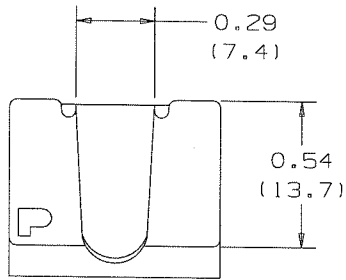

ACTUAL SIZE

PANDUIT * PART NO.	ADHESIVE BACKING	MAX. BUNDLE DIAMETER inches (mm)	WEIGHT lb(g)/100 pcs.
MACC25-A	RUBBER	0.25 (6.3)	0.40 (178)
MACC25-AV	HIGH BOND ACRYLIC		

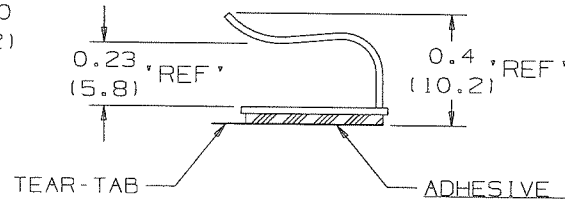
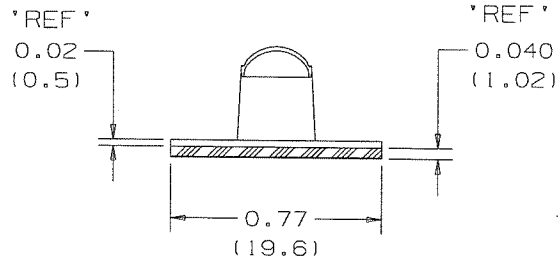

ADHESIVE BACKING  
PRESSURE SENSITIVE FOAM TAPE 0.040 (1.02) THICK WITH RUBBER ADHESIVE AND PROTECTIVE LINER. MOUNT IS DESIGNED TO SUPPORT 0.21 lb. (95.3g) MAXIMUM WEIGHT ON A CLEAN, DRY, SMOOTH, GREASE-FREE SURFACE.

NOTES:

- \* 1) SEE CURRENT PRICE SHEET FOR PART NUMBER SUFFIX DESIGNATION AND PACKAGE SIZE.
- 2) TO APPLY MOUNT: a) REMOVE PROTECTIVE LINER, b) PLACE IN DESIRED LOCATION, c) APPLY PRESSURE TO MOUNT.
- 3) MATERIAL:  
G-90 PRE-GALVANIZED COMMERCIAL GRADE LOW CARBON STEEL -- PER ASTM A 653 STEEL SHEET, ZINC COATED (GALVANIZED) BY THE HOT DIP PROCESS.

(DIMENSIONS IN PARENTHESES ARE IN METRIC.)

CAD FILENAME/LAYERS G03597GV\_DC\_GB0239HH/00B

**PANDUIT** CORP. TINLEY PARK, ILLINOIS

MACC25-A & MACC25-AV  
METAL ADHESIVE CORD CLIP

REV	DATE	BY	CHK	DESCRIPTION	ECN	R	CUST	SUP	UNLESS OTHERWISE SPECIFIED, DIMENSIONAL TOLERANCES ARE: (.X) ±0.1(2.5) (.XXX) ±0.020(1.5) (.XX) ±0.05(1.3) ANGLES ±5°	UNLESS OTHERWISE SPECIFIED, ALL DIMENSIONS ARE GIVEN IN INCHES, THIRD ANGLE PROJECTION.
00B	11-6-09	TMSA	SMY	ADDED PART NUMBER MACC25-AV REVISED TO TEAMCENTER NAMING CONVENTION	GB0239HH	00B	KLN		DRAWN BY LGG DATE 6/07/01 CHK'D KLN	SCALE NOT TO SCALE
2	2/19/03	JAD		REVISED MATERIAL CALLOUT, ADDED NOTE 3	GB0239HH	2				
1	5/10/02	LGG		CHG TAPE NOTE FOR SUPPORT. WAS .19(98g).	GB0239HH	1		DATE 6/07/01 CHK'D KLN	SEE NOTE 3	DRAWING NO. GB0239HH DWG A SIZE
R	6/07/01	LGG		REPLACING ORGINAL SS-20007	GB0239HH	R				
REV	DATE	BY	CHK	DESCRIPTION	ECN	R	CUST	SUP		