

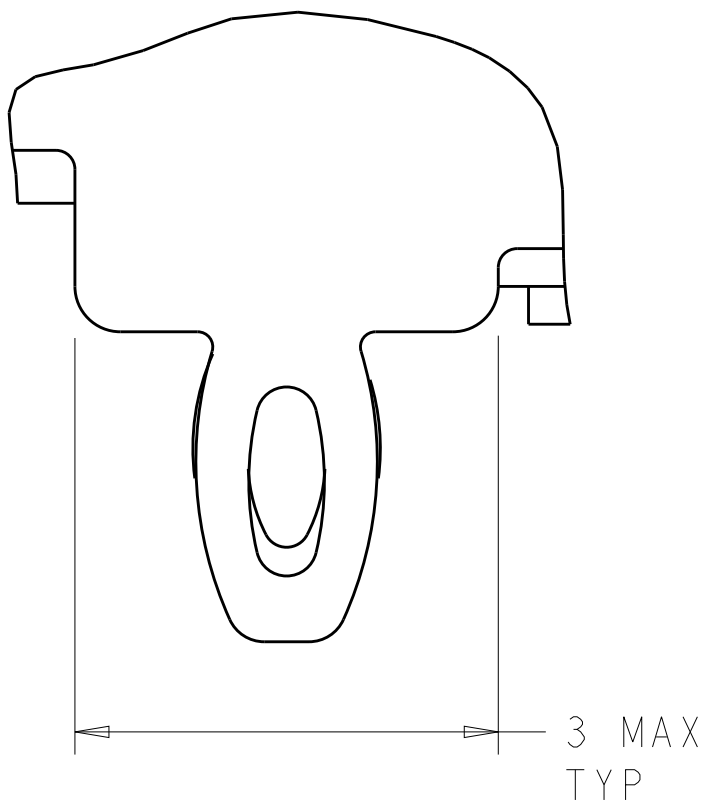













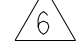

LOC	DIST	REVISIONS						
		P	LTR	DESCRIPTION	DATE	DWN	APVD	
GP	00		C	REVISED PER ECO-10-018054	02NOV2010	CJV	EJB	
			D	REVISED PER ECO-12-005533	23MAR2012	JY	AC	
			E	REVISED PER ECO-14-012115	6AUG2014	RG	MC	
			F	REVISED PER ECO-14-017735	30EC2014	RG	MC	



DETAIL S 
SCALE 20:1

-  MATERIALS:
CAGE ASSEMBLY: NICKEL SILVER, 0.25 THICK
EMI SPRINGS: COPPER ALLOY
FRONT FLANGE: ZINC ALLOY
HEAT SINK: ALUMINUM
HEAT SINK CLIP: STAINLESS STEEL
-  PITCH BETWEEN PORTS OF ONE 1X3 CAGE ASSEMBLY.
-  SPACING BETWEEN CAGES ON THE SAME PC BOARD, TO BE SPECIFIED BY CUSTOMER, MUST COMPLY WITH MINIMUM DIMENSIONS SHOWN.
-  REFERENCE APPLICATION SPEC 114-13218 FOR RECOMMENDED DRILL HOLE DIAMETER AND PLATING THICKNESS.
-  DATUMS AND BASIC DIMENSIONS ESTABLISHED BY CUSTOMER.
-  DIMENSION C IS THE NOMINAL THICKNESS OF CUSTOMER SUPPLIED PC BOARD.
MINIMUM SINGLE SIDED PC BOARD THICKNESS: 1.45mm
MINIMUM DOUBLE SIDED PC BOARD THICKNESS: 2.2mm PER QSFP
-  HEAT SINKS AND CLIPS SHIPPED ASSEMBLED TO CAGE ASSEMBLY. CAGE ASSEMBLY MAY BE PRESSED INTO THE PCB AS SHIPPED.
-  DATUM  IS TOP SURFACE OF PC BOARD.
-  DIMENSION APPLIES WITH MODULE INSERTED IN CAGE.
-  UNPLATED THRU HOLE.

11. MATES WITH QSFP MSA COMPATIBLE TRANSCEIVER.
-  SURFACE TRACES PERMITTED WITHIN THIS AREA EXCEPT WHERE CAGE STANDOFFS, SHOWN IN DETAIL S, CONTACT PC BOARD.

-  BASELINE FOR THESE DIMENSIONS IS THE CENTER OF COMPLIANT PIN HOLE.
-  2D BARCODE AND DATE CODE (YYWW) MARKED ON SIDE OF CAGE.
-  REFERENCE APP SPEC 114-13218 FOR GASKET THICKNESS CALCULATION.
-  FINISH:
EMI SPRINGS: 2µm MINIMUM TIN
FRONT FLANGE: 3µm MINIMUM TIN OVER 1.27µm MINIMUM NICKEL
OVER 5.08µm MINIMUM COPPER
HEAT SINK: ANODIZED BLACK.

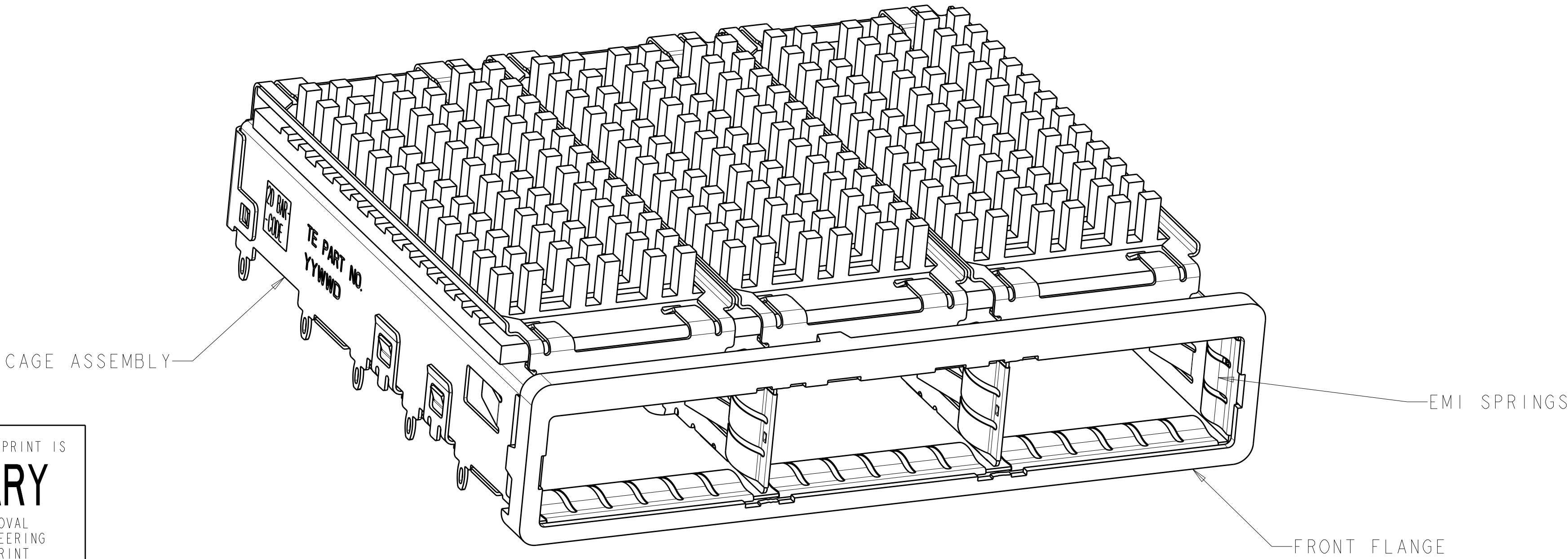
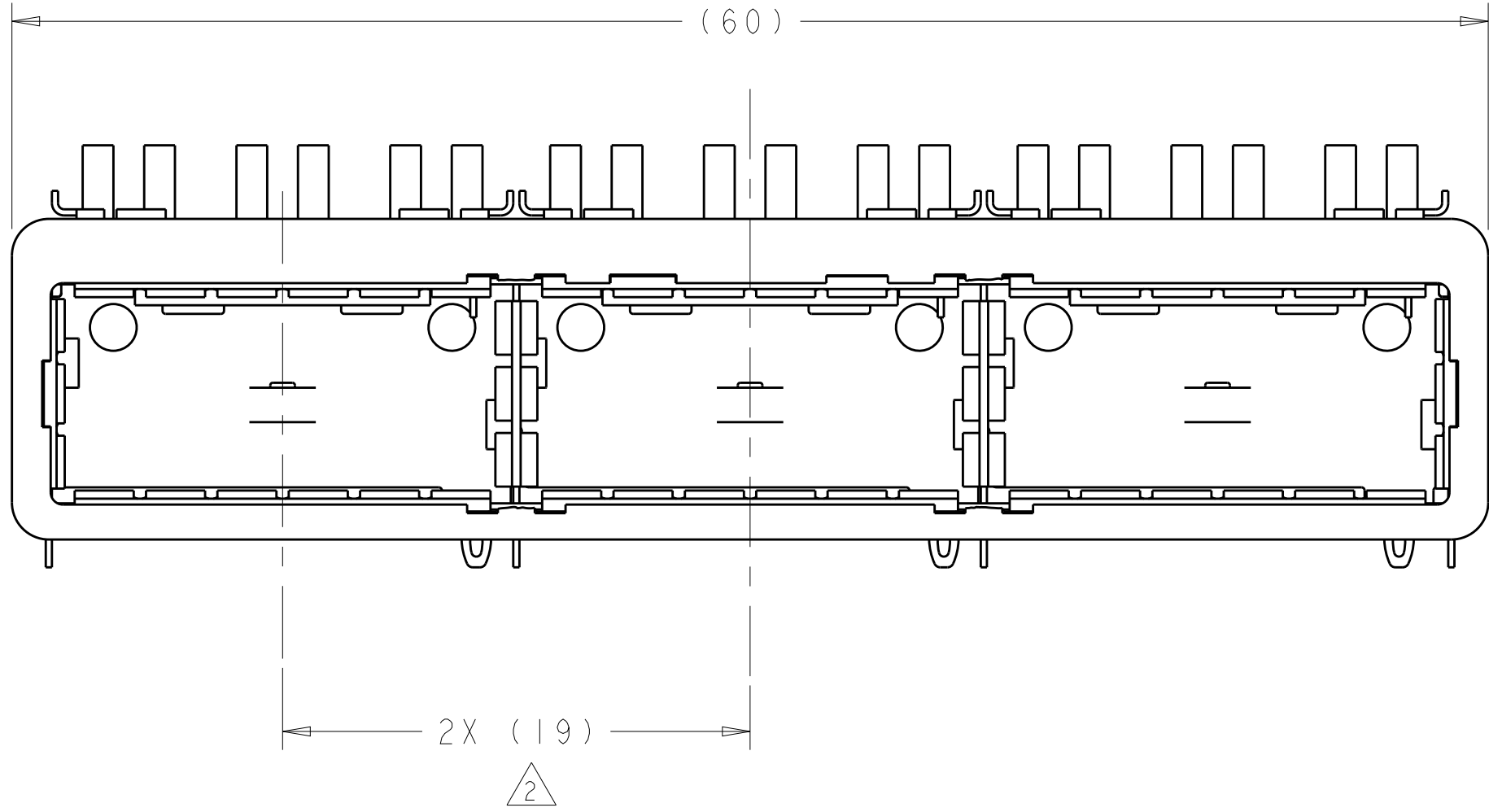
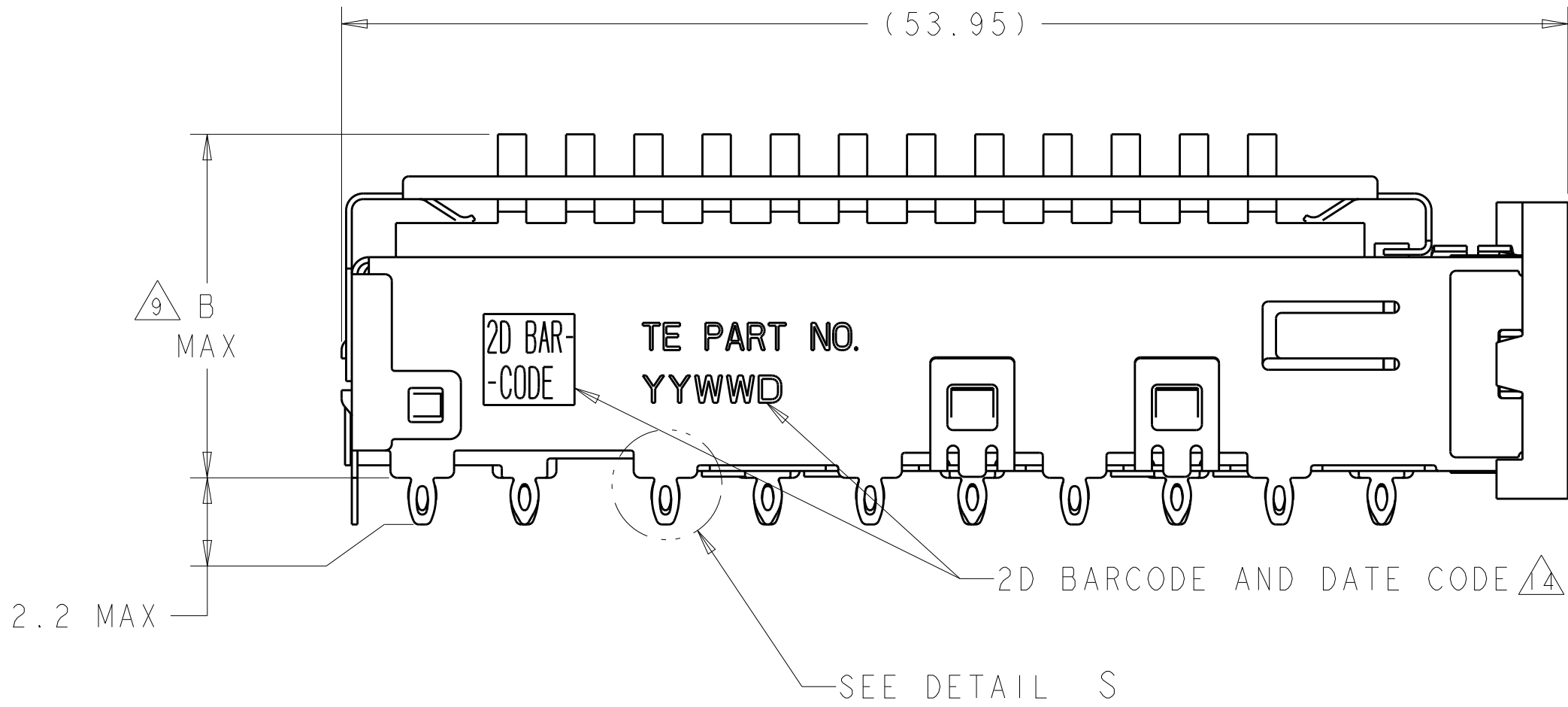

DESIGN APPROVED THIS PRINT IS
PRELIMINARY
TO FIRST PIECE APPROVAL
CONTACT PRODUCT ENGINEERING
BEFORE USING THIS PRINT

16.8	CUSTOMERIZED	2007456-4
23.0	NETWORKING	2007456-3
16.0	SAN	2007456-2
13.7	PCI	2007456-1
B	HEAT SINK PROFILE	PART NUMBER

THIS DRAWING IS A CONTROLLED DOCUMENT.		DWN C. VALENTINE CHK E. BRIGHT APVD F. BRIGHT	07NOV2007 07NOV2007 07NOV2007	NAME 1X3 CAGE ASSEMBLY, BEHIND BEZEL, W/ HEAT SINKS, QSFP	
DIMENSIONS:		TOLERANCES UNLESS OTHERWISE SPECIFIED:		PRODUCT SPEC	
mm		0 PLC ±.1 1 PLC ±0.1 2 PLC ±.1 3 PLC ±. 4 PLC ±. ANGLES ±. FINISH		108-2286	
MATERIAL		114-13218		APPLICATION SPEC	
WEIGHT		-		114-13218	
CUSTOMER DRAWING		SCALE 4:1		SHEET 1 OF 5	
REV F		REV F		REV F	

LOC	DIST	REVISIONS					
		P	LTR	DESCRIPTION	DATE	DWN	APVD
GP	00	-	-	SEE SHEET 1	-	-	-

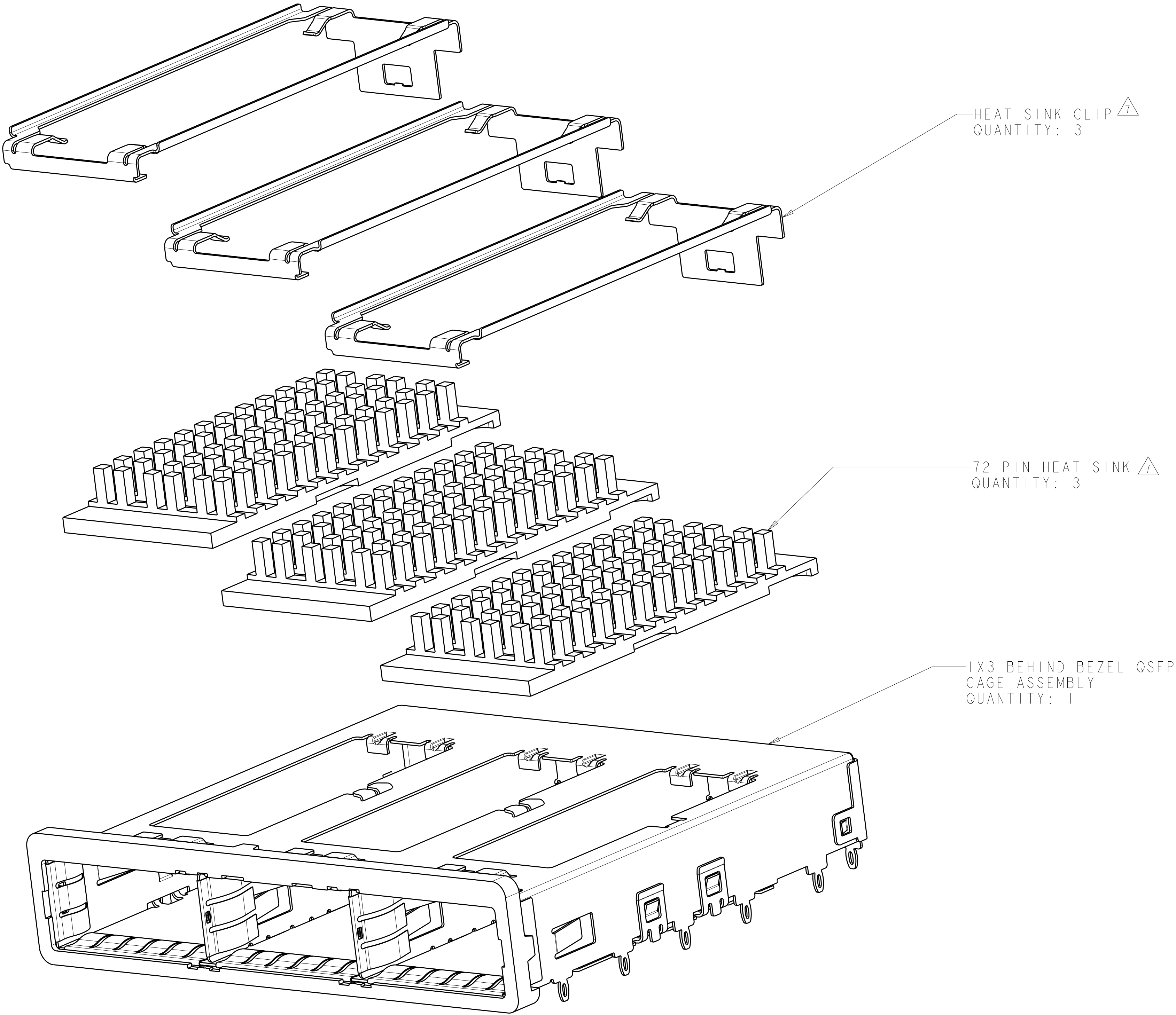

DESIGN APPROVED THIS PRINT IS

PRELIMINARY

TO FIRST PIECE APPROVAL
CONTACT PRODUCT ENGINEERING
BEFORE USING THIS PRINT

THIS DRAWING IS A CONTROLLED DOCUMENT.		DWN C. VALENTINE	07NOV2007	TE Connectivity	
		CHK E. BRIGHT	07NOV2007		
DIMENSIONS:		APVD F. BRIGHT	07NOV2007	NAME 1X3 CAGE ASSEMBLY, BEHIND BEZEL, W/ HEAT SINKS, QSFP	
mm		PRODUCT SPEC		SIZE	
		108-2286		CAGE CODE	
		APPLICATION SPEC		DRAWING NO	
		114-13218		RESTRICTED TO	
		WEIGHT		A100779C=2007456	
MATERIAL		CUSTOMER DRAWING		SCALE	
-				4:1	
				SHEET	
				2	
				OF	
				5	
				REV	
				F	

LOC		DIST		REVISIONS					
GP		00		P	LTR	DESCRIPTION	DATE	DWN	APVD
				-	-	SEE SHEET 1	-	-	-

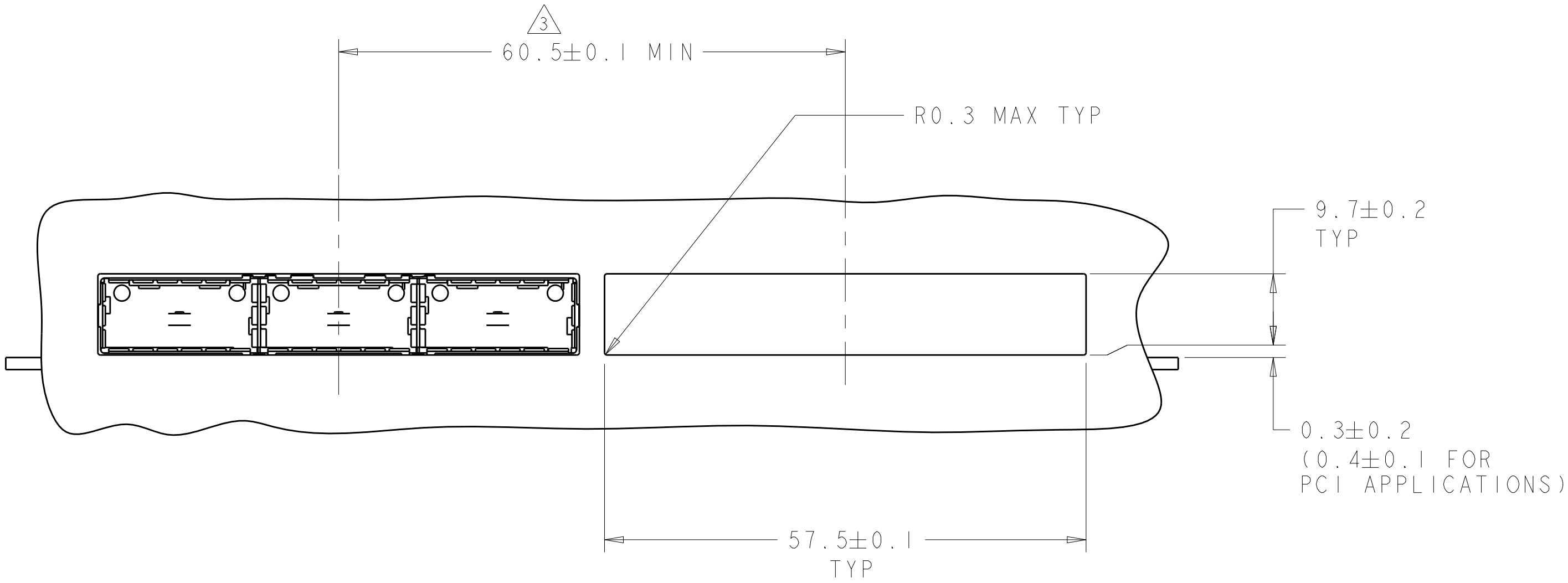

ONE SIDED CONFIGURATION
SCALE 2:1

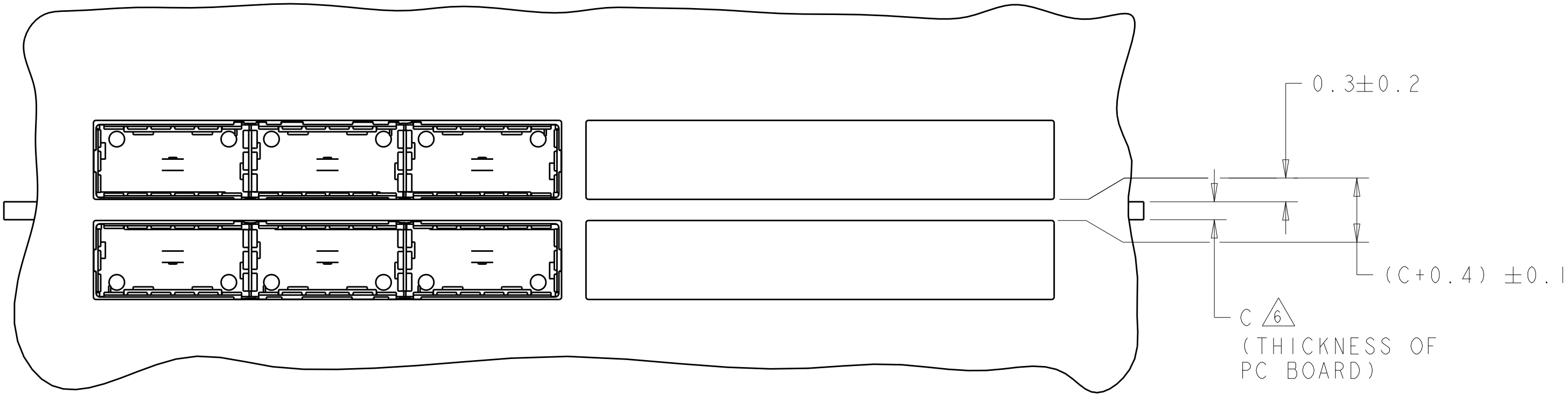
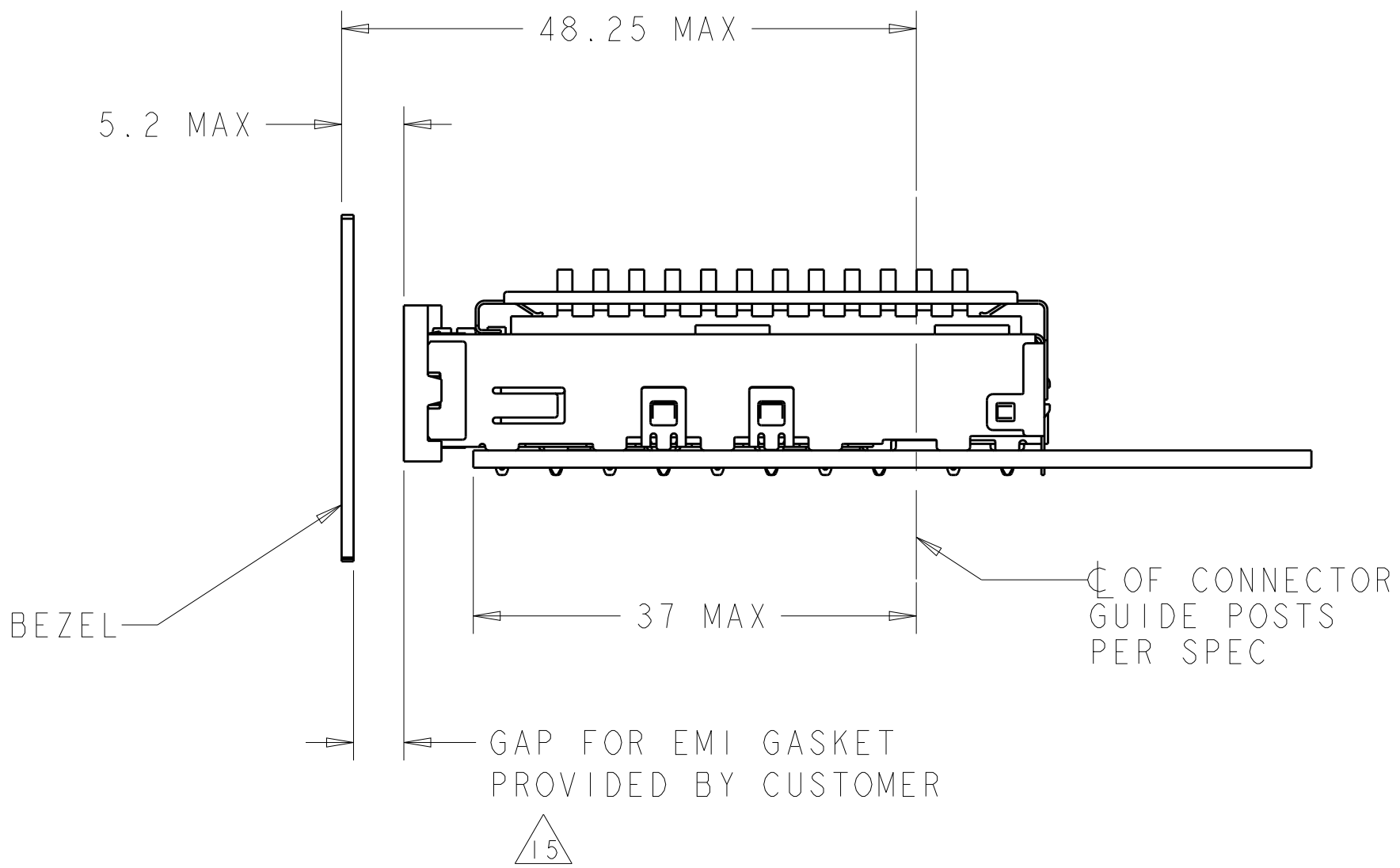

BELLY TO BELLY CONFIGURATION SIMILAR
TO ONE SIDED EXCEPT WHERE NOTED
SCALE 2:1

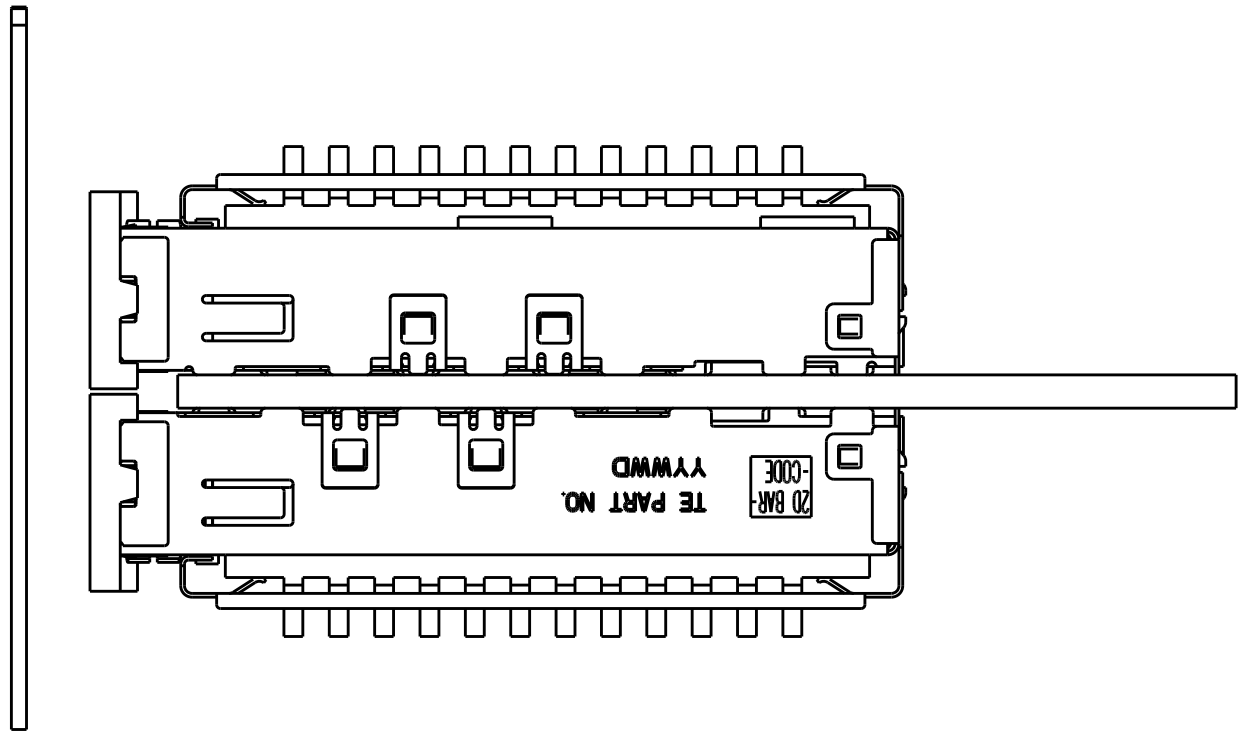

DESIGN APPROVED THIS PRINT IS
PRELIMINARY
TO FIRST PIECE APPROVAL
CONTACT PRODUCT ENGINEERING
BEFORE USING THIS PRINT

THIS DRAWING IS A CONTROLLED DOCUMENT.		DWN C. VALENTINE CHK E. BRIGHT APVD F. BRIGHT	07NOV2007 07NOV2007 07NOV2007	TE Connectivity	
DIMENSIONS: mm		TOLERANCES UNLESS OTHERWISE SPECIFIED: 0 PLC ±.1 1 PLC ±0.1 2 PLC ±0.1 3 PLC ±.1 4 PLC ±.1 ANGLES ±.1		NAME 1X3 CAGE ASSEMBLY, BEHIND BEZEL, W/ HEAT SINKS, QSFP	
MATERIAL -		FINISH -		SIZE A100779	
				DRAWING NO C=2007456	
				RESTRICTED TO -	
				SCALE 4:1	
				SHEET 3 OF 5	
				REV F	

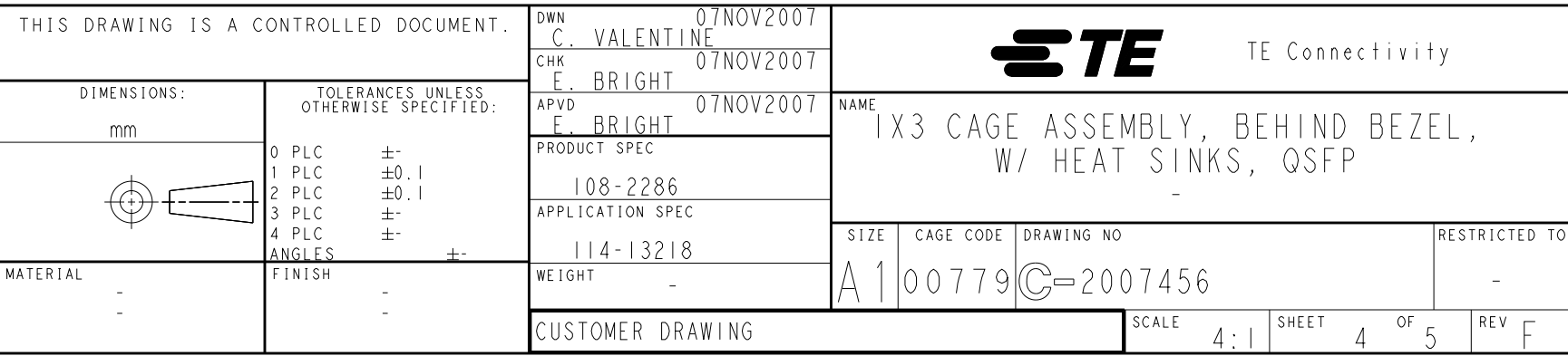

RECOMMENDED PC BOARD LAYOUT
SINGLE SIDE MOUNT CONFIGURATION
SCALE 5:1

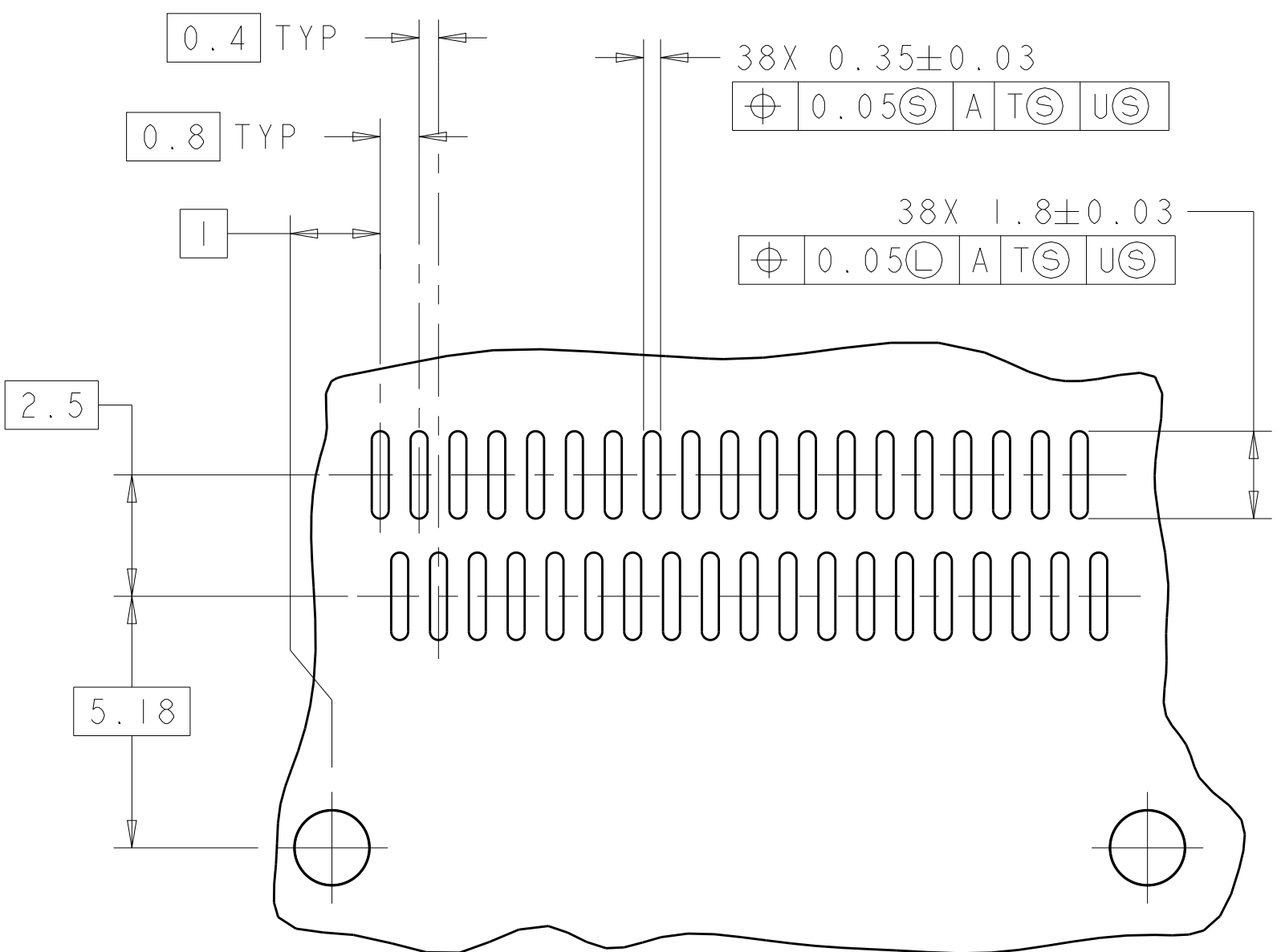

3.4 MIN $\triangle 3$
 C OF FINAL ROW OF HOLES
 TO C OF FIRST ROW OF HOLES
 FOR NEXT ADJACENT CAGE

DESIGN APPROVED THIS PRINT IS

PRELIMINARY

TO FIRST PIECE APPROVAL
CONTACT PRODUCT ENGINEERING
BEFORE USING THIS PRINT

THIS DRAWING IS A CONTROLLED DOCUMENT.						DWN	07NOV2007				
						CN	<u>V. VALENTIN</u>				
						CHK	07NOV2007				
						E	BRIGHT				
						APPD	07NOV2007				
						F	BRIGHT				
DIMENSIONS:						TOLERANCES, UNLESS OTHERWISE SPECIFIED:		NAME			
mm								I X3 CAGE ASSEMBLY, BEHIND BEZEL, W/ HEAT SINKS, OSFP -			
						PRODUCT SPEC		SIZE			
						108-2286		CAGE CODE			
						APPLICATION SPEC		DRAWING NO			
						114-13218		RESTRICTED TO			
MATERIAL						WEIGHT		A1 00779 © 2007456			
-						-		SCALE 4:1 SHEET 5 OF 5 REV F			
CUSTOMER DRAWING											