

Dimensions (In.)

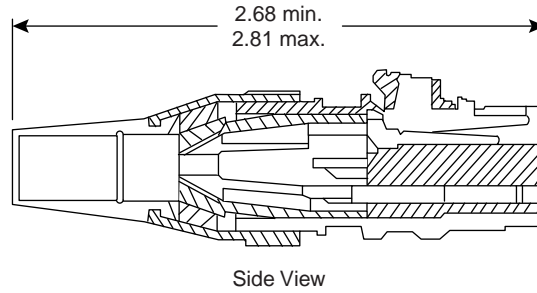

Side View

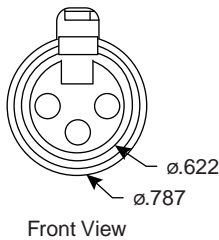

Front View

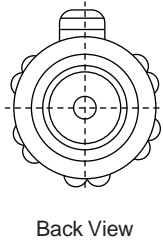

Back View

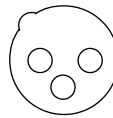

Fig. A  
3 Pin

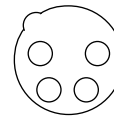

Fig. B  
4 Pin

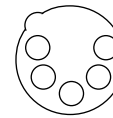

Fig. C  
5 Pin

**Specifications:**

- Type: broadcast quality female XLR
- Housing, latch: zinc high pressure diecasting satin nickel or black chrome
- Contact base: valox DR48
- Contacts: brass 3 microns silver plated or .5 microns gold plated
- Strain relief: santoprene, UL 94 HBN
- Sealing ring: santoprene, UL 94 HB
- Pin base molding: noryl, UL 94 V-1
- Chuck: acetal, UL 94 HB
- Earthing: spring steel, 3 microns silver plate, anti-tarnish
- Optional identification rings: acetal, UL 94 HB; colors (yellow, brown, blue, green, red, white, black, and clear)
- Cable retention: chuck and screw collar
- Terminals: solder buckets
- Cable range:  $\phi 2.8\text{mm} \sim \phi 8.0\text{mm}$
- Insertion force:  $\leq 20\text{N}$
- Withdrawal force:  $\leq 10\text{N}$
- Life: 5000 insertions min.
- Working voltage: 250VDC or AC peak
- Test voltage: 1500VAC
- Contact resistance:  $\leq 3\text{m}\Omega$  max.
- Insulation resistance:  $\geq 1\text{G}\Omega$
- Temperature range:  $-30^\circ \sim +80^\circ\text{C}$

Mouser Stock No.	Fig.	Housing	Contacts	Current Rating (A)	Wire AWG	Cap. (pf)
164-7113	A	Nickel	Silver	16	12	$\leq 4$
164-7114	B	Nickel	Silver	10	16	$\leq 7$
164-7115	C	Nickel	Silver	7.5	18	$\leq 7$
164-7213	A	Black	Silver	16	12	$\leq 4$
164-7214	B	Black	Silver	10	16	$\leq 7$
164-7215	C	Black	Silver	7.5	18	$\leq 7$
164-7123	A	Nickel	Gold	16	12	$\leq 4$
164-7124	B	Nickel	Gold	10	16	$\leq 7$
164-7125	C	Nickel	Gold	7.5	18	$\leq 7$
164-7223	A	Black	Gold	16	12	$\leq 4$
164-7224	B	Black	Gold	10	16	$\leq 7$
164-7225	C	Black	Gold	7.5	18	$\leq 7$