

NOTES:

- 1. CONTACTS ARE ASSEMBLED INTO CONNECTOR.
- 2. PARTS ARE TO BE BAGGED AS A KIT.
- 3. ALL DIMENSIONS ARE FOR REFERENCE ONLY.

KIT PART NO.	CABLE OD.
W8882-10SG-522	.220-.250 [5.6-6.4mm]
W8882-10SG-528	.265-.285 [6.7-7.2mm]

NO. OF CONTACTS — GROMMET SIZES

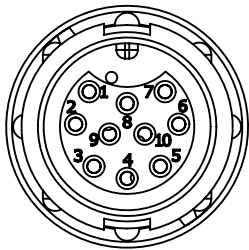

FACE VIEW

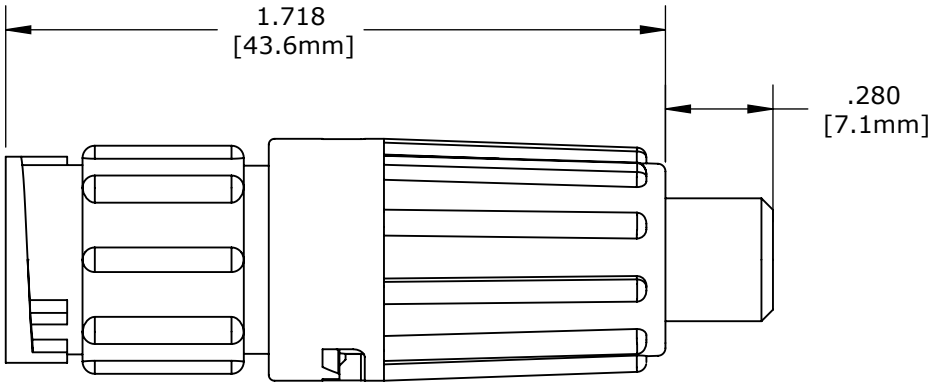

ASSEMBLED KIT VIEW  
W8882-10SG-522 SHOWN

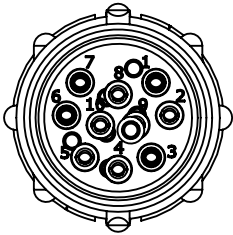

WIRE VIEW

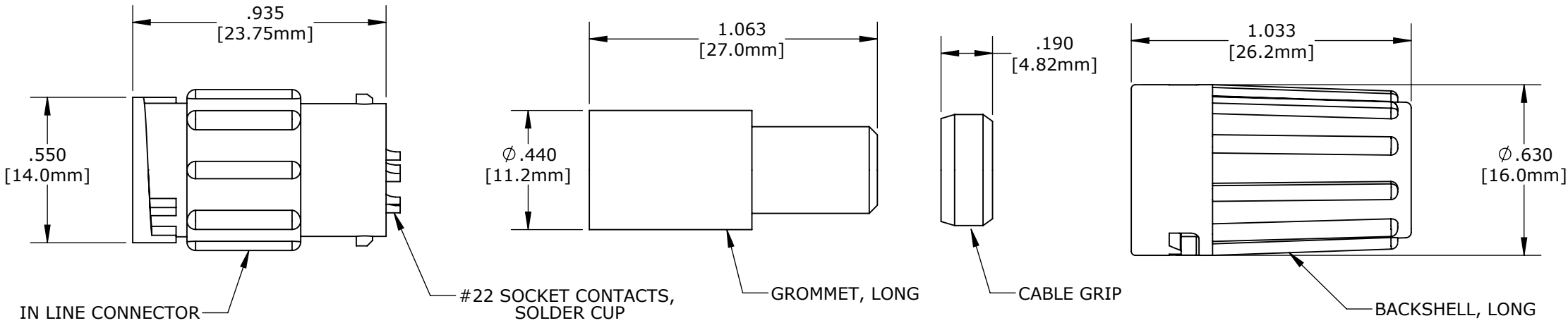

IN LINE CONNECTOR

#22 SOCKET CONTACTS,  
SOLDER CUP

GROMMET, LONG

CABLE GRIP

BACKSHELL, LONG

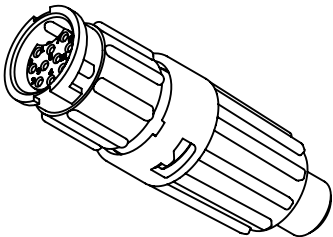

ASSEMBLED KIT  
FOR CUSTOMER REFERENCE

CUSTOMER APPROVAL

THIS DOCUMENT CONTAINS CONFIDENTIAL INFORMATION PROPRIETARY TO CONXALL CORPORATION. ANY REPRODUCTION, DISCLOSURE, OR USE OF THIS DOCUMENT /INFORMATION IS EXPRESSLY PROHIBITED UNLESS AUTHORIZED IN WRITING BY CONXALL CORPORATION.

APPROVED BY: \_\_\_\_\_  
DATE: \_\_\_\_\_

CUSTOMER DRAWING

0A	AM	04/05/16	FIRST DRAWN				
REV.	INIT.	DATE	DESCRIPTION				
<div>ALL INFORMATION ILLUSTRATED IS THE PROPERTY OF "CONXALL CORPORATION." UNAUTHORIZED DUPLICATION OR DISTRIBUTION OF THIS DOCUMENT IS PROHIBITED.</div> <div>ALL UNITS ARE IN FEET, INCHES, FRACTION OF INCHES AND DECIMALS.</div> <div>UNLESS OTHERWISE SPECIFIED TOLERANCES: 3 PLACE DECIMALS ±.005 ANGLES ±1° FRACTIONS ±1/16</div> <div>▷ = CRITICAL CHARACTERISTIC FLAG PER SPEC. XXXX</div>			ORIG. DRAWN BY: AM	DATE: 04/05/16	<div>conxall</div> <div>601 E. WILDWOOD VILLA PARK, IL 60181</div>		
			CHECKED BY:				
			APPROVED BY:	TITLE: IN-LINE CONNECTOR, KIT (10) #22 SOCKET CONTACT, SOLDER MINI-CON-X			
			SCALE NTS	SIZE B	SHEET 1 OF 1	CUSTOMER: STANDARD PRODUCT	
			FILE:	DIRECTORY: SLW	PART NUMBER:	W8882-10SG-5XX	
							REV 0A