

$\varnothing 0.138$ THRU [3.5]
 $\checkmark \varnothing 0.230 \times 82^\circ$
 (2) PLACES

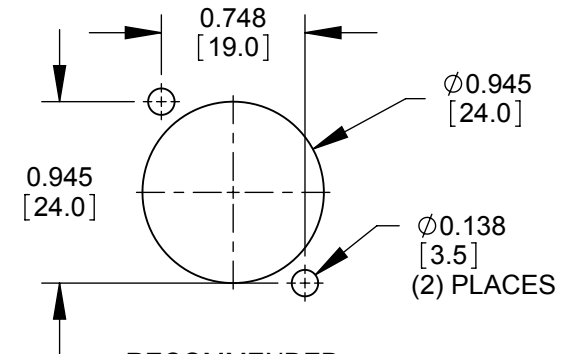
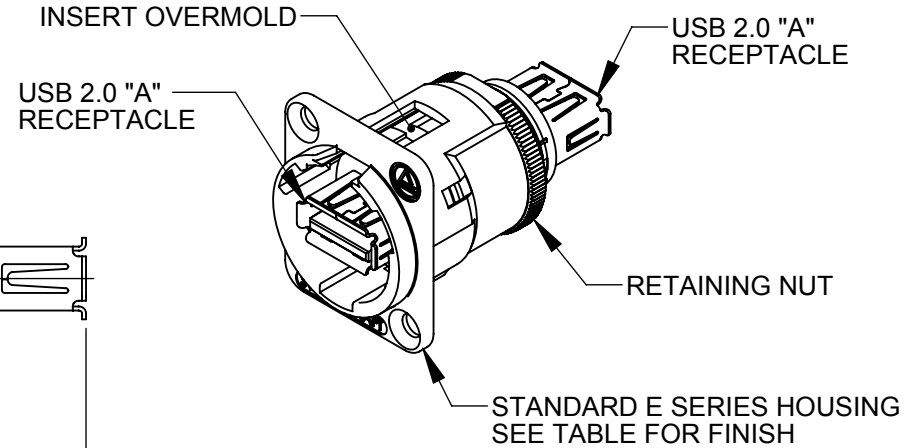
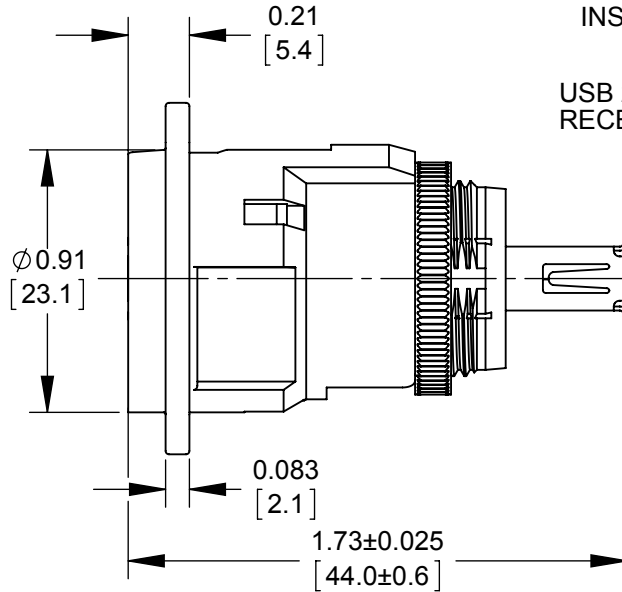

NOTES:

- MATERIALS:
 INSERT OVERMOLD - THERMOPLASTIC, BLACK
 RETAINING NUT - BRASS, NICKEL PLATED
 HOUSING - ZINC ALLOY
- THIS PRODUCT IS RoHS COMPLIANT.

PART NUMBER	HOUSING FINISH
EHUSBAAX	NICKEL
EHUSBAABX	BLACK CHROME

CUSTOMER DRAWING

					<div>UNLESS OTHERWISE SPECIFIED</div> <div>1. ALL DIMENSIONS IN INCHES [mm]</div> <div>- TWO PLACE DECIMALS ±0.02 [0.5]</div> <div>- THREE PLACE DECIMALS ±0.005 [0.13]</div>	THIS DRAWING DESCRIBES A DESIGN CONSIDERED PROPRIETARY IN NATURE, DEVELOPED AND MANUFACTURED BY SWITCHCRAFT INC. AND IS RELEASED ON A CONFIDENTIAL BASIS FOR IDENTIFICATION PURPOSES ONLY.				
						SIZE *	WIDTH *	MULT *	LBS/M *	TEMPER *
						FINISH *			MATERIAL *	
						SPEC No. *			SPEC No. *	
						FIRST USED ON *		SCALE 1.5:1		<div>Switchcraft®</div>
						DATE DRAWN	BY	CHKD *	APVD *	
0A	PRELIMINARY	9/02/15	JGK	*		9/02/15	JGK	*	*	SHEET 1 OF 1
REV	ECO NUMBER	DATE	BY	APVD		NAME E SERIES CONNECTOR, USB A FEMALE TO A FEMALE, RoHS			PART No. EHUSBAA_X SERIES	REV 0A
REVISIONS					DO NOT SCALE DRAWING					

SolidWorks CAD File

