

RF 19 - Tactile switch, fully illuminated with 2 LED, silver contacts

3.14.002.024/0000



General information

| | |
|----------------------|--------|
| Color of lens | orange |
| Recommended key grid | 23 mm |

Dimensions

| | |
|----------------|----------|
| Length | 19.05 mm |
| Width | 19.05 mm |
| Overall height | 9.7 mm |

Mechanical design

| | |
|---------------------|-------------------------|
| Mounting | soldering in PCB |
| Terminals | THT |
| Contact system | snap-action contact |
| Contact arrangement | 1 NO |
| Contact materials | Ag |
| Illumination | fully illuminated 2 LED |
| LED color | yellow |
| LED type | 2 mm |

Mechanical characteristics

| | |
|----------------------|-------------------------------|
| Operating force max. | 2.9 ^{+0.6} N |
| Switching travel | 0.5 ^{+0.2} mm |
| Robustness max. | with through-plated PCB 100 N |

Electrical characteristics

| | |
|----------------------------------|-------------------------|
| Rated voltage min. | Au: 0.02 V, Ag: 3 V |
| Rated voltage max. | 35 V |
| Rated current min. | Au: 0.01 mA, Ag: 0.1 mA |
| Rated current max. | Au: 100 mA, Ag: 250 mA |
| Rated power max. (ohmic load) | Au: 2 W, Ag: 12.5 W |
| Contact resistance when new max. | 100 mΩ |
| Insulation resistance | 10 ⁹ Ω |

Other specifications

| | |
|----------------------------------------|------------------------------------------|
| Ambient temp. operating min. | -25 °C |
| Ambient temp. operating max. | +70 °C |
| Environmental resistance | acc. to IEC 60068-2-14, -30, -33 and -78 |
| Operating life min. (operations) | 1,000,000 cycle |
| Solderability / solder heat resistance | according to DIN EN 60068-2-20 |
| Wave soldering | 260 °C max. |
| Manual soldering | 350 °C / 5 sec. max. |

| | |
|----------------|-----|
| ROHS compliant | yes |
|----------------|-----|

| | |
|-----------------|-----|
| REACH compliant | yes |
|-----------------|-----|

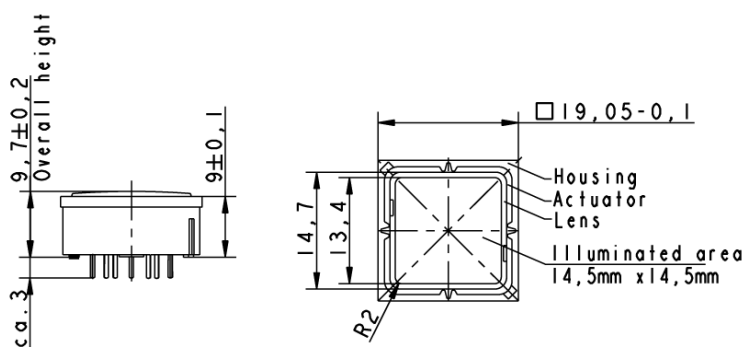
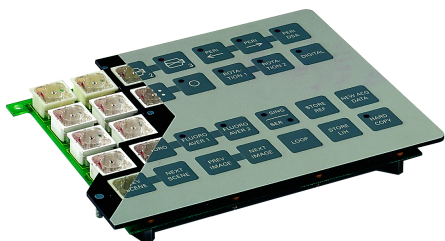

Lens yellow

