

PRODUCT NO	DIM A	DIM B	DIM L	RECOMMENDED P.C. BOARD THICKNESS	PICK-UP CAP	PACKAGING	REMARK
10122272-001LF	8.50	3.50	3.7	4.57mm (0.018")	NO	TRAY	--
YES							
10122272-001CLF							
10122272-001C-TRLF	8.50	3.50	2.0	2.54mm (0.100")	NO	TRAY	--
YES							
10122272-002LF							
10122272-002CLF	7.50	2.50	0.6	1.57mm (0.062")	NO	TRAY	--
YES							
10122272-002C-TRLF							
10122272-003LF	7.50	2.50	0.6	1.57mm (0.062")	NO	TRAY	--
YES							
10122272-003CLF							
10122272-003C-TRLF					YES	TAPE & REEL	

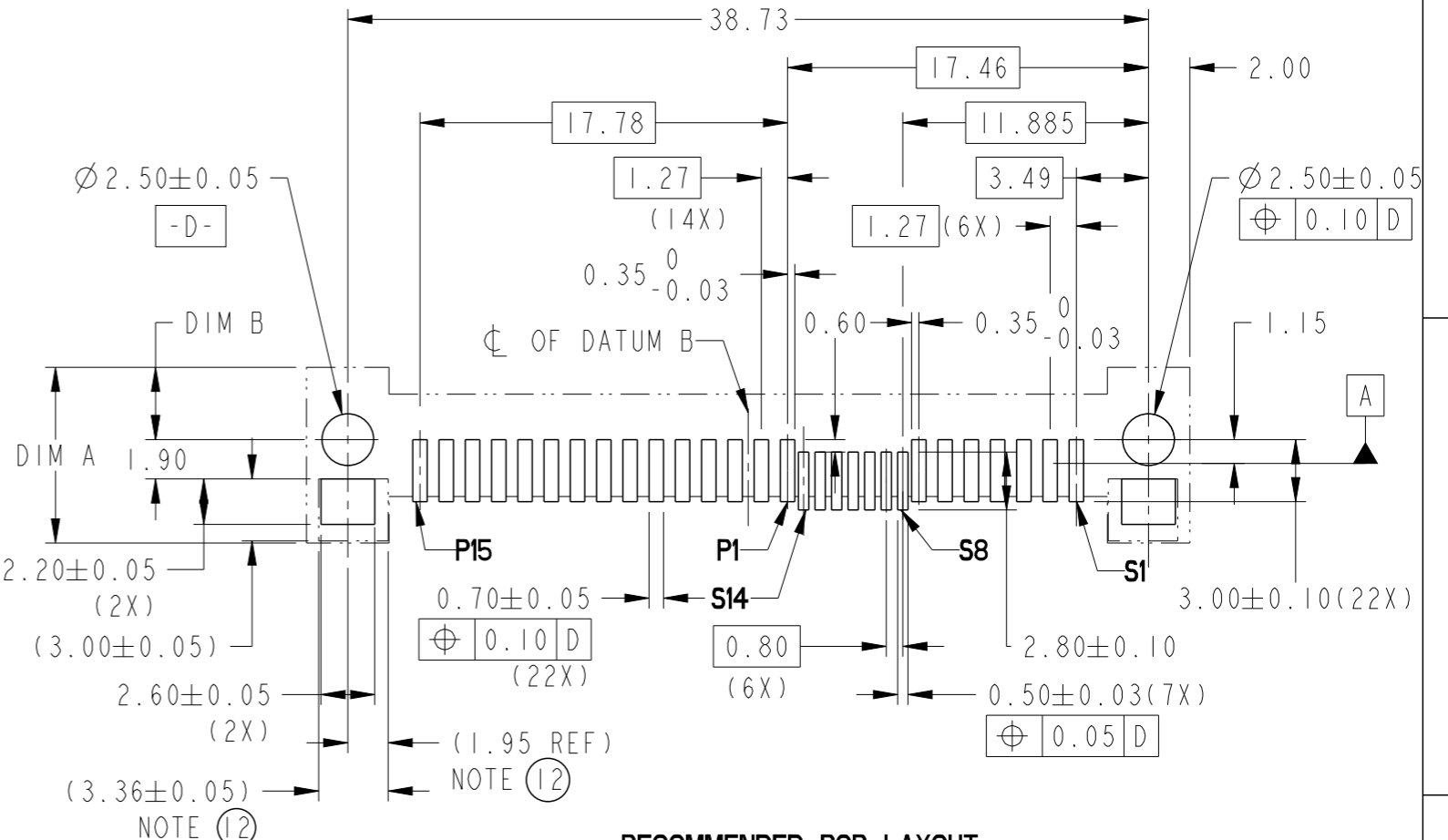

RECOMMENDED PCB LAYOUT
SCALE 3:1

PART WITH PICK-UP CAP, SEE NOTE 5

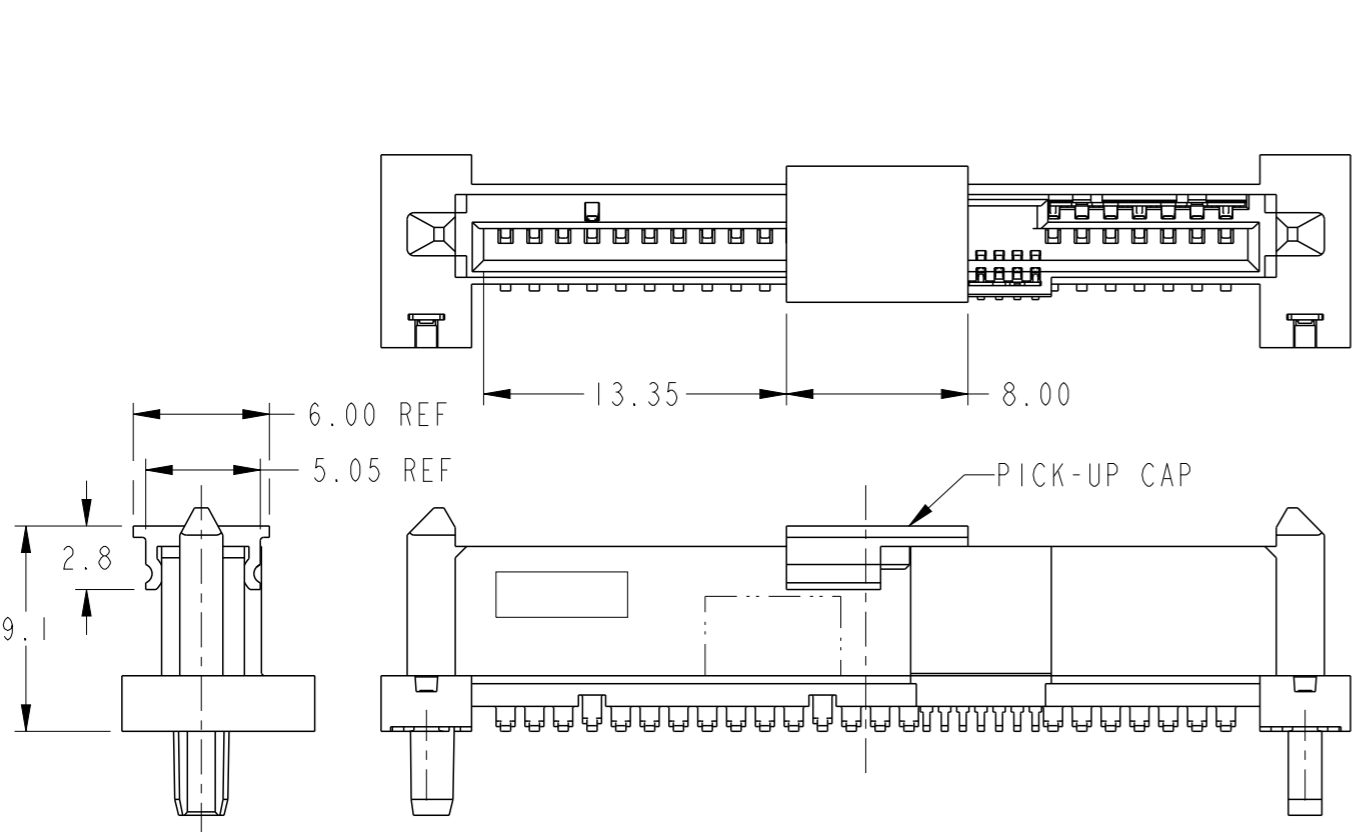
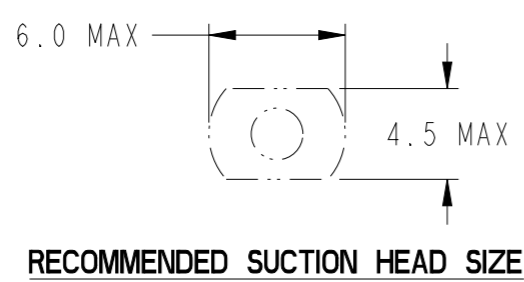

RECOMMENDED SUCTION HEAD SIZE

Copyright FCI.

spec ref	-	dr	Guat-Lian Loo	2013/07/03	projection	MM	size	A3	scale	3:1	
tolerance std	ISO 406 ISO 1101	eng	Guat-Lian Loo	2015/03/16			ecn no	ELX-S-18819-1			
surface	✓	chr	-	2015/03/19			product family	SAS	rel level	Released	
linear	0.X ± 0.XX ±.20 0.XXX ±	appr	Chen-Hong Tan	2015/03/19	12G SAS RECEPTACLE WIDE BASE SMT TYPE ASSY		dwg no	10122272		rev	C
angular	0° ±2°	www.fci.com		cat. no.	-	Product - Customer Drw	sheet 2 of 3				

PRODUCT NUMBER
SEE TABLE

NOTES:

1. MATERIAL:
 - 1) HOUSING: HIGH TEMP TERMOPLASTIC, UL 94V-0
COLOR : BLACK
 - 2) TERMINAL: COPPER ALLOY
 - 3) HOLD DOWN: COPPER ALLOY
2. FINISH:
 - 1) TERMINAL: 30μ" Au PLATING (CONTACT POINT)
OVER 50μ" NICKEL
 - 2) SOLDER TAIL: 50μ" MIN Sn OVER 50μ" MIN NICKEL
 - 3) HOLD DOWN: 50μ" MIN Sn OVER 50μ" MIN NICKEL
- ③ THE DIM. IS MEASURED AT P.C. BOARD SITTING PLANE
4. PER SEF REV 1.3 EXCEPT 0.8mm PITCH BUMP AREA
- ⑤ PART WITH PICK-UP CAP, P/N XXXXXXXX-XXXC_LF
6. THE STD PACKAGING IS IN TRAY
7. THE TAPE & REEL PACKAGING, SUFFIX "-TR" ADDED AFTER
PRODUCT NUMBER (E.G. XXXXXXXX-XXXC-TRLF)
8. THE HOUSING WILL WITHSTAND EXPOSURE TO 260°C PEAK TEMPERATURE
FOR 10 SECONDS IN A CONVECTION, INFRA-RED OR VAPOR PHASE REFLOW
OVEN.
- △ ⑨ THIS PRODUCT MEETS EUROPEAN UNION DIRECTIVES AND OTHER COUNTRY
REGULATIONS AS DESCRIBED IN GS-47-0004.
- ⑩ PART NUMBERS ENDING IN "LF" MEANS FOR NOTE 8 LEAD FREE IDENTIFICATION
11. A △ C SYMBOL WILL BE NEXT TO ANY DIMENSION, VIEW, OR NOTE WHICH HAS
BEEN MODIFIED WITH THE CURRENT DRAWING REVISION.
- ⑫ THE GROUND PAD SIZES SHOWN IN () IS THE COMPETITOR DESIGN FOR REF.
- ⑬ DATE CODE LOCATION. DATE CODE NO.YYWW (E.G.14225).
- △ ⑭ CORING AT NON FUNCTIONAL AREAS ARE SUBJECT TO CHANGE WITHOUT NOTICES.



Copyright FCI.

spec ref -		dr	Guat-Lian Loo	2013/07/03	projection	MM	size	A3	scale	3:1
tolerance std ISO 406 ISO 1101		TOLERANCES UNLESS OTHERWISE SPECIFIED					ecn no ELX-S-18819-1			
surface ✓		eng	Guat-Lian Loo	2015/03/16			product family	SAS	rel level Released	
ISO 1302	linear	0.X	±-		12G SAS RECEPTACLE WIDE BASE SMT TYPE ASSY		dwg no 10122272	rev C		
		0.XX	±.20							
	angular	0°	±2°	www.fci.com	cat. no.	-	Product - Customer Drw		sheet 3 of 3	