

PRODUCT NO  
10046972-001LF

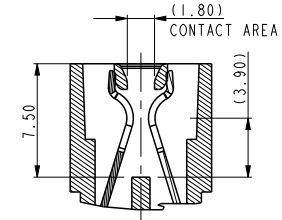
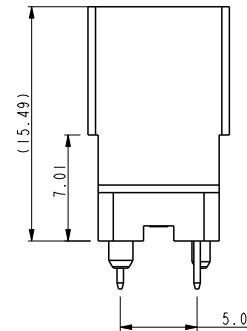
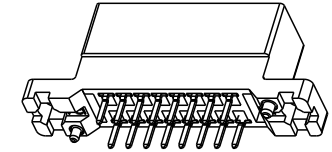
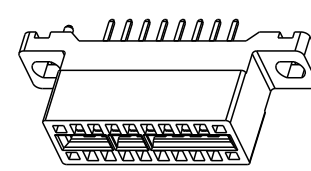
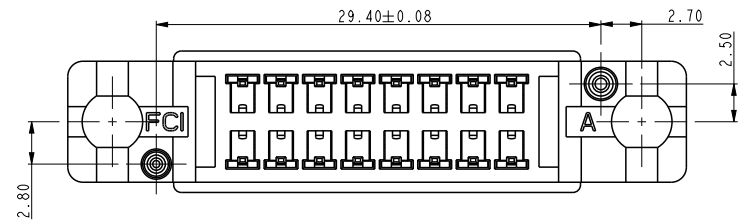
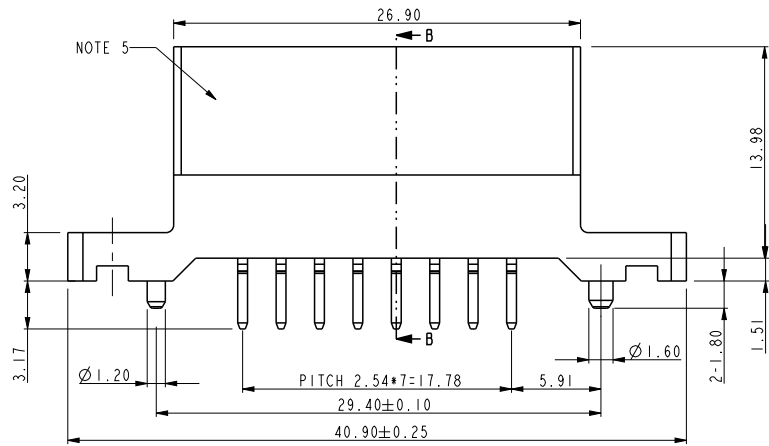
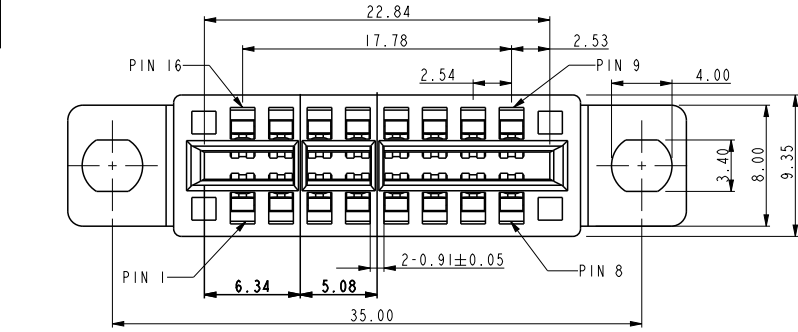

SECTION B-B

NOTE:

1. Material:  
HOUSING: HIGH TEMPERATURE THERMOPLASTIC,  
UL 94 V-0 FLAME RETARDANT.  
TERMINAL: HIGH CONDUCTIVITY COPPER ALLOY.  
PLATING SPEC AS BELOW:  
Ni 50u" UNDER PLATED.  
Au 30u" OVER CONTACT AREA. (ONE SIDE)  
Matte Tin 120u" OVER SOLDERING AREA.
2. PACKING SPEC. GS-14-937.
3. PRODUCT SPEC. GS-12-338.
4. PART NUMBER 10046972-001LF MEETS EUROPEAN UNION DIRECTIVE AND OTHER COUNTRY REGULATIONS AS DESCRIBED IN GS-22-008.  
THE HOUSING WILL WITHSTAND EXPOSURE TO 260°C PEAK TEMPERATURE FOR 10 SECONDS IN A WAVE SOLDER APPLICATION WITH A CIRCUIT BOARD.
5. PRODUCT MARKING ON HOUSING IN AREA SHOWN MEETS AFCI SPECIFICATION: GS-24-007.
6. A SYMBOL  $\triangle$  WILL BE NEXT TO ANY DIMENSION, VIEW, OR NOTE WHICH HAS BEEN MODIFIED WITH THE CURRENT DRAWING REVISION.

spec ref	*	dr	w wcdmin	2006/08/26	projection	MM	size	A4	scale	1.000
tolerance std	TOLERANCES UNLESS OTHERWISE SPECIFIED	eng	Sunny2 Liu	2016/05/05			←→	ecn no	ELX-DG-22934-1	
		chr	Terris Liu	2016/05/20					rel level	Released
surface	linear	appr	Pei-Ming Zheng	2016/05/24	product family					
	angular									
	0.X	±0.5	Amphenol FCI	title	PEC VT WITH MOUNTING EARS		dwg no	10046972		rev
	0.XX	±0.25								
	0.XXX	±0.13								
	0°	±°	cat. no.	*	Product - Customer Drw		sheet 1 of 4		G	



PRODUCT NO  
10046972-002LF

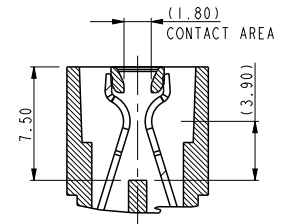
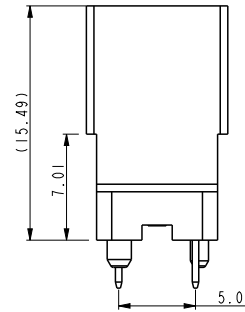
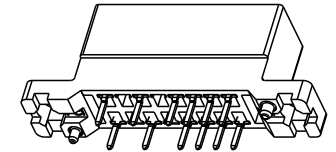
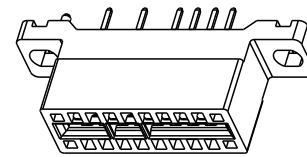
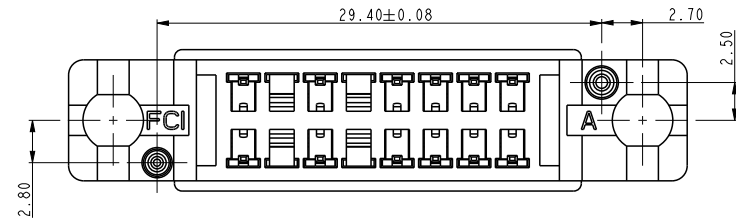
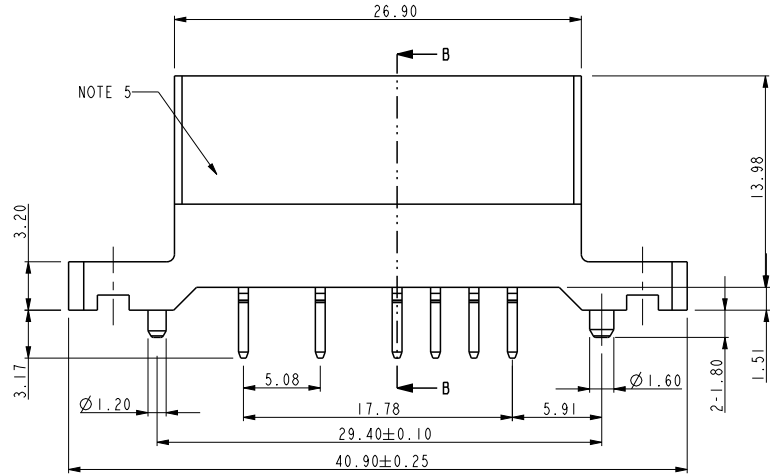
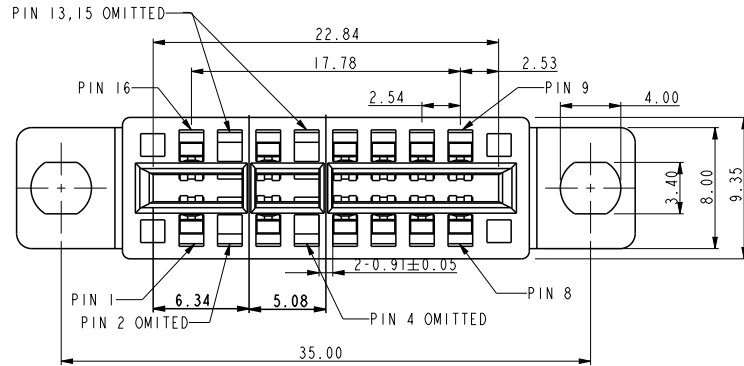

SECTION B-B

NOTE:

- Material:  
HOUSING: HIGH TEMPERATURE THERMOPLASTIC,  
UL 94 V-0 FLAME RETARDANT.  
TERMINAL: HIGH CONDUCTIVITY COPPER ALLOY.  
PLATING SPEC AS BELOW:  
Ni 50u" UNDER PLATED.  
Au 30u" OVER CONTACT AREA.(ONE SIDE)  
Matte Tin 120u" OVER SOLDERING AREA.
- PACKING SPEC. GS-14-937.
- PRODUCT SPEC. GS-12-338.
- PART NUMBER 10046972-001LF MEETS EUROPEAN UNION DIRECTIVE AND OTHER COUNTRY REGULATIONS AS DESCRIBED IN GS-22-008.  
THE HOUSING WILL WITHSTAND EXPOSURE TO 260°C PEAK TEMPERATURE FOR 10 SECONDS IN A WAVE SOLDER APPLICATION WITH A CIRCUIT BOARD.  
PRODUCT MARKING ON HOUSING IN AREA SHOWN MEETS AFCI SPECIFICATION: GS-24-007.
- A SYMBOL WILL BE NEXT TO ANY DIMENSION, VIEW, OR NOTE WHICH HAS BEEN MODIFIED WITH THE CURRENT DRAWING REVISION.

spec ref	*	dr	w wcdadmin	2006/08/26	projection	MM	size	A4	scale	1.000
tolerance std	TOLERANCES UNLESS OTHERWISE SPECIFIED	eng	Sunny2 Liu	2016/05/05			ecn no		ELX-DG-22934-1	
		chr	Terris Liu	2016/05/20			rel level		Released	
		appr	Pei-Ming Zheng	2016/05/24	product family					
surface	linear	Amphenol FCI	title		PEC VT WITH MOUNTING EARS		dwg no		10046972	
			2X8P						rev	
	angular		cat. no.		* Product - Customer Drw		sheet 3 of 4		G	

PRODUCT NO  
10046972-002LF

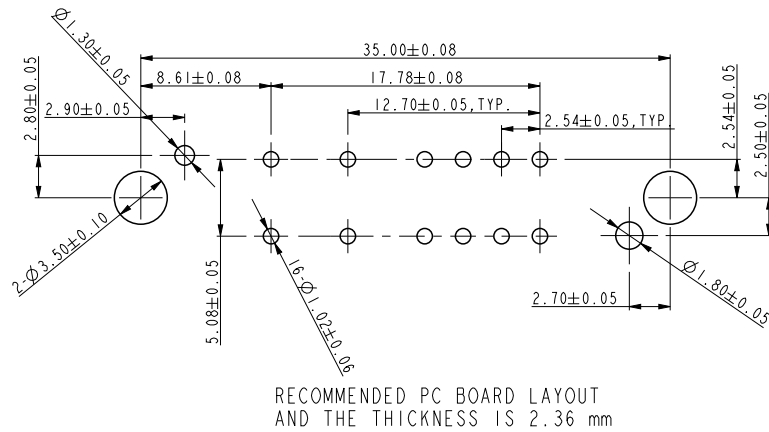
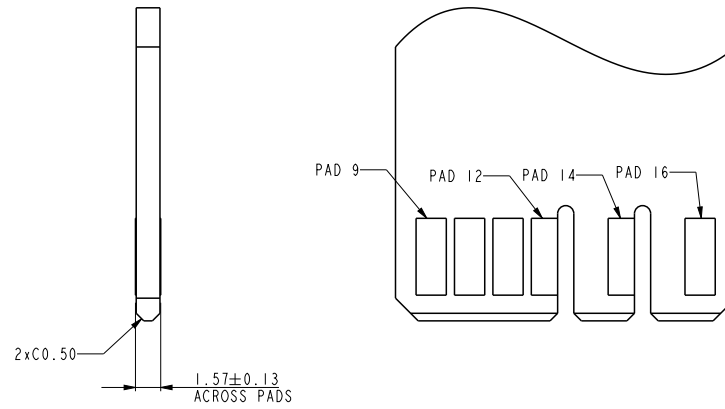
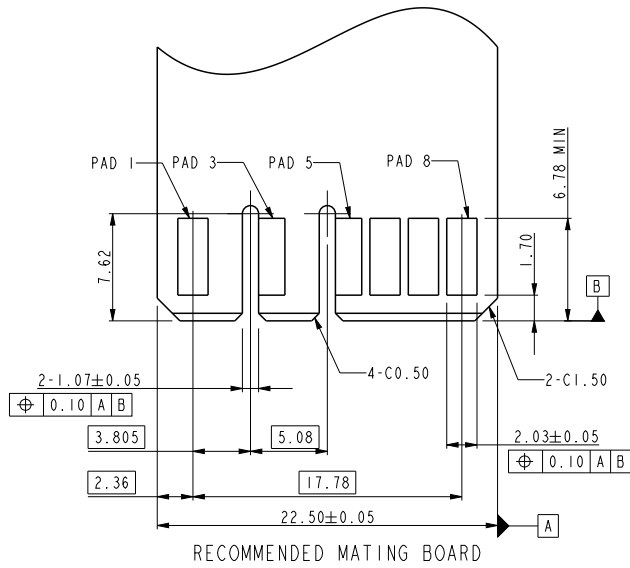

spec ref	*	dr	w wcadmin	2006/08/26	projection	MM ←→	size	A4	scale	1.000			
tolerance std	TOLERANCES UNLESS OTHERWISE SPECIFIED	eng	Sunny2 Liu	2016/05/05			ecn no	ELX-DG-22934-1					
		chr	Terris Liu	2016/05/20			product family	rel level	Released				
surface	linear	0.X	±0.5	<b>Amphenol FCI</b>	title		PEC VT WITH MOUNTING EARS		dwg no	10046972		rev	G
		0.XX	±0.25		2X8P								
		0.XXX	±0.13		cat. no.		*	Product - Customer Drw		sheet 4 of 4			
	angular	0°	±°										