

# EH TQG PANEL MOUNT CONNECTORS

NEW PRODUCT BULLETIN 605

## FEATURES & BENEFITS

- Same high quality connectors as our popular TQG Series, except both male and female versions utilize the same size panel cut-out, simplifying installation and modification.
- Rugged metal construction.
- Available in nickel or black finish.
- Available with 3, 4, 5, 6 or 7 contacts for male, plated in silver or gold and 3, 4 and 5 contacts for female.
- RoHS Compliant.
- The perfect match for our QGPK Series of I/O panels and our WP Series of wall-plates. More info available on our website.

## APPLICATIONS

- Communications equipment
- Wall plates
- Custom I/O panels
- Pro audio equipment



# SWITCHCRAFT®

A HEICO COMPANY



5555 N Elston Ave | Chicago, IL 60630 | P: 773.792.2700 | F: 773.792.2129 | [www.switchcraft.com](http://www.switchcraft.com) | Made in USA.

# EH TQG PANEL MOUNT CONNECTORS

## NEW PRODUCT BULLETIN 605

### MALE EH TQG PANEL CONNECTORS

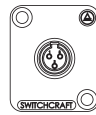
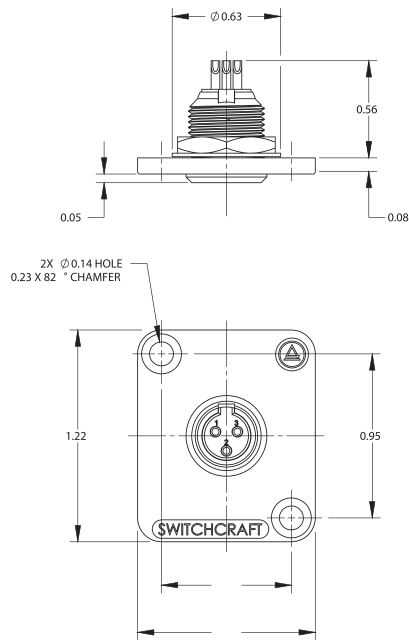

3 PIN



4 PIN



5 PIN



6 PIN

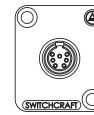

7 PIN



8 PIN

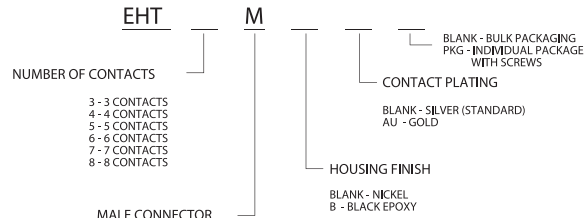

#### NOTES:

1. MATERIALS:
  - PLATE - ZINC ALLOY, PLATED
  - SHELL - COPPER ALLOY, NICKEL PLATED
  - INSERT - THERMOPLASTIC, BROWN
  - CONTACT PINS - COPPER ALLOY, PLATED
  - WASHER - COPPER ALLOY, NICKEL PLATED
  - NUT - COPPER ALLOY, NICKEL PLATED
2. THIS PART IS RoHS COMPLIANT.

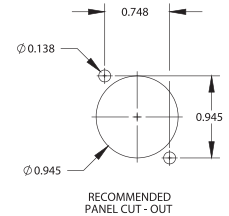

### FEMALE EH TQG PANEL CONNECTORS

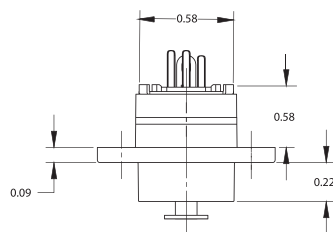

3 PIN



4 PIN



5 PIN

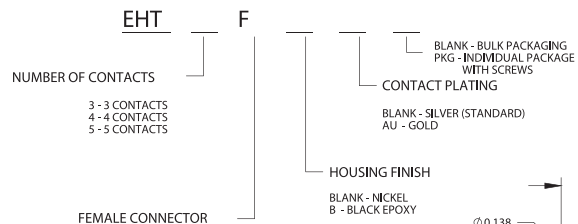

#### NOTES:

1. MATERIALS:
  - HOUSING - ZINC ALLOY, PLATED
  - INNER HOUSING - COPPER ALLOY, NICKEL PLATED
  - FRONT AND REAR INSERTS - THERMOPLASTIC, BROWN
  - CONTACT PINS - COPPER ALLOY, PLATED
  - SOLDER TERMINAL - COPPER ALLOY, TIN PLATED
  - LATCH - COPPER ALLOY, NICKEL PLATED
  - RELEASE LEVER - STEEL, NICKEL PLATED
  - LEVER RETURN SPRING, STAINLESS STEEL
2. THIS PART IS RoHS COMPLIANT.

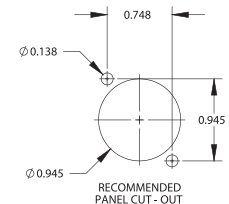

Please visit [www.switchcraft.com](http://www.switchcraft.com) for the most up-to-date product specifications. Made in USA.