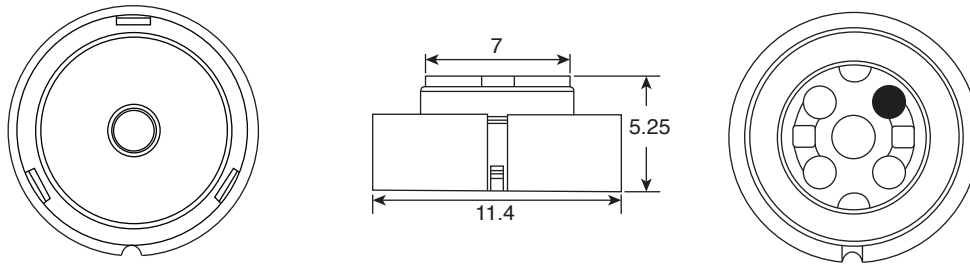
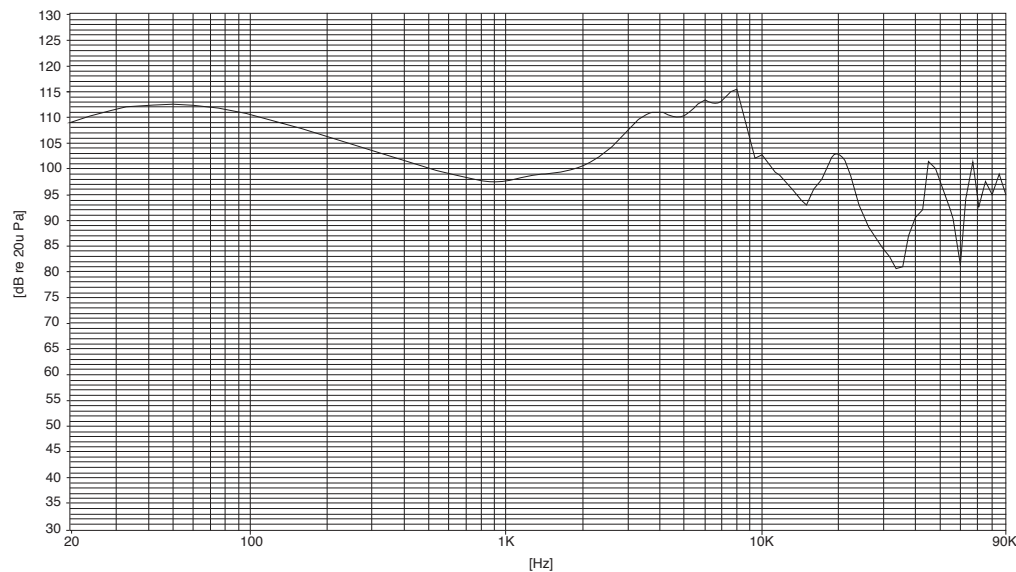

**DIMENSIONS: mm****Frequency Response Curve****Specifications:**

- Nominal Impedance:  $32\Omega \pm 15\%$  At 1000Hz/0.178V
- Power Rating: Normal 3mW. Maximum 5mW
- Output Sound Pressure:  $97 \pm 3\text{dB}/0.178\text{V}$  at 1000Hz (Artificial Ear IEC-60711).
- Frequency Range: 20~20000Hz Average SPL-10dB
- Operating Temperature:  $-20^{\circ}\text{C}$  to  $+50^{\circ}\text{C}$
- Storage Temperature:  $-25^{\circ}\text{C}$  to  $+55^{\circ}\text{C}$

**Note:**

- RoHS Compliant by Exemption