

9	8	7	6	5	4	3	2	1
ASSEMBLY MATERIAL NUMBER	ENG. P/N	ASSEMBLY DESCRIPTION		"A" FINISHED LENGTH				
1301500320	DW4M20	MALE OVERMOLD CABLE ASSEMBLY, #8/4		6 FT				

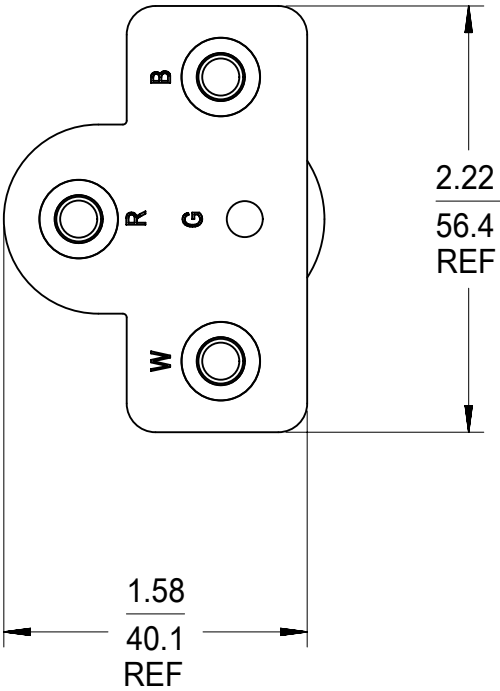
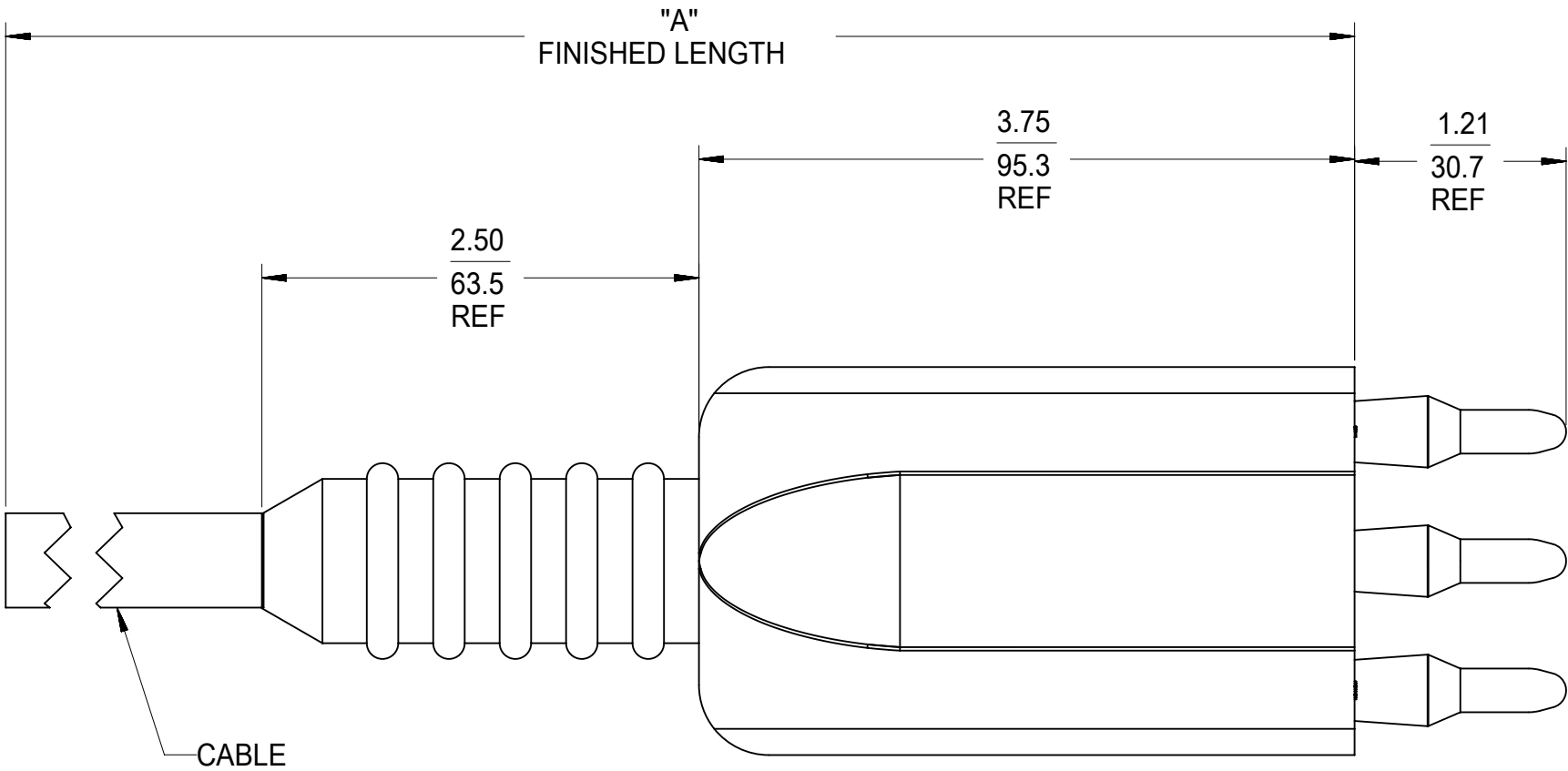
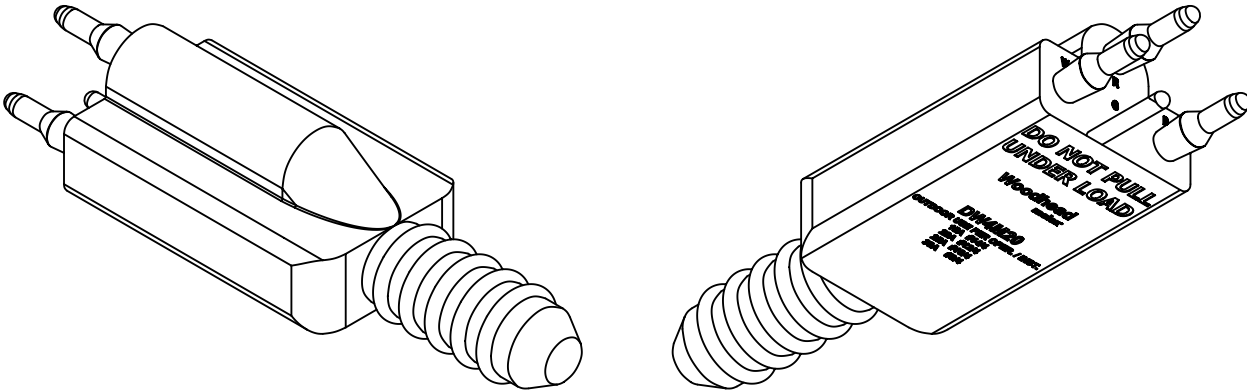

- NOTES:
- 1) OVERMOLD MATERIAL: NEOPRENE OR CPE
 - 2) TERMINALS: COPPER ALLOY
 - 3) CABLE JACKET MATERIAL: NEOPRENE OR CPE
 - 4) CABLE IS MSHA LISTED.
 - 5) WARNING: DO NOT PULL UNDER LOAD.
 - 6) VOLTAGE RATING: 600 V MAX.
 - 7) CURRENT RATING:
 - 8AWG/4 CONDUCTOR - 30 AMPS
 - 10AWG/4 CONDUCTOR - 25 AMPS
 - 12AWG/4 CONDUCTOR - 20 AMPS
 - 14AWG/4 CONDUCTOR - 15 AMPS

THIS DRAWING CONTAINS INFORMATION THAT IS PROPRIETARY TO MOLEX ELECTRONIC TECHNOLOGIES, LLC AND SHOULD NOT BE USED WITHOUT WRITTEN PERMISSION											
DIMENSION UNITS		SCALE		CURRENT REV DESC: MIGRATE TO NX. UPDATE NOTE 1 AND 3.			<div>molex</div>				
INCH		1:1									
GENERAL TOLERANCES (UNLESS SPECIFIED)			EC NO: 615559 DRWN: WLEUNG 2019/04/12 CHK'D: DNGUYEN62 2019/04/22 APPR: HKNEELAND 2019/04/23								
ANGULAR TOL ± 2.0 °											
4 PLACES		±		MALE PLUG CABLE ASSEMBLY 15-30 AMPS, #8 - #14AWG							
3 PLACES		±									
2 PLACES		±		PRODUCT CUSTOMER DRAWING							
1 PLACE		± 0.03									
0 PLACES		±		INITIAL REVISION:		DOCUMENT NUMBER		DOC TYPE	DOC PART	REVISION	
				DRWN: WLEUNG 2013/11/06		SD-130150-001		PSD	001	B1	
				APPR: BWOODMAN 2013/12/27							
DRAFT WHERE APPLICABLE MUST REMAIN WITHIN DIMENSIONS			THIRD ANGLE PROJECTION		DRAWING	SERIES	MATERIAL NUMBER		CUSTOMER		SHEET NUMBER
					B-SIZE	130150	SEE CHART		GENERAL MARKET		1 OF 1

DOCUMENT STATUS	P1	RELEASE DATE	2019/04/23	19:56:36
-----------------	----	--------------	------------	----------