

# SPRING-LOADED PINS

## DISCRETE SPRING-LOADED CONTACTS

### 0985

0985-X-15-20-71-14-11-0

Standard stroke

Solder mount in 0,49 min. mounting hole

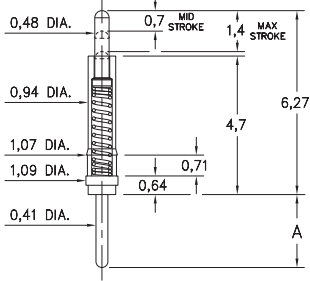

Basic Part Number	Length A
0985-0	2,62
0985-1	3,81
0985-2	4,83

### 0922

0922-0-15-20-75-14-11-0

Standard stroke

Solder mount in 0,74 min. mounting hole

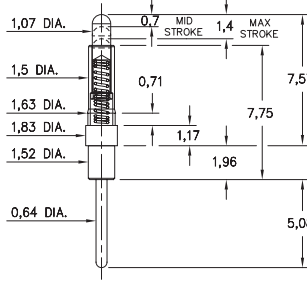

### 0956

0956-0-15-20-75-14-11-0

Standard stroke

Solder mount in 0,89 min. mounting hole

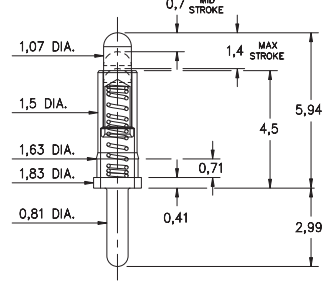

### 0933

0933-0-15-20-75-14-11-0

Standard stroke, Soldercup

Accepts wire sizes up to 24 AWG

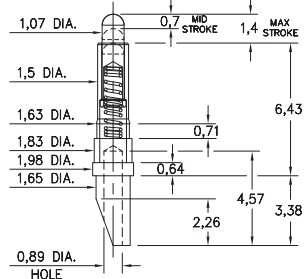

### 0973

0973-0-15-20-77-14-11-0

Long stroke, Soldercup

Accepts wire sizes up to 20 AWG

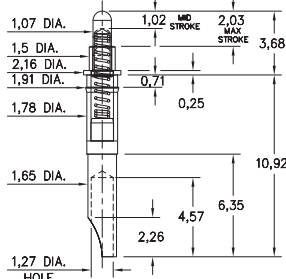

### 0962

0962-0-15-20-75-14-11-0

Standard stroke, Wire crimp termination

for wire sizes 24 AWG Max. / 28 AWG Min.

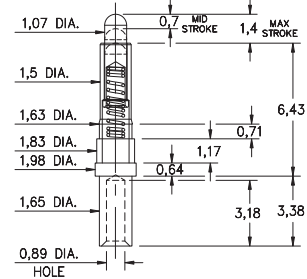

#### Material Specifications:

**Sleeve & Plunger Material:** Copper Alloy

**Spring Material:** Beryllium Copper

**Sleeve & Plunger Finish:** 0,5µm Gold over Nickel

**Spring Finish:** 0,25µm Gold over Nickel

**Dimensions:** Millimeters

**Tolerances On:** Lengths: ± 0,15

Diameters: ± 0,051

Angles: ± 2°



#### Mechanical & Electrical Specifications:

**Durability:** 1,000,000 cycles

**Current Rating:** 2A continuous, 3A peak

**Contact Resistance:** 20 mΩ max.

#### Environmental Specifications:

**Operating temperature range:** -55/+125°C

**71, 75, 77 Springs are not interchangeable**

Order Code: 09XX - X - 15 - 20 - 7X - 14 - 11 - 0

Spring Number

Spring Number	Mid. Stroke	Max. Stroke	Force @ Mid. Stroke	Initial Force (Pre-Load)
71	0,7	1,4	50 g	15 g
75	0,7	1,4	60 g	25 g
77	1,14	2,29	60 g	25 g

