

2198226
FINISHED ASSEMBLY
SCALE 4:1

- △ MATERIAL:
CAGE ASSEMBLY: 0.25mm THICK NICKEL SILVER ALLOY
GASKET RETENTION PLATE: STAINLESS STEEL
EMI GASKET: PLATED FILLED SILICONE
HEATSINK/LIGHTPIPE CLIP: STAINLESS STEEL
HEATSINK: ALUMINUM
LIGHTPIPE: POLYCARBONATE, CLEAR
- △ FINISH:
HEATSINK: ELECTROLESS NICKEL
HEATSINK/LIGHTPIPE CLIP: PASSIVATE
- △ DATUM AND BASIC DIMENSIONS ESTABLISHED BY CUSTOMER.
- △ PADS AND VIAS CHASSIS GROUND.
5. MATES WITH SFP MSA COMPLIANT RECIEVERS.
6. INTERPRETATION OF DATUM REFERENCE FRAME IN ACCORDANCE WITH SECT 4.4.1.1 OR ASME Y14.5M-1994.
- △ HOLE PATTERN REPEATS FOR EACH PORT, SPACING BETWEEN PORTS IS 14.25mm.
- △ REFERENCE APPLICATION SPEC. 114-13120, HOLE A, FOR RECOMMENDED DRILL HOLE DIAMETER AND PLATING THICKNESS.
- △ REFERENCE APPLICATION SPEC. 114-13120, HOLE B, FOR RECOMMENDED DRILL HOLE DIAMETER AND PLATING THICKNESS.

- △ MINIMUM PC BOARD THICKNESS:
SINGLE SIDED: 1.5mm
11. CERTAIN MATING TRANCEIVERS MAY REQUIRE ADDITIONAL PCB THICKNESS THAT WOULD NEED TO BE DETERMINED BY THE CUSTOMER.
12. PRODUCT COMPLIES WITH SPECIFICATION SFF-8433 IMPROVED PLUGGABLE FORM FACTOR FOR SFP+ GANGED CAGES.
- △ DIMENSION APPLIES PRIOR TO INSERTION OF SFP MODULE.
- △ HEATSINK, HEATSINK CLIP, AND LIGHTPIPE SHIPPED UNASSEMBLED TO CAGE ASSEMBLY. CAGE ASSEMBLY TO BE PRESSED INTO PCB PRIOR TO ATTACHING HEATSINK, HEATSINK CLIP, AND LIGHTPIPE TO THE CAGE ASSEMBLY.
- △ PACKAGED AS A COMPLETE ASSEMBLY.

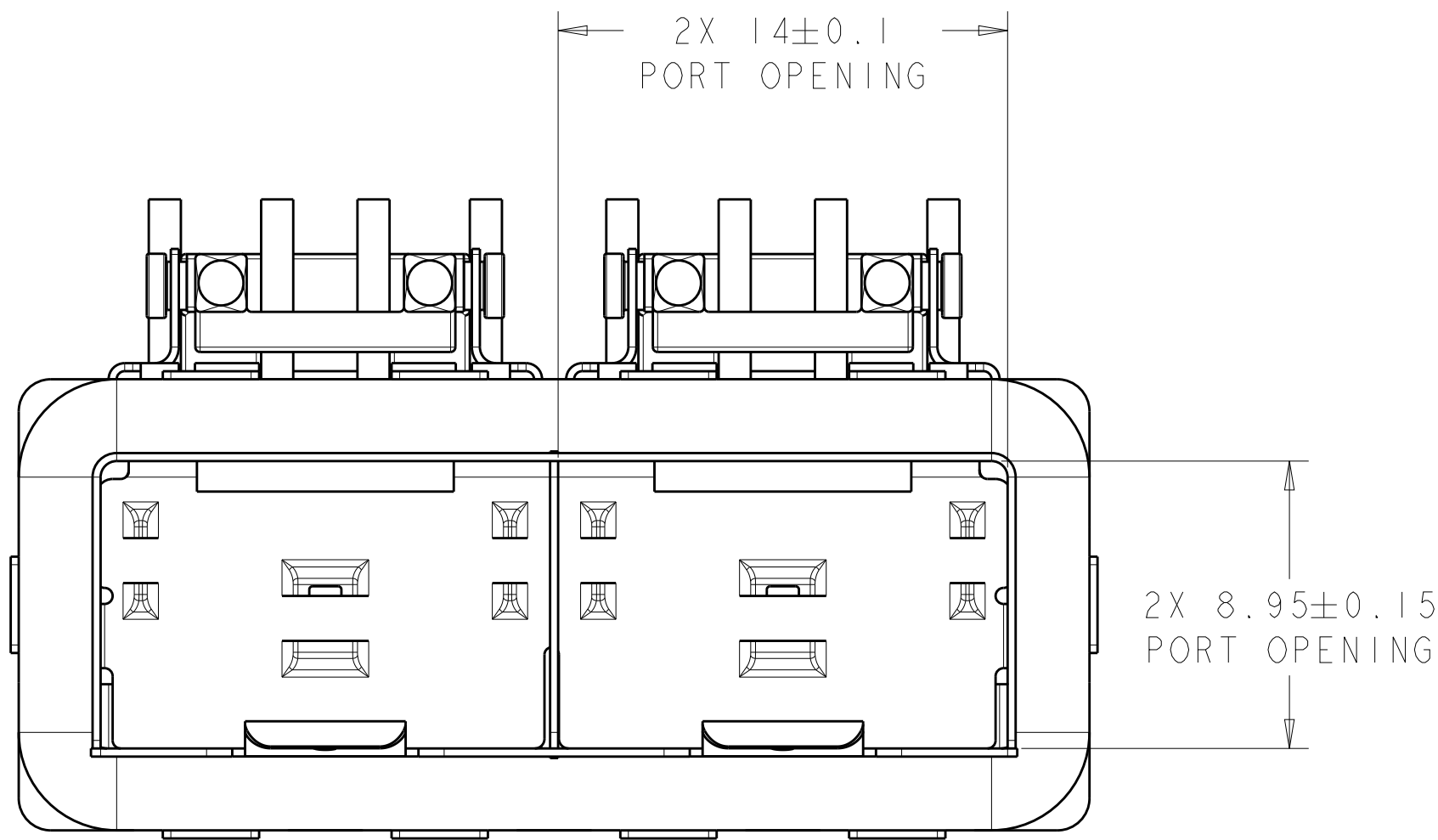
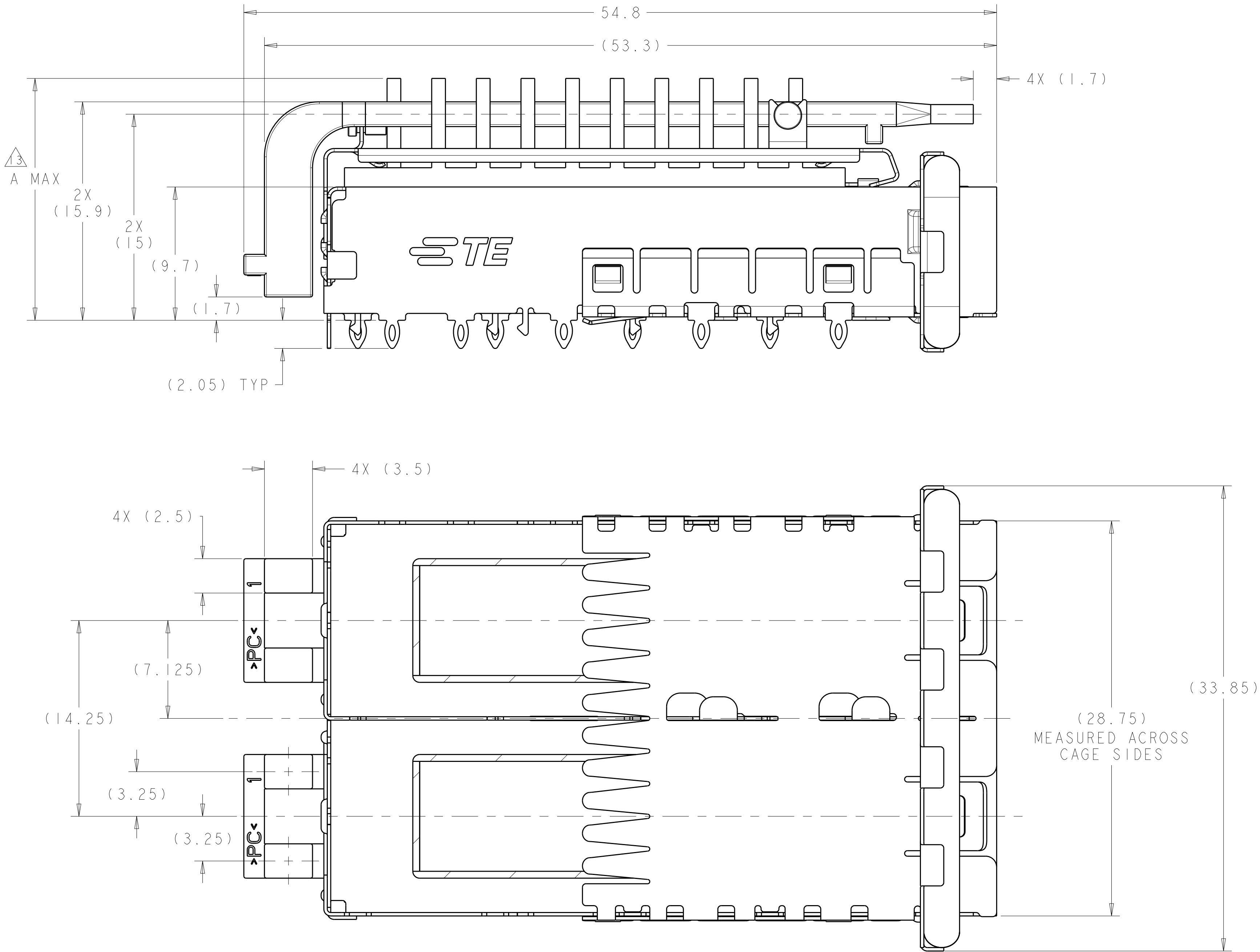

△ 3	22.5	NETWORKING, TALL	2198226-4
△ 3	18.1	NETWORKING, SHORT	2198226-3
△ 4	15.5	SAN	2198226-2
△ 4	13.2	PCI	2198226-1
	A MAX	APPLICATION	PART NUMBER

THIS DRAWING IS A CONTROLLED DOCUMENT.		DWN B MATTHEWS 14OCT2011	
DIMENSIONS:		CHK M SCHMITT 14OCT2011	
mm		APVD W SCHMITT 14OCT2011	
TOLERANCES UNLESS OTHERWISE SPECIFIED:		NAME	
0 PLC ±0.13		PRODUCT SPEC	
1 PLC ±0.1		108-2364	
2 PLC ±0.08		APPLICATION SPEC	
3 PLC ±0.05		114-13120	
4 PLC ±0.05		WEIGHT	
ANGLES ±1		CUSTOMER DRAWING	
FINISH		SCALE 5:1	
△ 2		SHEET 1 OF 3	
		REV A	

SIZE	CAGE CODE	DRAWING NO	RESTRICTED TO
A1	00779	C=2198226	-

TE Connectivity

PRELIMINARY

SFP+ ENHANCED 1X2 CAGE ASSEMBLY, PRESS-FIT, EMI GASKET WITH HEATSINK AND LIGHTPIPE

LOC		DIST		REVISIONS				
GP	00	P	LTR	DESCRIPTION	DATE	DWN	APVD	
		-		SEE SHEET 1	-	-	-	

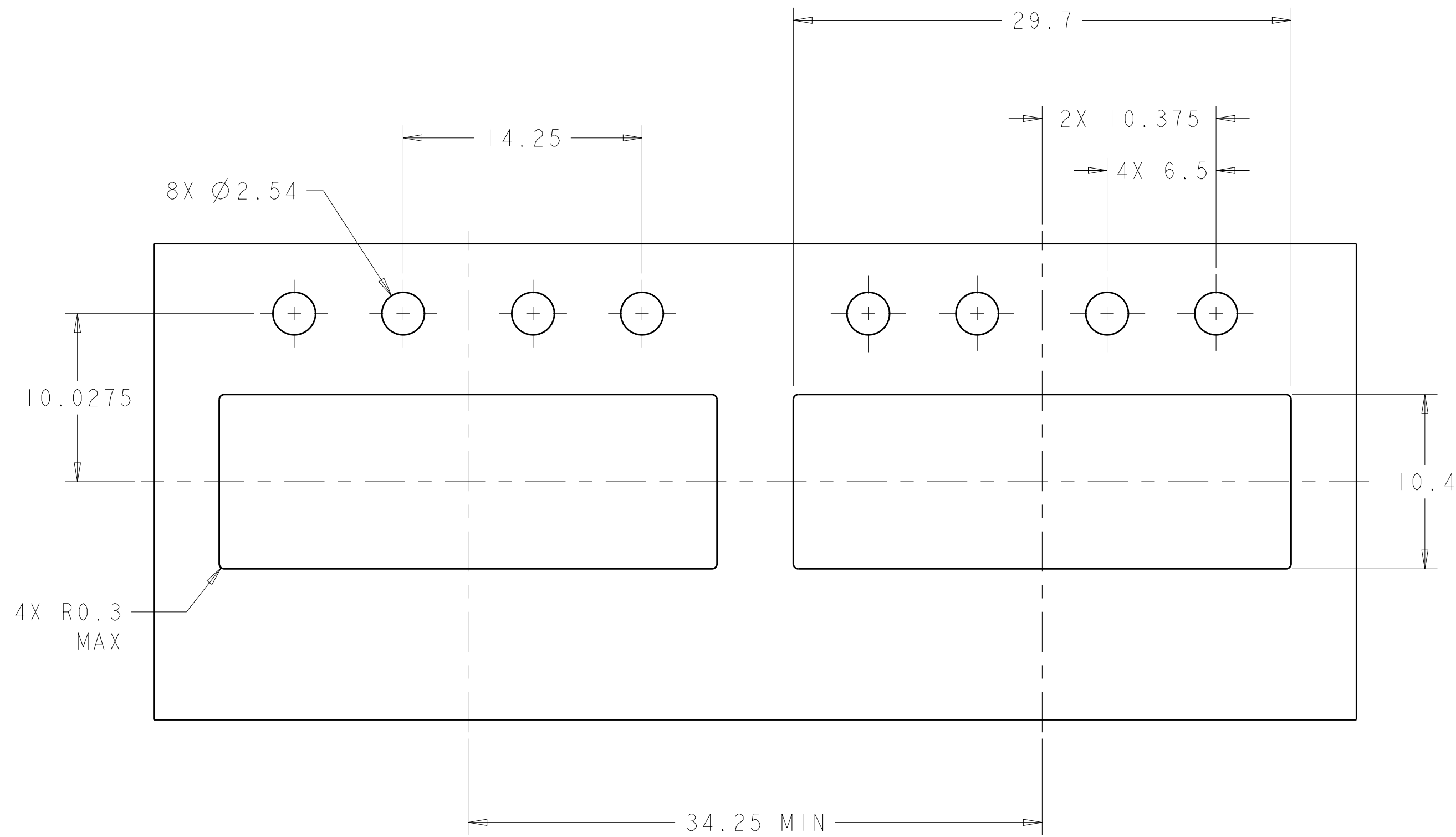

RECOMMENDED BEZEL CUTOUT
SCALE 4:1

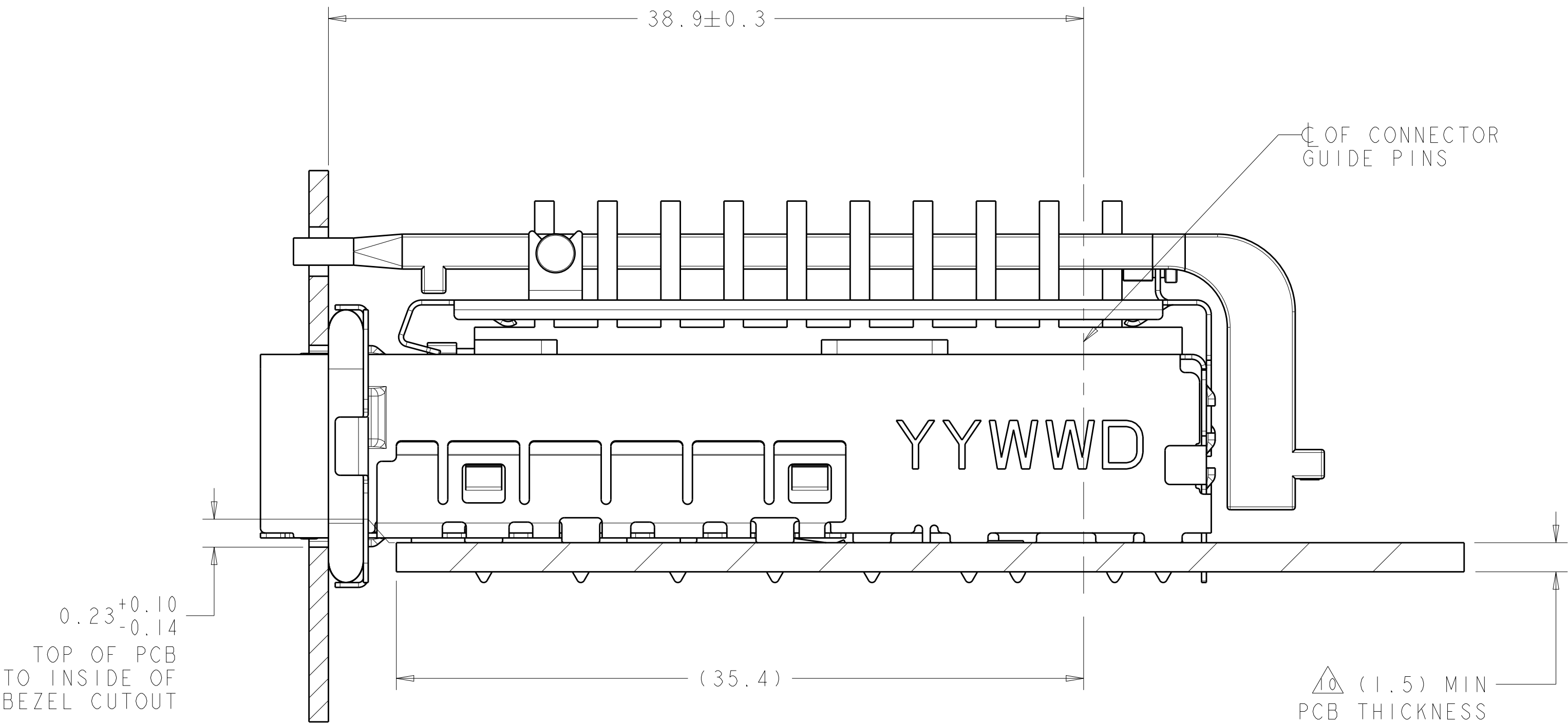

2198226
MOUNTED ON PC BOARD
SHOWN THRU RECOMMENDED BEZEL

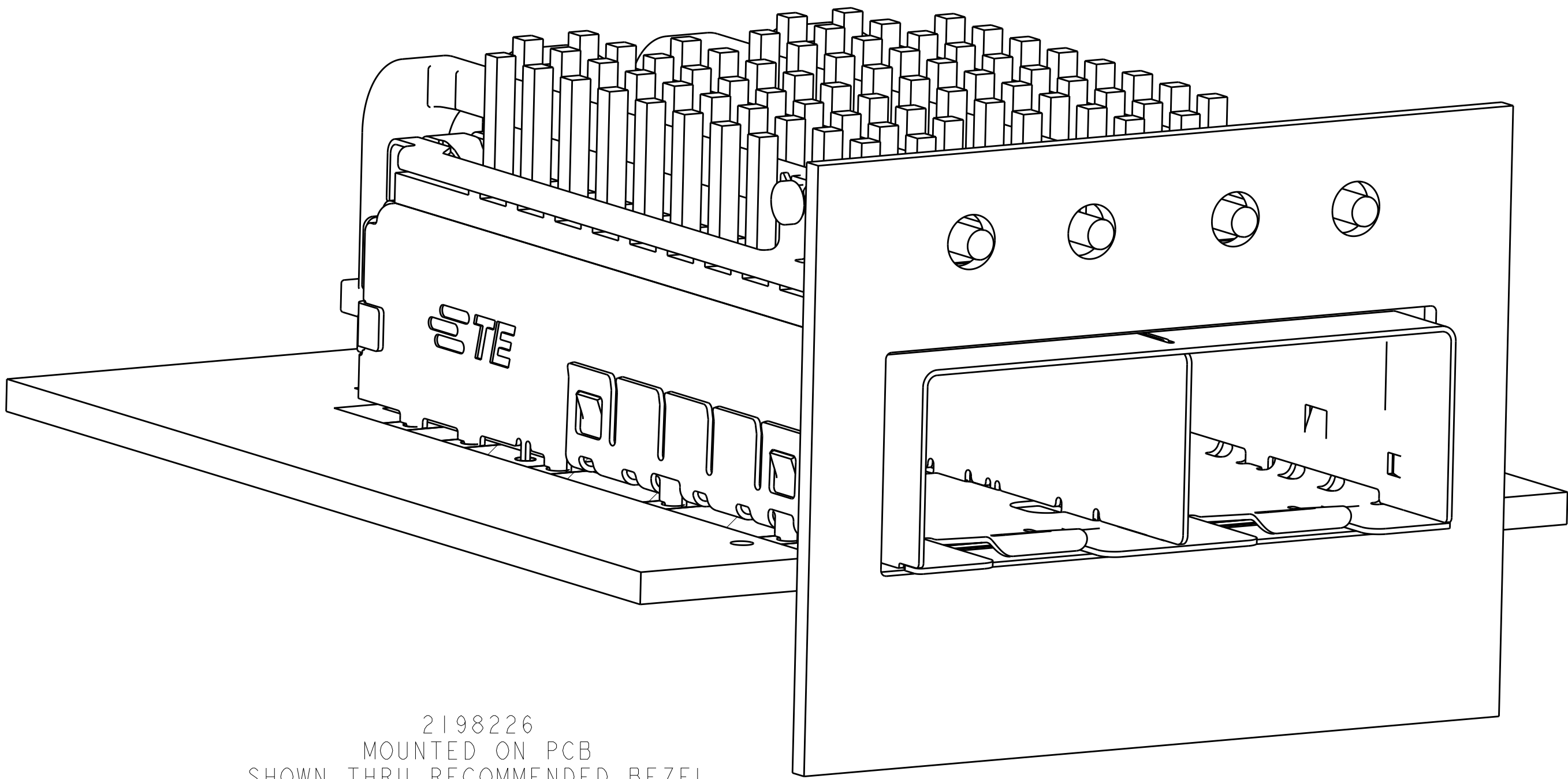

2198226
MOUNTED ON PCB
SHOWN THRU RECOMMENDED BEZEL

THIS DRAWING IS A CONTROLLED DOCUMENT.		DWN B. MATTHEWS CHK M. SCHMITT APVD M. SCHMITT	14OCT2011 14OCT2011 14OCT2011	TE Connectivity	
DIMENSIONS:		TOLERANCES UNLESS OTHERWISE SPECIFIED:		NAME	
mm		0 PLC ±0.13 1 PLC ±0.1 2 PLC ±0.08 3 PLC ±0.05 4 PLC ±0.05		SFP+ ENHANCED 1X2 CAGE ASSEMBLY, PRESS-FIT, EMI GASKET WITH HEATSINK AND LIGHTPIPE	
MATERIAL		FINISH		RESTRICTED TO	
				A100779C=2198226	
				SCALE 5:1 SHEET 2 OF 3 REV A	

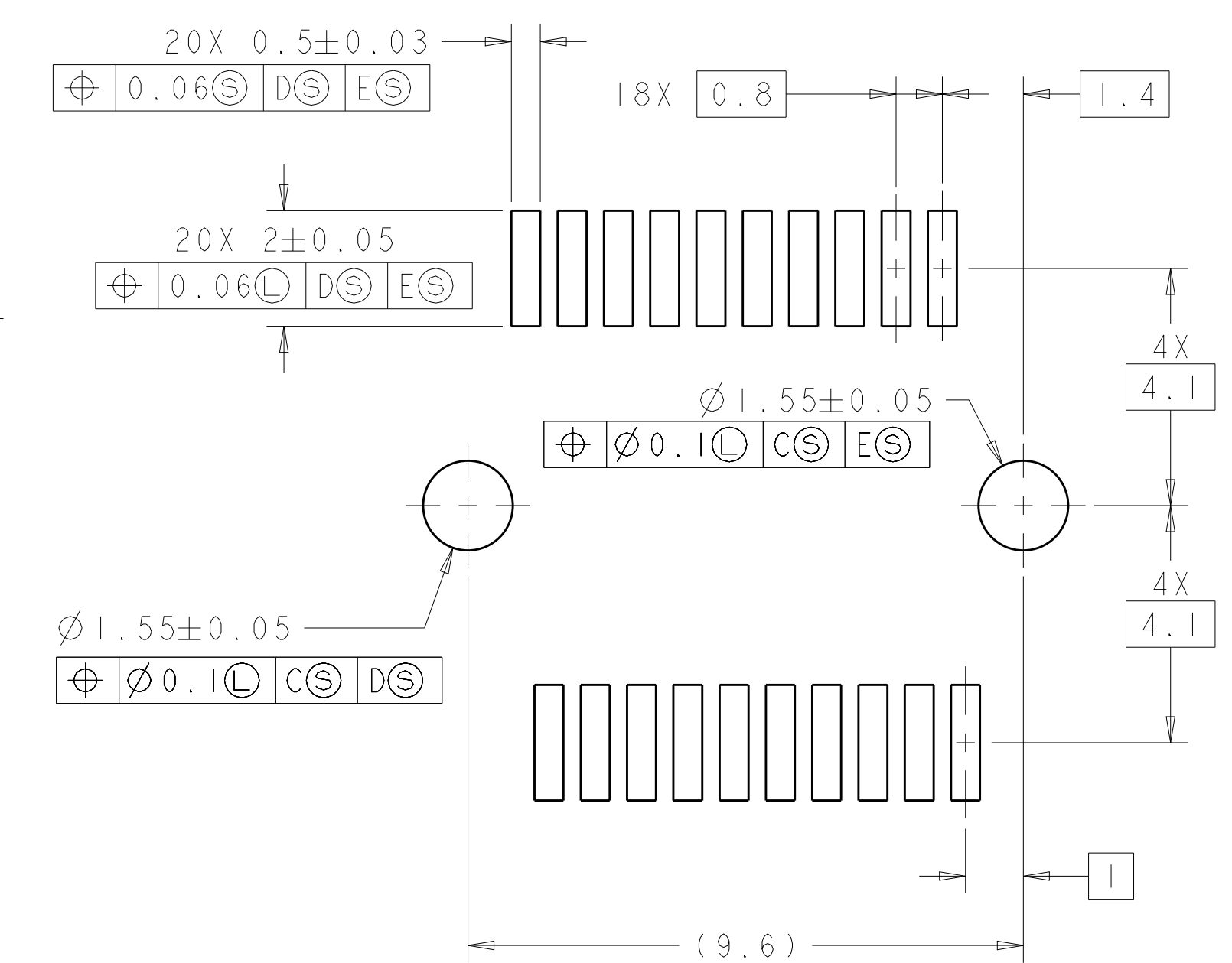

DETAIL G
SCALE 10:1

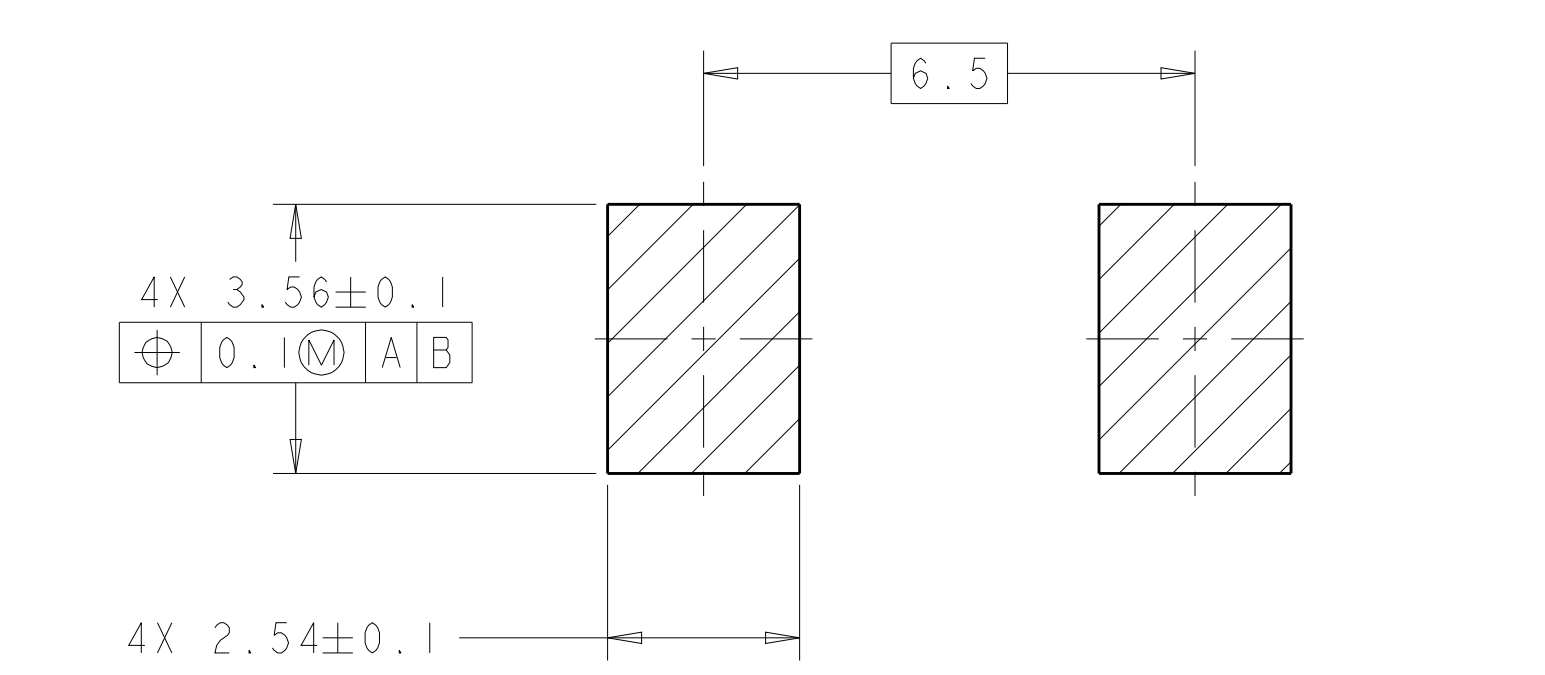

DETAIL E
SCALE 10:

—CROSS-HATCHED AREA DENOTES
COMPONENT AND TRACE KEEP-OUT
(EXCEPT CHASSIS GROUND)

4805 (3/11)