

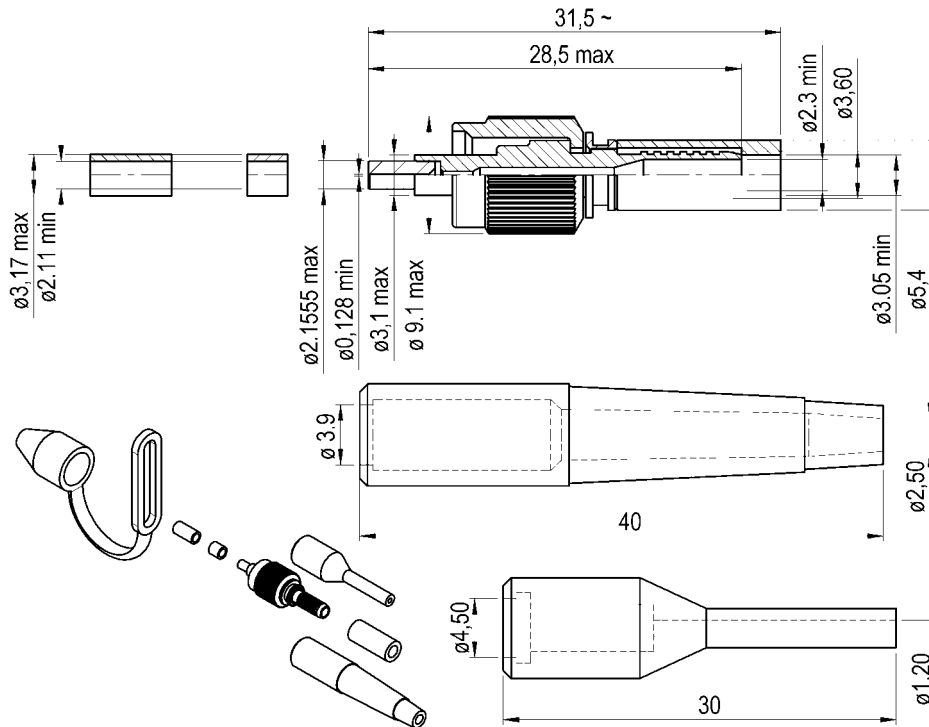

Dimensions : mm



**GENERAL**

- TYPE :** Type F-SMA connector with ceramic ferrule, screw thread coupling device
- FIBER :** 50/125 µm or 62.5/125 µm multimode fiber.
- CABLES :**
- Tight structure cable with aramid members from 2.4mm Dia through 3.0mm Dia
  - Coated fiber, max outer Dia : 1.0 mm
- INSTALLATION :** See assembly procedures 503 08 530

**CHARACTERISTICS (Depending on fibre or cable construction)**

- OPTICAL :** Typical insertion loss ( $\lambda=850\text{nm}$ ): 0.7 dB  
Standard deviation: 0.3 dB (CEI 874-1, 4.4.7 method 7)
- MECHANICAL :** Mating life : 500 Cycles  
Fiber retention : 10 maxi  
Cable retention : 100N maxi  
Vibrations : 10 – 55 Hz, 10g
- CLIMATICAL :** Temperature category: 20/75/4

<b>CREATION</b>				<b>RADIALL®</b> 101, rue P. Hoffmann 93116 ROSNY/BOIS FRANCE Tel : (33) 0149353535 Fax : (33) 0148546363
N°: PEN				
PEN/EP :				
Name:				
Date: 20.09.1989	6/04/03	English version + Redraw CAD	G.M.	
Appr.: G.M	Issue	Revisions	Name Appr.	