

REV.	DATE	DESCRIPTION
NC	04/04/03	INITIAL RELEASE

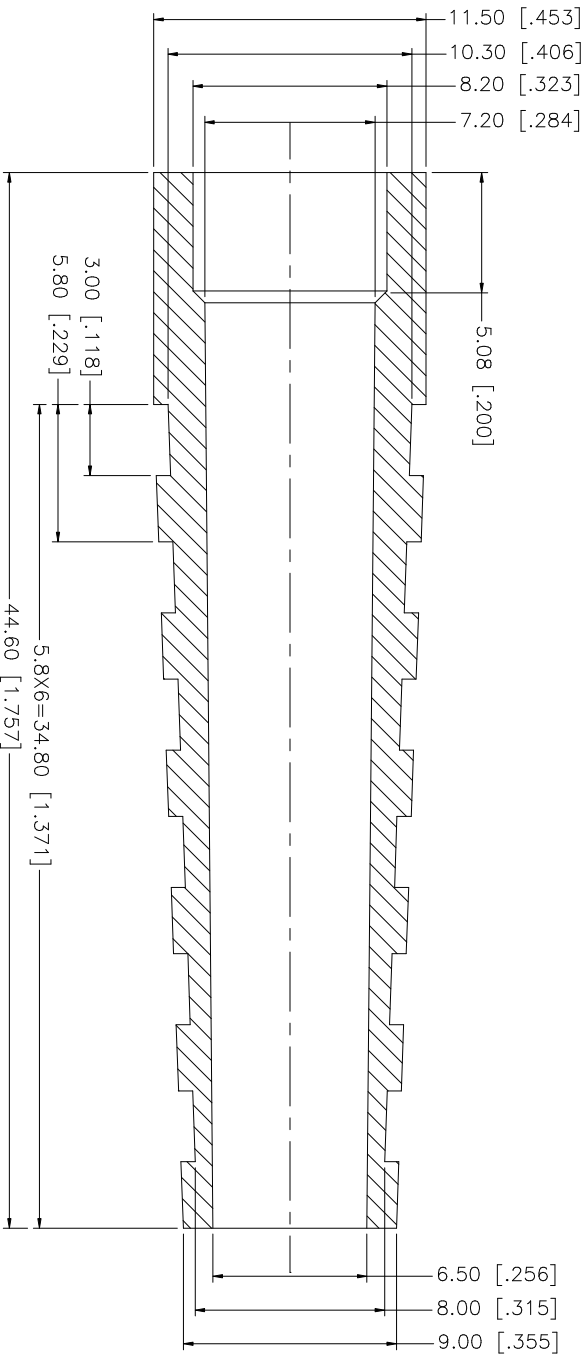

8																				
7																				
6																				
5																				
4																				
3																				
2																				
1	STRAIN RELIEF	PVC																		
	DESCRIPTION	MATERIAL	FINISH	QTY																
UNLESS OTHERWISE SPECIFIED DIMENSIONS ARE IN MILLIMETERS DIMENSIONS IN [ ] ARE IN INCHES AND FOR CUSTOMER REFERENCE ONLY.											UNLESS OTHERWISE SPECIFIED DIMENSIONS ARE IN MILLIMETERS DIMENSIONS IN [ ] ARE IN INCHES AND FOR CUSTOMER REFERENCE ONLY.									
TOLERANCES FOR ALL DIMENSIONS ARE:											TOLERANCES FOR ALL DIMENSIONS ARE:									
0.5 - 8mm ± 0.20mm											0.5 - 8mm ± 0.20mm									
8 - 30mm ± 0.40mm											8 - 30mm ± 0.40mm									
30 - 120mm ± 0.50mm											30 - 120mm ± 0.50mm									
UNLESS OTHERWISE SPECIFIED TOLERANCES ARE:											UNLESS OTHERWISE SPECIFIED TOLERANCES ARE:									
.020 - .315 = ± 0.007"											.020 - .315 = ± 0.007"									
.315 - 1.180 = ± 0.015"											.315 - 1.180 = ± 0.015"									
1.180 - 4.724 = ± 0.020"											1.180 - 4.724 = ± 0.020"									
DO NOT SCALE DRAWING											DO NOT SCALE DRAWING									
APPROVALS					DATE															
DRAWN G.R.S.					04/04/03															
CHECKED																				
ISSUED																				
SHEET 1 OF 1																				
CAD FILE C:/MISC/60030-000.DWG																				
DWG. NO. 60030-000.DWG																				
REV. NC																				
SIZE A																				
SCALE NA																				
PART DESCRIPTION																				
STRAIN RELIEF BOOT																				
PART NO. 60030-000																				
Amphenol Connex																				