

# PART NUMBER: 174HC1700K2CM6

Conduction Cooled (High Density Resonant)  
Parts are RoHS compliant

## ELECTRICAL SPECIFICATIONS

**Capacitance:** 0.17  $\mu$ F  
**AC Current:** 250 A  
**ESR:** 1.2 milliOhms at 100 kHz and 20°C  
**Self Inductance:** 3 Nanohenries maximum

**Tolerance:** -10 % , +10 %  
**Temperature Range:** -40°C to +85°C  
**Maximum Core Temperature:** 85°C  
**Resonant Frequency:** 286-389 kHz  
**Maximum power (KVAR):** 150  
**VAC:** 700 Volts AC

## PHYSICAL DIMENSIONS

**Length (L):** 68 mm, 0.5 mm  
**Height (H):** 30 mm, +/-0.5 mm  
**Thickness (B):** 30.2 mm, +/-0.1 mm

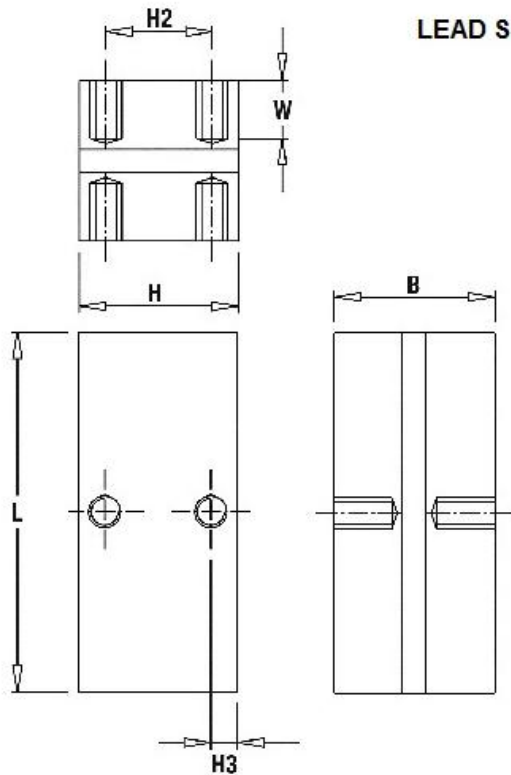

L	H	B	W	H2	H3
68 $\pm$ 0.5	30 $\pm$ 0.5	30.2 $\pm$ 0.1	10	20	5
Mounting holes: M6x1 tap filled with SS helicoil					
Tightening torque: 15Nm MAX					