

# Ring Lock DC Power Jacks

163-7421, 163-7425

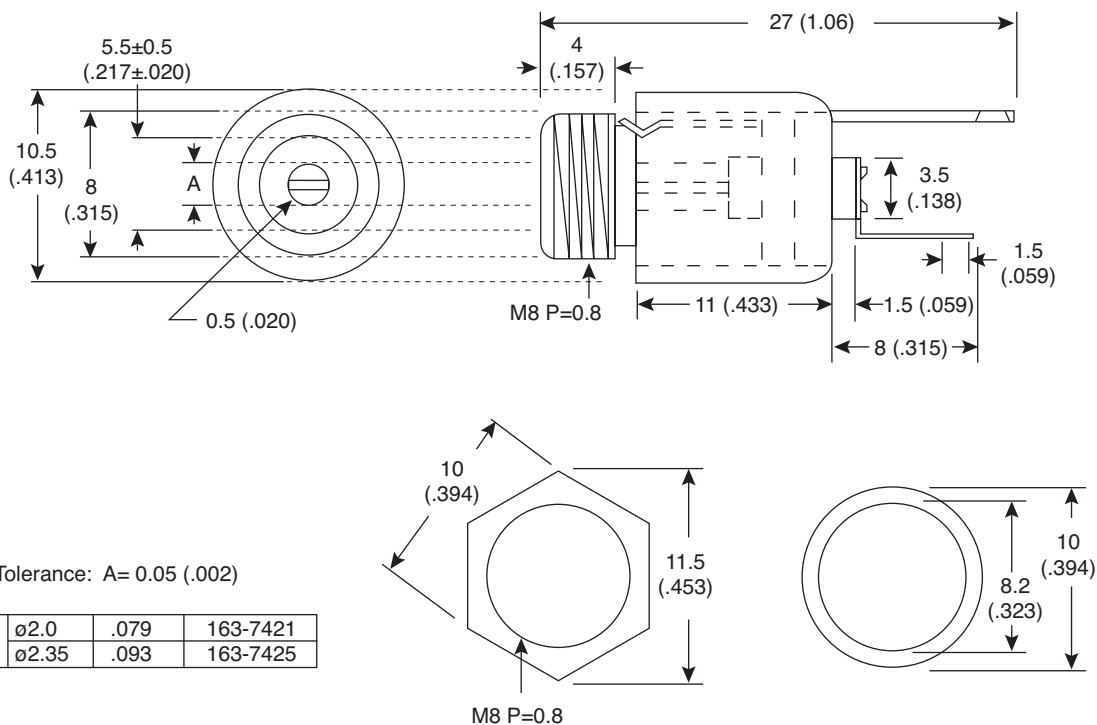

Ring Lock DC Power Jacks



**DIMENSIONS: mm (In.)**

SPECIFICATIONS	
<b>Contact pin:</b>	nickel plated brass
<b>Contacts:</b>	nickel phosphor bronze
<b>Washer:</b>	nickel plated steel
<b>Nut:</b>	nickel plated brass
<b>Body:</b>	nickel plated brass
<b>Insulation:</b>	delrin
<b>Electrical:</b>	3.15-13.5V DC, 2A
<b>Maximum Panel Thickness:</b>	1-3mm

Date Last Revised: 4-26-06

Available from Mouser Electronics  
1-800-346-6873  
www.mouser.com

KC-300389

163-7421, 163-7425