

**TORQUE WRENCH****R282.320.020****8MM - 200NCM**Series : **OUT**

Scale : 1/1

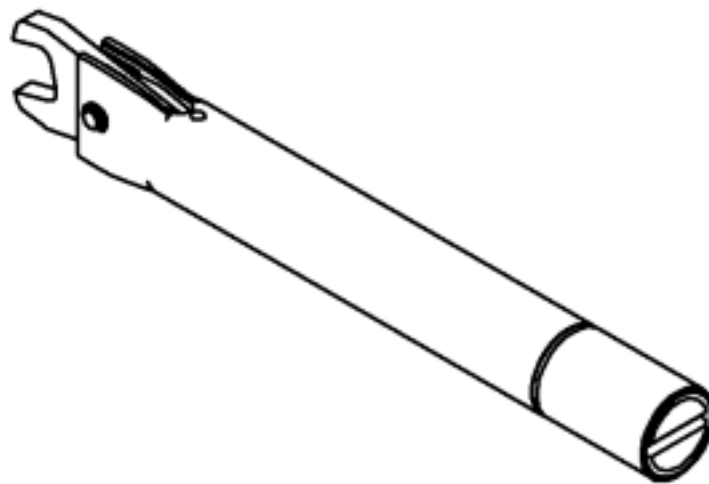
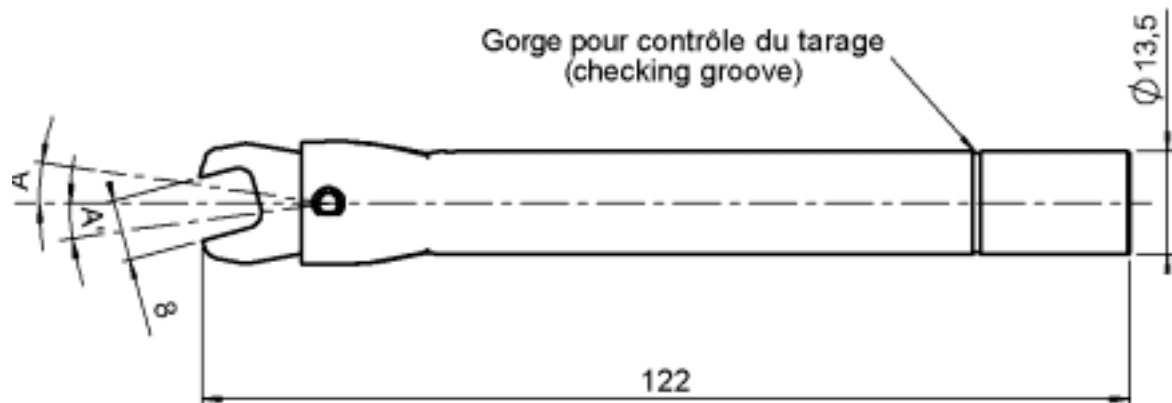

PRECEDENT CROSS REFERENCE : 731.80.010 (N° 103)  
 (CAN BE USED FOR TNC 18 SERIE)

**OPERATION**

The torque wrench is designed to automatically make a « click sound ».

The wrench will work the same in both directions.

Be careful : **DO NOT APPLY PRESSURE** to the wrench **AFTER** hearing the click sound, it will possibly damage the connector.

**ENSURE PROPER TORQUE**

Apply verification force at the groove level on the handle.

- Coupling torque 200 Ncm +/-10 Ncm
- A A' angular sweep approximately 8°



Edition : 0224 A

Design changes may be in order to improve the product.