

55310 Flat Pack Digital Hall Sensor



Features:

- Magnetically operated position sensor
- Unipolar digital hall switch
- 3 wire with open-drain output
- EMC protection
- Reverse/over voltage protection

Benefits:

- High switching speed up to 10kHz
- Long life; up to 20 billion operations
- Unaffected by harsh environments
- Custom connector, wire length options available. Consult Hamlin.
- Standard actuators available. Consult Hamlin.

Applications:

- Position sensing
- Limit sensing
- Speed measurement
- Magnetic encoders

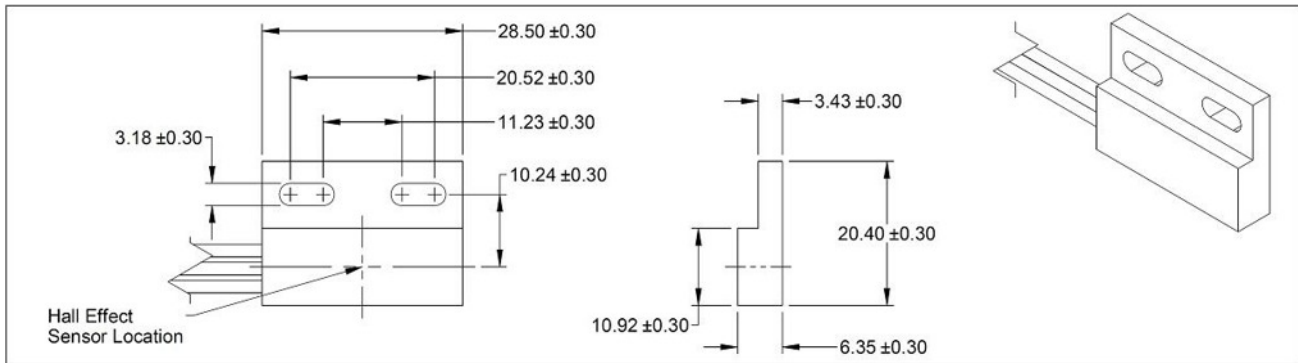

DIMENSIONS mm



SPECIFICATIONS

Hall Effect Device		Unipolar Digital Switch	
Operating Voltage	Recommended	Vdc	4.75 to 24.0
Over Voltage	Absolute Max	Vdc	30
Reverse Voltage	Absolute Max	Vdc	-20
Supply Current		mA-Max	6
Output Current		mA-Max	20
Sensor Actuation w/Magnetic South Pole	Operate (output low)	Gauss - Typical	55
	Release (output high)	Gauss - Typical	35
Switching Speed		kHz Max	10
Temperature	Operating	°C	-40 to +105
	Storage	°C	-65 to +105
Wire	Size	AWG	20
	Insulation	SAE	J-1128, Type TXL
	Length	mm	300

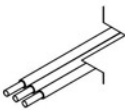
ORDERING INFORMATION

Termination Options			
Select Option	Description	Select Option	Description
A	Stripped Leads 	C	Molex Connector MX 150 33481-0301 
	Color Function Black Ground White Signal Red V(in)		Pin Color Function 1 Black Ground 2 White Signal 3 Red V(in)

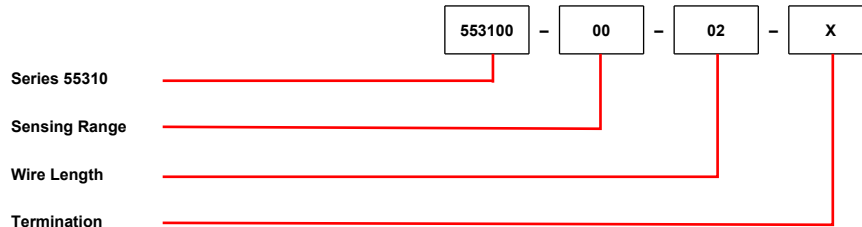

Hamlin USA Tel: +1 920 648 3000 • Fax: 1 920 648 3001 • Email: sales.us@hamlin.com
Hamlin UK Tel: +44 (0) 1603 257700 • Fax: +44 (0) 1603 257702 • Email: sales.uk@hamlin.com
Hamlin GmbH Tel: +49 (0) 6142 923920 • Fax: +49 (0) 6142 923921 • Email: sales.de@hamlin.com
Hamlin China Tel: +86 (0) 512 69365 800 • Fax: +86 (0) 512 69365 811 • Email: sales.cn@hamlin.com

INFORMATION PROVIDED ON THIS DATA SHEET IS PROVIDED FOR INFORMATION PURPOSES ONLY AND SHOULD NOT BE RELIED UPON AS BEING ACCURATE FOR ANY PARTICULAR PURPOSE. Product performance may be affected by the application to which the product is applied. Upon request, HAMLIN will assist purchasers by providing information specific to any particular application. HAMLIN disclaims any and all liability whatsoever for any purchaser's reliance upon the information contained on this data sheet without further consultation with authorised representatives of HAMLIN.