

This document is the property of Amphenol Corporation and is delivered on the express condition that it is not to be disclosed, reproduced or used, in whole or in part, for manufacture or sale by anyone other than Amphenol Corporation without its prior consent, & that no right is granted to disclose or to use any information in this document.

REVISIONS				
SYM	ECN	DESCRIPTION	DATE	APPROVED
1			03/27/09	

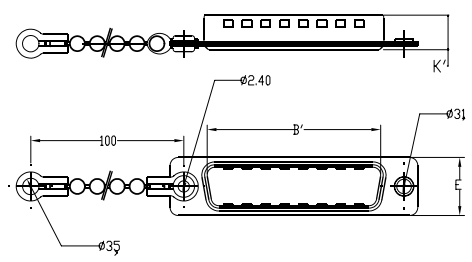

Flat MALE dust cover with Chain, for use with FEMALE connector

Part number

- 09 contacts or shell size E =L17D4K630 09
- 15 contacts or shell size A =L17D4K630 15
- 25 contacts or shell size B =L17D4K630 25
- 37 contacts or shell size C =L17D4K630 37
- 50 contacts or shell size D =L17D4K630 50

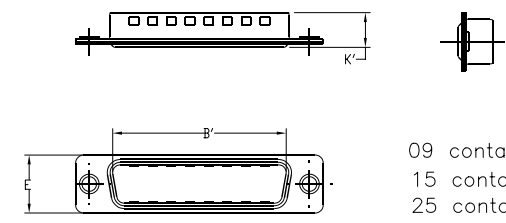

Flat MALE dust cover without Chain, for use with FEMALE connector

Part number

- 09 contacts or shell size E =L17D4K630 10
- 15 contacts or shell size A =L17D4K630 16
- 25 contacts or shell size B =L17D4K630 26
- 37 contacts or shell size C =L17D4K630 38
- 50 contacts or shell size D =L17D4K630 51

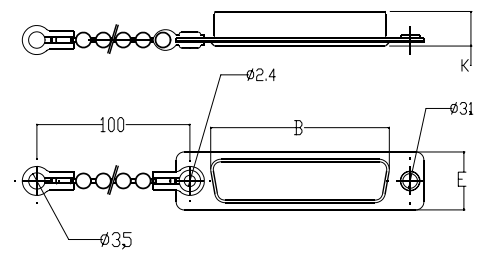
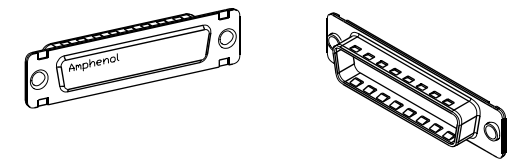
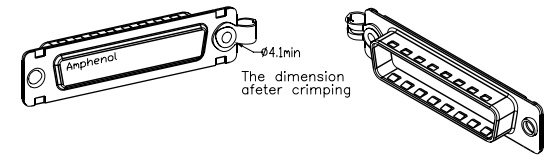

Flat FEMALE dust cover with Chain, for use with MALE connector

Part number

- 09 contacts or shell size E =L17D4K631 09
- 15 contacts or shell size A =L17D4K631 15
- 25 contacts or shell size B =L17D4K631 25
- 37 contacts or shell size C =L17D4K631 37
- 50 contacts or shell size D =L17D4K631 50

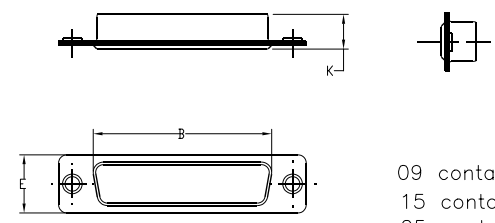

Flat FEMALE dust cover without Chain, for use with MALE connector

Part number

- 09 contacts or shell size E =L17D4K631 10
- 15 contacts or shell size A =L17D4K631 16
- 25 contacts or shell size B =L17D4K631 26
- 37 contacts or shell size C =L17D4K631 38
- 50 contacts or shell size D =L17D4K631 51

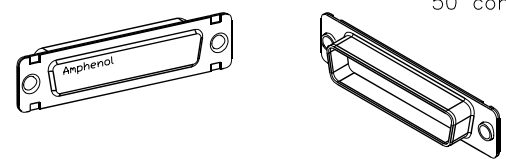
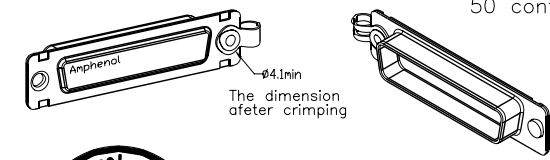

Shell = steel with tin plating

# Customer drawing

Size	B'	B	K'	K	E
E	16,8	16,4	7,6	7,9	12,4
A	25,1	24,8	7,6	7,9	12,4
B	38,8	38,5	7,6	7,9	12,4
C	55,3	54,9	7,6	7,9	12,4
D	52,7	52,5	7,6	7,9	15,2

UNLESS OTHERWISE SPECIFIED <b>TOLERANCES</b> U.S. METRIC .X +/- 0.50 .XX +/- 0.30 .XXX +/- 0.20 FRACTIONS +/- ANGLES +/- 5° FOR MATERIALS AND FINISHES SEE NOTES REMOVE SHARP EDGES DIMENSIONS U.S. INCHES METRIC MM	<b>APPROVAL DATE</b> DRAWN Lik Wang 02/04/07 CHECKED Stefan 02/04/07 CHECKED		TITLE <h2>Amphenol</h2> Accessory, Dust Cover
	DRAWING FILE : ANGLE OF PROJECTION 		
SIZE DRAWING NO. <b>A4 C L17D4K63XXX</b>	REV. <b>1</b>		SCALE NONE SHEET 1 OF 1