

## Intelligent Limit Switches and Connection Box

### ASI Bi2

The AS interface version of the ASI Bi2 switch is designed as a very compact unit with a low overall height and side connection.



**M12-connection**

**607.3201.052**  
ASI Bi2 w

-
-

**Direct connection**

**607.3201.051**  
ASI Bi2 w D

-
-

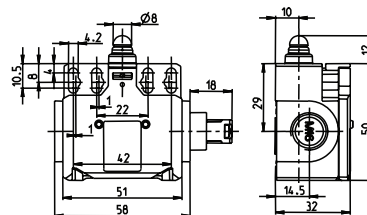

### ASI ENK

The ASI ENK conforming to EN 50041 is an extremely sturdy standard switch used in a wide range of applications. The enclosure and cover are made from fiber glass-reinforced thermoplastic. LEDs that indicate the status of the ASI slave and bus are integrated in the cover. Protection class IP65 in accordance with EN 60529, DIN VDE 0470 T1 is guaranteed.



**M12-connection**

**607.3501.023**  
ASI ENK iw

-
-

**Direct connection**

**607.3501.036**  
ASI ENK IW D

-
-

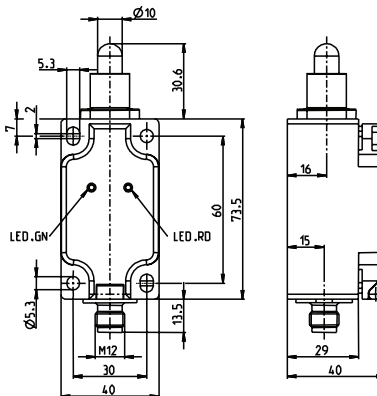

### ASI ANS

The standard connection box has an ASI address and integrates up to four non-safety sensors in the ASI system. The connection box is equipped with LEDs that indicate the status of the connected user.

**Connection box 6073201**

**607.3100.027**  
ASI CONNECTION BOX 4 IN

-
-

**Direct connection**

-  
-

-
-



Drawing dimensions in mm